

FUELED BY PRECISION
FUELED BY PRECISION
FUELED BY PRECISION
FUELED BY PRECISION
FUELED BY PRECISION
FUELED BY PRECISION
FUELED BY PRECISION
FUELED BY PRECISION
FUELED BY PRECISION
FUELED BY PRECISION

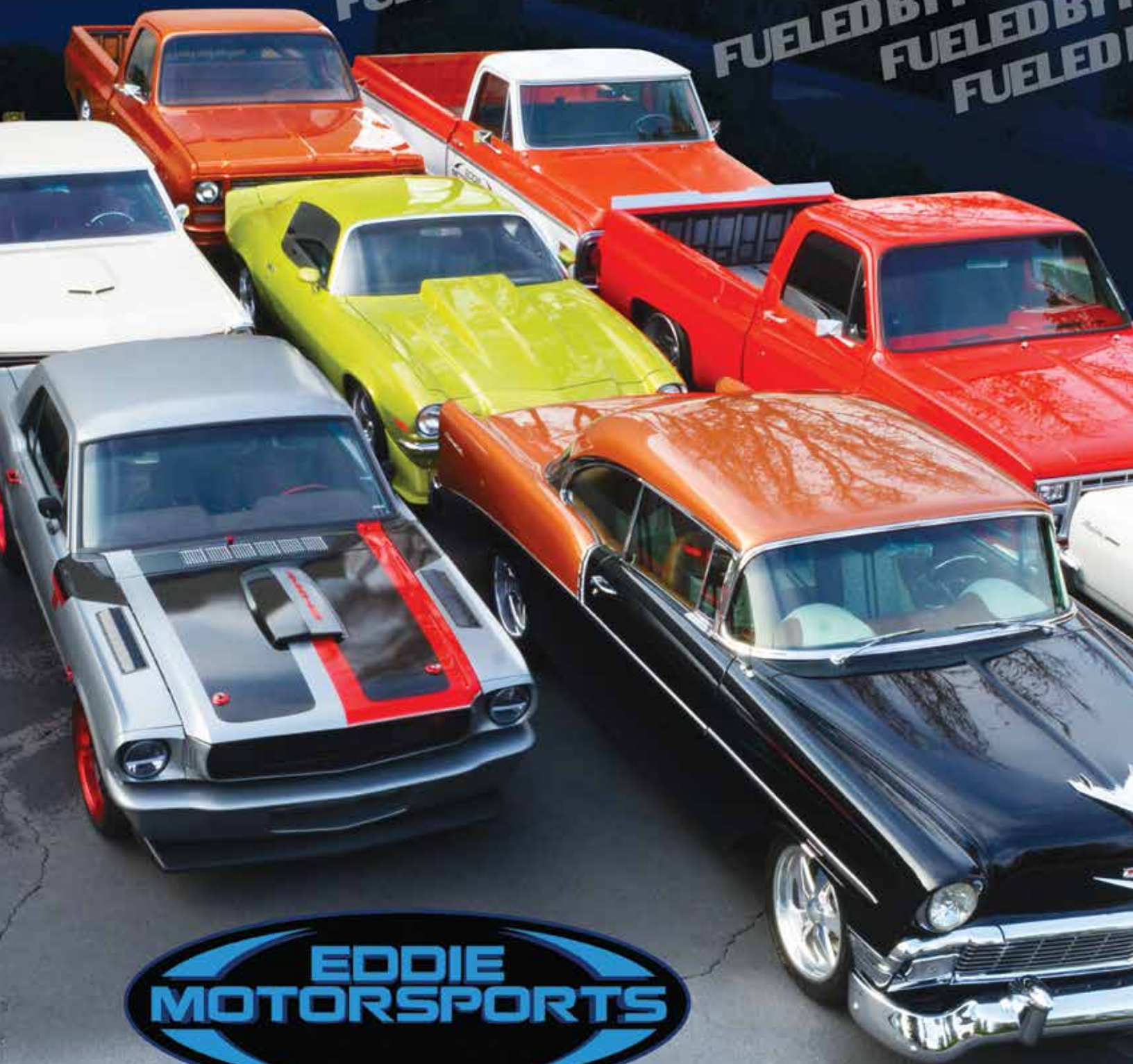

**EDDIE
MOTORSPORTS**

**CATALOG
TWELVE**



Kinetic Hood Hinges
See pages 31-44



Kinetic & Sport Steering Wheels
See page 71-78



G-Body Hood Hinges
See page 44



64-66 Mustang Exterior Door Handles
See page 67



3rd Gen Camaro Hood Hinges
See page 33

SLIM LINE
SERIES

64-66 Mustang Fuel Panel
See page 68

65-66 Mustang Billet Tail light Bezels
See page 68





S-Drive Pulley Finishes
See pages 7-22

CERAKOTE®

Cerakote finish

Now you can have your Eddie Motorsports part in a Cerakote bronze finish. Pg.16



S-Drive Pro Touring Series
See page 14



S-Drive LSA/LS9 Series
See page 15

HALO



Halo Seats
See page 28-29



Eddie Motorsports Apparel
See page 105

EDDIE MOTORSPORTS

TERMS & CONDITIONS

Dealer Requirements

Our policy is to consider a discount to any valid automotive aftermarket company including jobbers, repair shops, engine builders, and car builders. In an effort to support our dealers and protect the integrity of our distribution channels, we require that you provide us with verifiable proof that your company is actively and gainfully involved in the automotive aftermarket as part of your everyday business operation. Please supply ALL of the following information, via fax, mail or email, to avoid any complication in the approval process. Only companies with a published physical address will be considered for dealer status.

A completed, signed and dated Eddie Motorsports dealer application
(download at <http://www.eddiemotorsports.com/dealer>)

A copy of your company letterhead and business card

A copy of your current sales tax certificate (where applicable) or business license.

A completed and signed resale card (California only)

*We reserve the right to request further information before establishing a wholesale account

Payment Terms

Payment may be made by the following: Visa, Mastercard, Discover, American Express, or PayPal.

Refused Shipments

Shipments returned to Eddie Motorsports marked refused or not received in three attempts will cause the customer's buying status to be placed on hold until all shipping charges have been paid.

Shortages / Damages

Shortage or damage claims must be reported to Eddie Motorsports within 48 hours of receipt of shipments for any adjustments to be considered or reports to shipping companies to be made. Packaging materials must be kept, and photographs supplied so that we can contact the shipping company on your behalf.

Drop Shipments

Drop shipments for wholesale customers will be performed as needed. A \$15 drop fee will be charged.

Returns

All returns must be accompanied by a pre-authorized Return Number from Eddie Motorsports and must be returned to us with freight pre-paid. Returned parts may be subject to a 15% restocking charge. Freight is non-refundable. No returns will be accepted after 60 days from date of purchase.

No refunds or exchanges will be given for electrical parts or custom parts such as cut hose, custom colors, etc.

Freight

All orders will be shipped by standard ground Fed Ex or USPS Priority unless otherwise specified by the customer. All orders will be shipped F.O.B. Rancho Cucamonga, CA.

Prices

All prices are subject to change without written or verbal notice. If a product has a significant change in price we will do our best to notify our customers. Visit our website, www.eddiemotorsports.com for up to date prices.

Warranty

All products manufactured by Eddie Motorsports carry a one year limited warranty against defects in material and workmanship. Eddie Motorsports will repair or replace defective products as we deem necessary. Due to the wide variety of products we distribute, warranties may vary by manufacturer. Call for details on other manufacturer's warranties.



California Residents - Prop 65

Prop 65 requires businesses that manufacture and/or sell products in the State of California to inform consumers which items contain chemicals known to cause cancer and/or reproductive harm.

● Actuators & Accessories.....27	● Fittings.....26	● Mustang Billet parts.....67-69
● Adjusting Rods.....24	● Fuel Fill Bezels.....85	● Oil Fill Bung & Cap.....99
● Air Cleaner Nuts.....92	● Fuel Fills.....85	● Pedal Covers.....79
● Air Cleaners.....90-91	● Fuel Filters.....93	● Power Steering Hardline.....23
● Air Conditioning Compressor	● Fuel Panel, Mustang.....68	● Power Steering Kits-LT1.....22
Manifold.....29	● Fuel Tank Vents.....93	● Power Steering Line Kits.....24
● Air Conditioning Compressor.....29	● Gas Caps, Camaro.....51	● Power Steering Pumps.....25
● Air Conditioning Kits-LT1.....22	● Gas Fill Bezels.....85	● Power Steering Reservoirs.....23
● Air Vents.....59	● Gas Fills.....85	● Pulley Kits.....6-20
● Aluminum Washers.....100-101	● Gas Struts.....45	● Radiator Overflow Tank.....26
● Battery Boxes, 55-57 Chevy.....48	● Gas Tank Vents.....93	● Radio Panels, Nova.....67
● Battery Boxes, Universal.....86-87	● Garage Wall Art.....106	● Relay Box.....27
● Battery Disconnect Switch.....88	● Gauge Panels, Mustang.....69	● Serpentine Pulley Kits.....6-20
● Battery Disconnect Switch Panel.....88	● Gauges.....70	● Shifter Boots & Bezels.....81
● Battery Frame Mount.....88	● Glove Box Insert, Nova.....69	● Shifter Knobs.....80
● Battery Jumper Box.....88	● Grilles, 1st Gen Camaro.....55	● Shifters.....80
● Billet Washers.....100-101	● Grilles, 2nd Gen Camaro.....55	● Speaker Grills.....89
● Carburetor Linkage Brackets.....92	● Halo Seats.....28-29	● Specialty Hinges.....27-29
● Clutch Reservoir.....81	● Hats.....106	● Steering Wheel Adapters/Hubs.....77-78
● Coil Covers.....94-95	● Headlight Covers, Camaro.....55	● Steering Wheels.....71-77
● Coil Relocation Kits.....94	● Heat Shrink Clamps.....26	● Stereo Enclosures.....89
● Courtesy Lights.....84	● Hood Adjusters.....50	● Switch Knobs.....84
● Cowl Vents, 2nd Gen Camaro.....51	● Hood Brace Supports.....49	● Taillights and Bezels, Camaro.....52
● Cowl Vents, Chevelle.....59	● Hood Braces.....49	● Taillights and Bezels, Chevy Truck.....60
● Cowl Vents, Mustang.....59	● Hood Hinge Gas Struts.....47	● Taillights and Bezels, Mustang.....68
● Crossfire Intake Manifold.....92	● Hood Hinges.....30-44	● Taillights and Bezels, Nova.....53
● Cup Holders.....82-83	● Hood Latch and Support, Tri-Five.....49	● Thermostat Housings.....21
● Damper, LS Chevy.....22	● Hood Latches.....57	● Truck Interior/Dash & Door Panels.....106
● Door Handles, Exterior.....63-67	● Hood Stops.....50	● Trunk Hinge Gas Struts.....45
● Door Handles, Interior.....65-66	● Hood Vents, Camaro.....50	● Trunk Hinges.....46-47
● Door Jamb Vents.....59	● Hose Clamps.....26	● T-Shirts.....105
● Door Lock Knobs.....84	● Interior Lights.....84	● Valance Air Vents.....55
● Door Pulls.....84	● LED Cup Holders.....83	● Valve Cover Breathers.....99
● Door Sill Plates, C10.....62	● LED Lights.....102-104	● Valve Cover Hold Downs.....99
● Door Sill Plates, Camaro.....51	● License Plate Frames.....106	● Valve Covers.....95-98
● Door Sill Plates, Chevelle.....51	● LS Coil Covers.....94-95	● V-Belt Pulley Kits.....20
● Door Sill Plates, GTO.....51	● LS Coil Relocation Kits.....94	● Washers, Billet Aluminum.....100-101
● Door Sill Plates, Mustang.....68	● Marker light bezels, Camaro.....53	● Water Outlets.....21
● Door Sill Plates, Tri-Five Chevy.....48	● Marker light bezels, Chevy Truck.....62	● Window Cranks.....65-66
● Door Striker Bolts.....50	● Marker light bezels, El Camino.....53	
● Drink Holders.....82-83	● Marker light bezels, Mustang.....68	
● Fender Braces, Camaro, Nova.....54	● Marker light bezels, Nova.....53	
● Filler Neck Cover, Chevy Truck.....62	● Mirror Adapter Plates, Chevy Truck.....62	
● Fire Extinguishers & Brackets.....56		

**Enhance your buying experience
by visiting www.eddiemotorsports.com
Featuring simple and secure online ordering**

- ▶ View the newest Eddie Motorsport products
- ▶ Access expanded product information and technical support including product diagrams, instructions and dimensions.
- ▶ Complete online dealer support with secure purchasing capabilities and pricing that is always current. Call us today to find out how to get your dealer access code.
- ▶ Stay connected with us through our newsletter, social media pages, posts or uploads on Facebook, Tiktok, Instagram and /or YouTube.



/eddiemotorsports



Online Payment Options



DISCOVER





Serpentine Pulley Drive Systems

EXCEPTIONAL QUALITY AT AFFORDABLE PRICES

One part number gives you everything you need to accessorize your engine with brilliant, high-strength American made billet aluminum brackets and new, name brand components. Available in v-belt, six and eight rib serpentine belt configurations.

Complete kits include:

- All new aluminum water pump
- Powermaster 170 amp Alternator
- GM Type II power steering pump
- Sanden Style AC compressor
- All necessary CNC machined billet aluminum brackets and pulleys
- Made in the USA
- Stainless steel fasteners
- Gates belts and spring loaded tensioner
- SFI Approved balancer (LS models only)

S-Drive™ Eddie Motorsports Serpentine pulley systems are the finest, most compact, and complete engine accessory kits on the market. Change the appearance & performance of your engine with a single 6 or 8 rib serpentine belt to drive all your accessories. Our drive system brackets and pulleys are CNC machined at our facility in Southern California from the highest quality 6061 T6 aluminum. Serpentine pulley systems include all the necessary stainless-steel fasteners and quality name-brand components. All S-Drive Serpentine kits include a Powermaster 170 amp alternator, Gates tensioner and 6 or 8 rib serpentine belt, Sanden style A/C compressor, and GM type II power steering pump. Our LS kits come complete with an SFI approved balancer. All kits are available in seven standard finishes and a variety of custom finishes.

S-Drive PLUS™ Eddie Motorsports S-Drive Plus 8 rib pulley systems have all the same features and benefits as our standard 6 rib belt systems with an additional 33% of surface area to minimize slippage when pushing your engine to the limits. Our S-Drive Plus kits will increase performance, improve durability, and reduce vibration and noise in high RPM applications.



Our V Drive V-belt Pulley Systems offer the same complete, compact design and simple installation as our popular Serpentine Drive systems but at a more affordable price. One part number gives you everything you need to accessorize your engine with American made billet aluminum brackets and pulleys, and new, name-brand components. These kits are equipped to work with electric or mechanical fans.



How to choose a serpentine pulley kit.

We believe Eddie Motorsports S-Drive Serpentine Pulley kits are the best, most complete kits available on the market today. We've put together a video to illustrate the finer points of our systems and to help you make a more informed buying decision. Visit our YouTube channel www.youtube.com/eddiemotorsports to see how to choose the correct serpentine system for your application.

Eddie Motorsports Offers the Widest Selection of Serpentine Belt Pulley Kit Finishes and Options



▲ Machined



▲ Clear Anodized



Highlight ▲

▲ Polished /Clear Coat



▲ Matte Black



▲ Gloss Black /Anodized

NOW AVAILABLE IN
Red, Blue, White, and
CERAKOTE™

Eddie Motorsports S-Drive Pulley Kits are the most compact and complete systems on the market. Billet aluminum brackets, pulleys, and spacers made in the USA ensure perfect fitment and alignment in ever kit.



▲ Attached Plastic Tank



▲ Attached Aluminum Tank



▲ Pump for Remote Tank

Eddie Motorsports S-Drive kits are available with three different power steering pump options



For any serpentine system to function efficiently it should incorporate a spring-loaded belt tensioner. All Eddie Motorsports S-Drive kits include a Gates spring-loaded belt tensioner to increase performance, improve durability, and reduce noise. Check out our YouTube page www.youtube.com/eddiemotorsports watch a video of a belt tensioner working to keep the belt tensioned correctly.

Small Block Chevy Serpentine Pulley Drive Systems



Available Finishes:

*Specify color when ordering: **P**=Bright Polished
M=Raw Machined **BA**=Gloss Black Anodized
BK=Gloss Black **CA**=Clear Anodized **CL**=Protective Clear Coat
MB=Matte Black **R**=Bright Red **B**=Bright Blue **W**=Gloss White **CK**=Cerakote

S-Drive™

Small Block Chevy -Six Rib ⚠

Complete System with A/C, 170 amp Alternator, Aluminum Water pump, and Power Steering * (See page 6-7 for more details.)

- MS107-55 with attached plastic P/S reservoir
- MS107-55B with attached billet aluminum P/S reservoir
- MS107-55R with P/S pump for remote reservoir
- MS107-56 without P/S pump

*Specify finish (machined, polished, color) and steering type (GM steering box, traditional, Mustang II, or center take-off rack&pinion) when ordering

System without Air Conditioning, includes 170 amp Alternator, Aluminum Water pump, and Power Steering *

- MS107-57 with attached plastic P/S reservoir
- MS107-57B with attached billet aluminum P/S reservoir
- MS107-57R with P/S pump for remote reservoir
- MS117-40 Water Pump Pulley for Mechanical Fan

Small Block Chevy Raven Series - Six Rib ⚠

Complete System with All Black components; A/C, 170 amp Alternator, Aluminum Water pump, and Power Steering* (See page 6-7 for more details.)

- MS118-55 with attached plastic P/S reservoir
- MS118-55B with attached billet aluminum P/S reservoir
- MS118-55R with P/S pump for remote reservoir
- MS118-56 without P/S pump

System without Air Conditioning, includes 170 amp Alternator, Aluminum Water pump, and Power Steering *

- MS118-57 with attached plastic P/S reservoir
- MS118-57B with attached billet aluminum P/S reservoir
- MS118-57R with P/S pump
- MS117-40 Water Pump Pulley for Mechanical Fan



*Specify finish (Gloss or Matte Black) and steering type (GM steering box, traditional, Mustang II, or center take-off rack&pinion) when ordering

S-Drive PLUS™

- ▶ 33% greater contact patch ▶ Improved belt traction limits slippage ▶ Handles increased torque loads of 33%

Small Block Chevy -Eight Rib ⚠

Complete System with A/C, 170 amp Alternator, Aluminum Water pump, and Power Steering * (See page 6-7 for more details.)

- MS107-10 with attached plastic P/S reservoir
- MS107-10B with attached billet aluminum P/S reservoir
- MS107-10R with P/S pump for remote reservoir
- MS107-11 without P/S pump

*Specify finish (machined, polished, color) and steering type (GM steering box, traditional, Mustang II, or center take-off rack&pinion) when ordering

System without Air Conditioning, includes 170 amp Alternator, Aluminum Water pump, and Power Steering *

- MS107-12 with attached plastic P/S reservoir
- MS107-12B with attached billet aluminum P/S reservoir
- MS107-12R with P/S pump for remote reservoir

Small Block Chevy Raven Series - Eight Rib ⚠

Complete System with All Black components; A/C, 170 amp Alternator, Aluminum Water pump, and Power Steering* (See page 6-7 for more details.)

- MS118-10 with attached plastic P/S reservoir
- MS118-10B with attached billet aluminum P/S reservoir
- MS118-10R with P/S pump for remote reservoir
- MS118-11 without P/S pump

System without Air Conditioning, includes 170 amp Alternator, Aluminum Water pump, and Power Steering *

- MS118-12 with attached plastic P/S reservoir
- MS118-12B with attached billet aluminum P/S reservoir
- MS118-12R with P/S pump for remote reservoir



*Specify finish (Gloss or Matte Black) and steering type (GM steering box, traditional, Mustang II, or center take-off rack&pinion) when ordering

S-Drive™

Big Block Chevy -Six Rib ⚠️

Complete System with A/C, 170 amp Alternator, Aluminum Water pump, and Power Steering * (See page 6-7 for more details.)

- MS107-50 with attached plastic P/S reservoir
- MS107-50B with attached billet aluminum P/S reservoir
- MS107-50R with P/S pump for remote reservoir
- MS107-51 without P/S pump

*Specify finish (machined, polished, color) and steering type (GM steering box, traditional, Mustang II, or center take-off rack&pinion) when ordering

System without Air Conditioning, includes 170 amp Alternator, Aluminum Water pump, and Power Steering *

- MS107-52 with attached plastic P/S reservoir
- MS107-52B with attached billet aluminum P/S reservoir
- MS107-52R with P/S pump for remote reservoir
- MS117-40 Water Pump Pulley for Mechanical Fan

Big Block Chevy Raven Series - Six Rib ⚠️

Complete System with All Black components; A/C, 170 amp Alternator, Aluminum Water pump, and Power Steering* (See page 6-7 for more details.)

- MS118-50 with attached plastic P/S reservoir
- MS118-50B with attached billet aluminum P/S reservoir
- MS118-50R with P/S pump for remote reservoir
- MS118-51 without P/S pump

System without Air Conditioning, includes 170 amp Alternator, Aluminum Water pump, and Power Steering *

- MS118-52 with attached plastic P/S reservoir
- MS118-52B with attached billet aluminum P/S reservoir
- MS118-52R with P/S pump for remote reservoir
- MS117-40 Water Pump Pulley for Mechanical Fan

*Specify finish (Gloss or Matte Black) and steering type (GM steering box, traditional, Mustang II, or center take-off rack&pinion) when ordering

S-Drive™ PLUS

- ▶ 33% greater contact patch
- ▶ Improved belt traction limits slippage
- ▶ Handles increased torque loads of 33%

Big Block Chevy -Eight Rib ⚠️

Complete System with A/C, 170 amp Alternator, Aluminum Water pump, and Power Steering * (See page 6-7 for more details.)

- MS107-13 with attached plastic P/S reservoir
- MS107-13B with attached billet aluminum P/S reservoir
- MS107-13R with P/S pump for remote reservoir
- MS107-14 without P/S pump

*Specify finish (machined, polished, color) and steering type (GM steering box, traditional, Mustang II, or center take-off rack&pinion) when ordering

System without Air Conditioning, includes 170 amp Alternator, Aluminum Water pump, and Power Steering *

- MS107-15 with attached plastic P/S reservoir
- MS107-15B with attached billet aluminum P/S reservoir
- MS107-15R with P/S pump for remote reservoir

Big Block Chevy Raven Series - Eight Rib ⚠️

Complete System with All Black components; A/C, 170 amp Alternator, Aluminum Water pump, and Power Steering* (See page 6-7 for more details.)

- MS118-13 with attached plastic P/S reservoir
- MS118-13B with attached billet aluminum P/S reservoir
- MS118-13R with P/S pump for remote reservoir
- MS118-14 without P/S pump

System without Air Conditioning, includes 170 amp Alternator, Aluminum Water pump, and Power Steering *

- MS118-15 with attached plastic P/S reservoir
- MS118-15B with attached billet aluminum P/S reservoir
- MS118-15R with P/S pump for remote reservoir

*Specify finish (Gloss or Matte Black) and steering type (GM steering box, traditional, Mustang II, or center take-off rack&pinion) when ordering

Big Block Chevy Serpentine Pulley Drive Systems

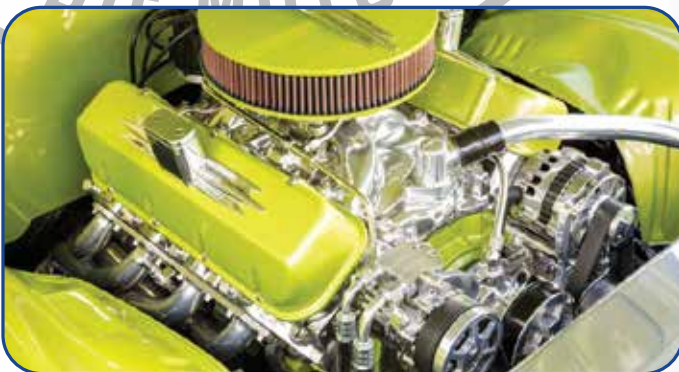

S-Drive PULLEY SYSTEMS



LS Chevy Serpentine Pulley Drive Systems

LS Chevy Pulley Kits come with everything you need to accessorize the front of your engine including a SFI approved balancer.



Available Finishes:

*Specify color when ordering: **P**=Bright Polished
M=Raw Machined **BA**=Gloss Black Anodized
BK=Gloss Black **CA**=Clear Anodized **CL**=Protective Clear Coat
MB=Matte Black **R**=Bright Red **B**=Bright Blue **W**=Gloss White **CK**=Cerakote **HL**=Highlight

Standard LS systems WILL NOT work on engines with Variable Valve Timing (VVT) or superchargers. See page 12 for VVT specific S-Drive kits! For LS7 with dry sump, contact us for instructions.

S-Drive™

LS Chevy -Six Rib ⚠

Complete System with A/C, 170 amp Alternator, Aluminum Water pump, and Power Steering * (See page 6-7 for more details.)

- MS117-90 with attached plastic P/S reservoir
- MS117-90B with attached billet aluminum P/S reservoir
- MS117-90R with P/S pump for remote reservoir
- MS107-91 without P/S pump

*Specify finish (machined, polished, color) and steering type (GM steering box, traditional, Mustang II, or center take-off rack&pinion) when ordering

System without Air Conditioning, includes 170 amp Alternator, Aluminum Water pump, and Power Steering *

- MS117-92 with attached plastic P/S reservoir
- MS117-92B with attached billet aluminum P/S reservoir
- MS117-92R with P/S pump for remote reservoir

LS Chevy Raven Series - Six Rib ⚠

Complete System with All Black components; A/C, 170 amp Alternator, Aluminum Water pump, and Power Steering* (See page 6-7 for more details.)

- MS118-90 with attached plastic P/S reservoir
- MS118-90B with attached billet aluminum P/S reservoir
- MS118-90R with P/S pump for remote reservoir
- MS118-91 without P/S pump

System without Air Conditioning, includes 170 amp Alternator, Aluminum Water pump, and Power Steering *

- MS118-92 with attached plastic P/S reservoir
- MS118-92B with attached billet aluminum P/S reservoir
- MS118-92R with P/S pump for remote reservoir

*Specify finish (Gloss or Matte Black) and steering type (GM steering box, traditional, Mustang II, or center take-off rack&pinion) when ordering



S-Drive™ PLUS

- ▶ 33% greater contact patch
- ▶ Improved belt traction limits slippage
- ▶ Handles increased torque loads of 33%

LS Chevy -Eight Rib ⚠

Complete System with A/C, 170 amp Alternator, Aluminum Water pump, and Power Steering * (See page 6-7 for more details.)

- MS117-86 with attached plastic P/S reservoir
- MS117-86B with attached billet aluminum P/S reservoir
- MS117-86R with P/S pump for remote reservoir
- MS117-87 without P/S pump

*Specify finish (machined, polished, color) and steering type (GM steering box, traditional, Mustang II, or center take-off rack&pinion) when ordering

System without Air Conditioning, includes 170 amp Alternator, Aluminum Water pump, and Power Steering *

- MS117-88 with attached plastic P/S reservoir
- MS117-88B with attached billet aluminum P/S reservoir
- MS117-88R with P/S pump for remote reservoir

LS Chevy Raven Series - Eight Rib ⚠

Complete System with All Black components; A/C, 170 amp Alternator, Aluminum Water pump, and Power Steering* (See page 6-7 for more details.)

- MS118-86 with attached plastic P/S reservoir
- MS118-86B with attached billet aluminum P/S reservoir
- MS118-86R with P/S pump for remote reservoir
- MS118-87 without P/S pump

System without Air Conditioning, includes 170 amp Alternator, Aluminum Water pump, and Power Steering *

- MS118-88 with attached plastic P/S reservoir
- MS118-88B with attached billet aluminum P/S reservoir
- MS118-88R with P/S pump for remote reservoir

*Specify finish (Gloss or Matte Black) and steering type (GM steering box, traditional, Mustang II, or center take-off rack&pinion) when ordering





LS Chevy Elite-Six Rib

Complete System with A/C, 170 amp Alternator, Aluminum Water pump, and Power Steering * (See page 6-7 for more details.)

- MS107-60 with attached plastic P/S reservoir
- MS107-60B with attached billet aluminum P/S reservoir
- MS107-60R with P/S pump for remote reservoir
- MS107-61 without P/S pump

*Specify finish (machined, polished, color) and steering type (GM steering box, traditional, Mustang II, or center take-off rack&pinion) when ordering

System without Air Conditioning, includes 170 amp Alternator, Aluminum Water pump, and Power Steering *

- MS107-62 with attached plastic P/S reservoir
- MS107-62B with attached billet aluminum P/S reservoir
- MS107-62R with P/S pump for remote reservoir

LS Chevy Elite Raven Series - Six Rib

Complete System with All Black components; A/C, 170 amp Alternator, Aluminum Water pump, and Power Steering* (See page 6-7 for more details.)

- MS118-60 with attached plastic P/S reservoir
- MS118-60B with attached billet aluminum P/S reservoir
- MS118-60R with P/S pump for remote reservoir
- MS118-61 without P/S pump



System without Air Conditioning, includes 170 amp Alternator, Aluminum Water pump, and Power Steering *

- MS118-62 with attached plastic P/S reservoir
- MS118-62B with attached billet aluminum P/S reservoir
- MS118-62R with P/S pump for remote reservoir

*Specify finish (Gloss or Matte Black) and steering type (GM steering box, traditional, Mustang II, or center take-off rack&pinion) when ordering

S-Drive PLUS ▶ 33% greater contact patch ▶ Improved belt traction limits slippage ▶ Handles increased torque loads of 33%

LS Chevy Elite -Eight Rib

Complete System with A/C, 170 amp Alternator, Aluminum Water pump, and Power Steering * (See page 6-7 for more details.)

- MS107-16 with attached plastic P/S reservoir
- MS107-16B with attached billet aluminum P/S reservoir
- MS107-16R with P/S pump for remote reservoir
- MS107-17 without P/S pump

*Specify finish (machined, polished, color) and steering type (GM steering box, traditional, Mustang II, or center take-off rack&pinion) when ordering

System without Air Conditioning, includes 170 amp Alternator, Aluminum Water pump, and Power Steering *

- MS107-18 with attached plastic P/S reservoir
- MS107-18B with attached billet aluminum P/S reservoir
- MS107-18R with P/S pump for remote reservoir

LS Chevy Elite Raven Series - Eight Rib

Complete System with All Black components; A/C, 170 amp Alternator, Aluminum Water pump, and Power Steering* (See page 6-7 for more details.)

- MS118-16 with attached plastic P/S reservoir
- MS118-16B with attached billet aluminum P/S reservoir
- MS118-16R with P/S pump for remote reservoir
- MS118-17 without P/S pump



System without Air Conditioning, includes 170 amp Alternator, Aluminum Water pump, and Power Steering *

- MS118-18 with attached plastic P/S reservoir
- MS118-18B with attached billet aluminum P/S reservoir
- MS118-18R with P/S pump for remote reservoir

*Specify finish (Gloss or Matte Black) and steering type (GM steering box, traditional, Mustang II, or center take-off rack&pinion) when ordering

LS Chevy Elite Serpentine Pulley Drive Systems

LS Chevy Elite Pulley Kits come with everything you need to accessorize the front of your engine including an ATI performance SFI approved balancer.



S-Drive PULLEY SYSTEMS

Standard LS systems WILL NOT work on engines with Variable Valve Timing (VVT) or superchargers. See page 12 for VVT specific S-Drive kits! For LS7 with dry sump, contact us for instructions.



LS Chevy VVT Serpentine Pulley Drive Systems

LS Chevy Pulley Kits come with everything you need to accessorize the front of your engine including a SFI approved balancer.



Available Finishes:

*Specify color when ordering: **P**=Bright Polished **M**=Raw Machined **BA**=Gloss Black Anodized **BK**=Gloss Black **CA**=Clear Anodized **CL**=Protective Clear Coat **MB**=Matte Black **R**=Bright Red **B**=Bright Blue **W**=Gloss White **CK**=Cerakote **HL**=Highlight

S-Drive™

LS Chevy -Six Rib ⚠️

Complete System with A/C, 170 amp Alternator, Aluminum Water pump, and Power Steering * (See page 6-7 for more details.)

- MS117-80 with attached plastic P/S reservoir
- MS117-80B with attached billet aluminum P/S reservoir
- MS117-80R with P/S pump for remote reservoir
- MS107-81 without P/S pump

*Specify finish (machined, polished, color) and steering type (GM steering box, traditional, Mustang II, or center take-off rack&pinion) when ordering

System without Air Conditioning, includes 170 amp Alternator, Aluminum Water pump, and Power Steering *

- MS117-82 with attached plastic P/S reservoir
- MS117-82B with attached billet aluminum P/S reservoir
- MS117-82R with P/S pump for remote reservoir

LS Chevy Raven Series - Six Rib ⚠️

Complete System with All Black components; A/C, 170 amp Alternator, Aluminum Water pump, and Power Steering* (See page 6-7 for more details.)

- MS118-80 with attached plastic P/S reservoir
- MS118-80B with attached billet aluminum P/S reservoir
- MS118-80R with P/S pump for remote reservoir
- MS118-81 without P/S pump



System without Air Conditioning, includes 170 amp Alternator, Aluminum Water pump, and Power Steering *

- MS118-82 with attached plastic P/S reservoir
- MS118-82B with attached billet aluminum P/S reservoir
- MS118-82R with P/S pump for remote reservoir

*Specify finish (Gloss or Matte Black) and steering type (GM steering box, traditional, Mustang II, or center take-off rack&pinion) when ordering

S-Drive PLUS™

▶ 33% greater contact patch ▶ Improved belt traction limits slippage ▶ Handles increased torque loads of 33%

LS Chevy -Eight Rib ⚠️

Complete System with A/C, 170 amp Alternator, Aluminum Water pump, and Power Steering * (See page 6-7 for more details.)

- MS117-83 with attached plastic P/S reservoir
- MS117-83B with attached billet aluminum P/S reservoir
- MS117-83R with P/S pump for remote reservoir
- MS117-84 without P/S pump

*Specify finish (machined, polished, color) and steering type (GM steering box, traditional, Mustang II, or center take-off rack&pinion) when ordering

System without Air Conditioning, includes 170 amp Alternator, Aluminum Water pump, and Power Steering *

- MS117-85 with attached plastic P/S reservoir
- MS117-85B with attached billet aluminum P/S reservoir
- MS117-85R with P/S pump for remote reservoir

LS Chevy Raven Series - Eight Rib ⚠️

Complete System with All Black components; A/C, 170 amp Alternator, Aluminum Water pump, and Power Steering* (See page 6-7 for more details.)

- MS118-83 with attached plastic P/S reservoir
- MS118-83B with attached billet aluminum P/S reservoir
- MS118-83R with P/S pump for remote reservoir
- MS118-84 without P/S pump



System without Air Conditioning, includes 170 amp Alternator, Aluminum Water pump, and Power Steering *

- MS118-85 with attached plastic P/S reservoir
- MS118-85B with attached billet aluminum P/S reservoir
- MS118-85R with P/S pump for remote reservoir

*Specify finish (Gloss or Matte Black) and steering type (GM steering box, traditional, Mustang II, or center take-off rack&pinion) when ordering

LS systems WILL NOT work on engines with superchargers. For LS7 applications with dry sump, contact us for instructions.



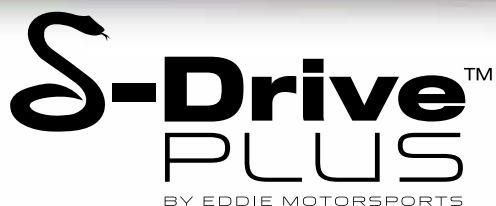

Eight Rib Serpentine Pulley Drive System LS Chevy with Magnuson Supercharger

S-Drive PULLEY SYSTEMS

Our high efficiency, high horsepower eight rib serpentine pulley system for LS Chevys using Magnuson's Universal Hot Rod Blower Kit (Our kit is designed to fit the: Magnuson TVS2300 with a 2010-2015 Camaro belt line). The pulley kits comes with everything you need to accessorize the front of your engine including a ATI performance SFI approved balancer.

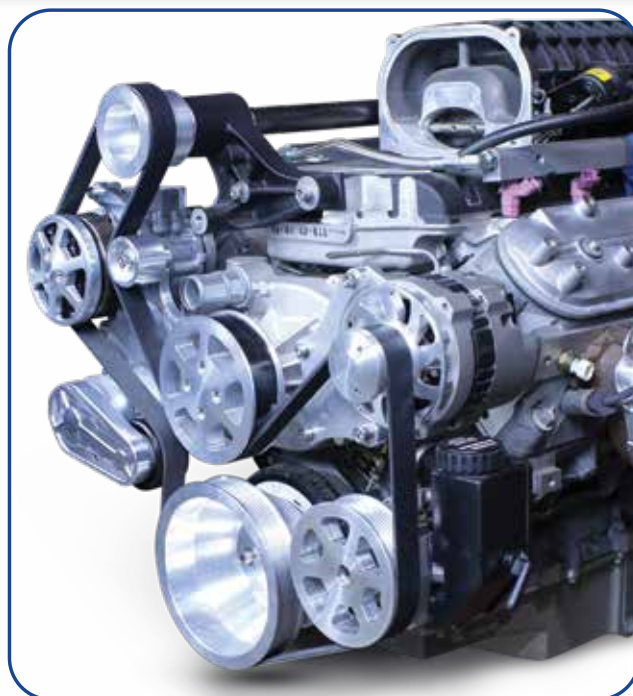

LS Chevy with Magnuson Supercharger ⚠️

Complete System with A/C, 170 amp Alternator, Aluminum Water pump, and Power Steering * (See page 6-7 for more details.)

- MS107-27 with attached plastic P/S reservoir
- MS107-27B with attached billet aluminum P/S reservoir
- MS107-27R with P/S pump for a remote reservoir

*Specify finish (machined, polished, color) and steering type (GM steering box, traditional, Mustang II, or center take-off rack&pinion) when ordering

System without Power Steering, includes A/C, 170 amp Alternator, and Aluminum Water pump *

- MS107-28M Machined
- MS107-28P Polished
- MS107-28XX Specify Color
- MS107-29R No A/C w/P/S pump for a remote reservoir

LS Chevy with Magnuson Supercharger Raven Series ⚠️

Complete System with All Black components; A/C, 170 amp Alternator, Aluminum Water pump, and Power Steering* (See page 6-7 for more details.)

- MS118-27 with attached plastic P/S reservoir
- MS118-27B with attached billet aluminum P/S reservoir
- MS118-27R with P/S pump for a remote reservoir

System without Power Steering, includes A/C, 170 amp Alternator, and Aluminum Water pump *

- MS118-28BA Black Anodized
- MS118-28BK Gloss Black
- MS118-28MB Matte Black
- MS118-29R No A/C w/P/S pump for a remote reservoir



*Specify finish (Gloss or Matte Black) and steering type (GM steering box, traditional, Mustang II, or center take-off rack&pinion) when ordering



LS systems WILL NOT work on engines with Variable Valve Timing (VVT) or superchargers. See pages 12 for VVT specific S-Drive kits! For LS7 with dry sump, contact us for instructions.



Serpentine Pulley Drive Systems LS Chevy Pro Touring

S-Drive™
PLUS
BY EDDIE MOTORSPORTS

Eddie Motorsports Pro Touring S-Drive 8 rib pulley kits have all the same features and benefits of our standard kit with an oversize power steering pulley and secondary idler pulley for increased wrap and improved performance in high RPM Autocross style driving. Pro Touring LS Kits come complete with all necessary precision CNC machined billet aluminum brackets & pulleys, which are made in the USA, as well as high quality, name brand components; PRW aluminum water pump, Sanden-style compact A/C compressor, GM type II power steering pump for a remote reservoir (resevoir sold separately), Powermaster 170A alternator, SFI approved ATI performance balancer. Available in seven custom finishes. Kits with polished and clear finishes include polished components, kits with colored finishes include natural cast finish components. Raven series pulley kits come with all black components.



LS Chevy Pro Touring ⚠️

Complete System with A/C, 170 amp Alternator, Aluminum Water pump, and Power Steering pump for a remote resevoir.

MS117-95 with P/S pump for remote resevoir

LS Chevy Pro Touring Raven Series ⚠️

Complete System with All Black components; A/C, 170 amp Alternator, Aluminum Water pump, and Power Steering pump for a remote resevoir.

MS118-94 with P/S pump for remote resevoir



Available Finishes:

*Specify color when ordering: **P**=Bright Polished
M=Raw Machined **BA**=Gloss Black Anodized
BK=Gloss Black **CA**=Clear Anodized **CL**=Protective Clear Coat
MB=Matte Black **R**=Bright Red **B**=Bright Blue
W=Gloss White **CK**=Cerakote **HL**=Highlight



LS systems WILL NOT work on engines with superchargers. For LS7 applications with dry sump, contact us for instructions.





Serpentine Pulley Drive Systems LSA/LS9 Chevy

Eddie Motorsports' S-Drive 8 rib serpentine pulley kits include everything to accessorize your LSA or LS9. Designed with a single serpentine belt our LSA Chevy Kits come complete with all necessary precision CNC machined billet aluminum brackets & pulleys, which are made in the USA, as well as high quality, name-brand components; PRW aluminum water pump, Sanden-style compact AC compressor, GM type II power steering pump with attached plastic reservoir, Powermaster 170A alternator, SFI approved ATI Racing balancer. Available in seven custom finishes. Kits with polished and clear finishes include polished components, kits with colored finishes include natural cast finish components. Raven series pulley kits come with all black components. Specify steering type in the order notes when placing your order (power steering gearbox or rack and pinion).



LS Chevy LSA/LS9 ⚠️

Complete System with A/C, 170 amp Alternator, Aluminum Water pump, and Power Steering * (See page 6-7 for more details.)
MS117-96 with attached plastic P/S reservoir

*Specify finish (machined, polished, color) and steering type (GM steering box, traditional, Mustang II, or center take-off rack&pinion) when ordering

LS Chevy LSA Raven Series ⚠️

Complete System with All Black components; A/C, 170 amp Alternator, Aluminum Water pump, and Power Steering* (See page 6-7 for more details.)
MS118-96 with attached plastic P/S reservoir

*Specify finish (Gloss or Matte Black) and steering type (GM steering box, traditional, Mustang II, or center take-off rack&pinion) when ordering



LS systems WILL NOT work on engines with Variable Valve Timing (VVT) or superchargers. See page 12 for VVT specific S-Drive kits! For LS7 with dry sump, contact us for instructions.

Available Finishes:

*Specify color when ordering: **P**=Bright Polished **M**=Raw Machined **BA**=Gloss Black Anodized
BK=Gloss Black **CA**=Clear Anodized **CL**=Protective Clear Coat **MB**=Matte Black **R**=Bright Red
B=Bright Blue **W**=Gloss White **CK**=Cerakote **HL**=Highlight



Serpentine Pulley Drive Systems Big Block Mopar

S-Drive™

Our Mopar kits come with everything necessary to accessorize the front of your engine including an aluminum water pump housing and a Mopar OEM look, 165A amp, one wire alternator with internal cooling fan. Our Mopar S-Drives are the cleanest looking systems on the market as we utilize a single spring loaded tensioner to keep the serpentine belt properly tensioned at all times; no need for multiple idler pulleys to clutter up the assembly. **The Mopar S-Drive must be used in conjunction with a thin crank vibration damper with dimensions of Mopar Performance number P3830183 or equivalent (distance from the face of the timing cover mounting surface on the block to the pulley mount surface on the face of the damper measures 2.144". Spacers are available to accommodate shorter dampers).**



Big Block Mopar 383-426 Hemi-440 S-Drive Serpentine Systems ⚠

Complete System with A/C, 165A amp Alternator, Aluminum Water pump, and Power Steering * (See page 6-7 for more details.)

- MS107-67 with attached plastic P/S reservoir
- MS107-67B with attached billet aluminum P/S reservoir
- MS107-67R with P/S pump for remote reservoir
- MS107-68 without P/S pump

*Specify finish (machined, polished, color) and steering type (GM steering box, traditional, Mustang II, or center take-off rack&pinion) when ordering

System without Air Conditioning, includes 165A amp Alternator, Aluminum Water pump, and Power Steering *

- MS107-69 with attached plastic P/S reservoir
- MS107-69B with attached billet aluminum P/S reservoir
- MS107-69R with P/S pump for remote reservoir

- MS117-52 Water Pump Pulley for Mechanical Fan

Big Block Mopar 383-426 Hemi-440 S-Drive Serpentine Systems Raven Series ⚠

Complete System with All Black components; A/C, 165A amp Alternator, Aluminum Water pump, and Power Steering* (See page 6-7 for more details.)

- MS118-67 with attached plastic P/S reservoir
- MS118-67B with attached billet aluminum P/S reservoir
- MS118-67R with P/S pump for remote reservoir
- MS118-68 without P/S pump

System without Air Conditioning, includes 165A amp Alternator, Aluminum Water pump, and Power Steering *

- MS118-69 with attached plastic P/S reservoir
- MS118-69B with attached billet aluminum P/S reservoir
- MS118-69R with P/S pump for remote reservoir

*Specify finish (Gloss or Matte Black) and steering type (GM steering box, traditional, Mustang II, or center take-off rack&pinion) when ordering



CERAKOTE™

Available Finishes:

*Specify color when ordering: **P**=Bright Polished
M=Raw Machined **BA**=Gloss Black Anodized
BK=Gloss Black **CA**=Clear Anodized **CL**=Protective Clear Coat
MB=Matte Black **R**=Bright Red **B**=Bright Blue **W**=Gloss White **CK**=Cerakote



S-Drive™

Serpentine Pulley Drive Systems Small Block Ford

Small Block Ford Serpentine Pulley Kits come with everything you need to accessorize the front of your engine including a billet aluminum timing cover for easy installation. The cover does NOT have a provision for a fuel pump (the cover requires use of an electric pump). Kits are designed for use with factory four bolt pattern balancers with a maximum diameter of 6.40" and a measurement from the face (pulley mounting surface) to the block surface of 4.70". Aftermarket dampers can be purchased for engines requiring a 28 oz externally balanced model. Front sump oil pan applications require a new dipstick and tube assembly (sold separately).



Small Block Ford 289-351W ⚠️

Complete System with A/C, 170 amp Alternator, Aluminum Water pump, and Power Steering * (See page 6-7 for more details.)

- MS107-63 with attached plastic P/S reservoir
- MS107-63B with attached billet aluminum P/S reservoir
- MS107-63R with P/S pump for remote reservoir
- MS107-73 Dipstick and Tube assembly for front sump oil pans
- MS107-64 without P/S pump

*Specify finish (machined, polished, color) and steering type (GM steering box, traditional, Mustang II, or center take-off rack&pinion) when ordering

System without Air Conditioning, includes 170 amp Alternator, Aluminum Water pump, and Power Steering *

- MS107-65 with attached plastic P/S reservoir
- MS107-65B with attached billet aluminum P/S reservoir
- MS107-65R with P/S pump for remote reservoir
- MS117-50 Water Pump Pulley for Mechanical Fan

Small Block Ford 289-351W Raven Series ⚠️

Complete System with All Black components; A/C, 170 amp Alternator, Aluminum Water pump, and Power Steering* (See page 6-7 for more details.)

- MS118-63 with attached plastic P/S reservoir
- MS118-63B with attached billet aluminum P/S reservoir
- MS118-63R with P/S pump for remote reservoir
- MS107-73 Dipstick and Tube assembly for front sump oil pans
- MS118-64 without P/S pump

System without Air Conditioning, includes 170 amp Alternator, Aluminum Water pump, and Power Steering *

- MS118-65 with attached plastic P/S reservoir
- MS118-65B with attached billet aluminum P/S reservoir
- MS118-65R with P/S pump for remote reservoir
- MS117-50 Water Pump Pulley for Mechanical Fan

*Specify finish (Gloss or Matte Black) and steering type (GM steering box, traditional, Mustang II, or center take-off rack&pinion) when ordering



Available Finishes:

*Specify color when ordering: **P**=Bright Polished **M**=Raw Machined **BA**=Gloss Black Anodized **BK**=Gloss Black **CA**=Clear Anodized **CL**=Protective Clear Coat **MB**=Matte Black **R**=Bright Red **B**=Bright Blue **W**=Gloss White **CK**=Cerakote



S-Drive™

Serpentine Pulley Drive Systems Cleveland Ford

Ford Cleveland kits utilize two six rib serpentine belts and are designed for use with factory four bolt pattern balancers. Our drive system's brackets and pulleys are CNC-machined from high quality billet aluminum. The pulley system also includes the necessary stainless steel fasteners as well as the highest quality name-brand components including a Powermaster 170 amp alternator, Gates tensioner, serpentine belts, Sanden style A/C compressor, and GM Type II power steering pump with three optional reservoir configurations (Ford Cleveland kits DO NOT include a water pump). S-Drive kits are available in seven custom finishes.

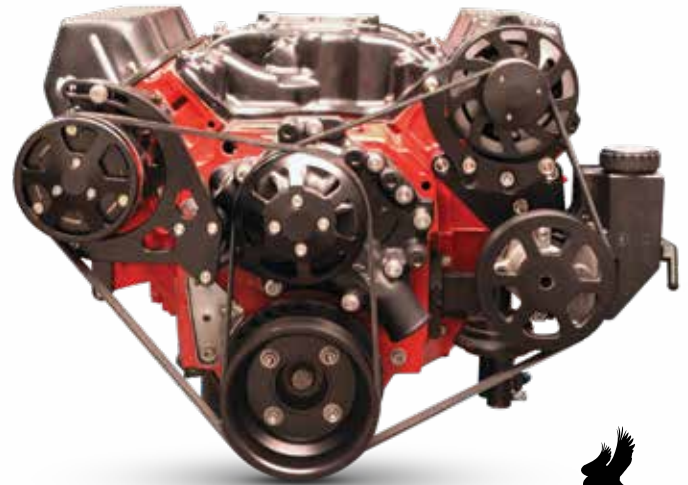
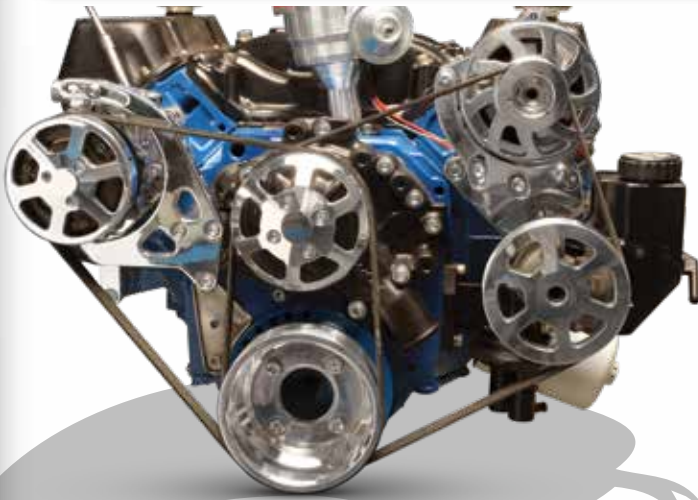

Cleveland Ford 351C ⚠

Complete System with A/C, 170 amp Alternator, and Power Steering *

See page 6-7 for more details.

- MS107-66 with attached plastic P/S reservoir
- MS107-66B with attached billet aluminum P/S reservoir
- MS107-66R with P/S pump for remote reservoir

MS117-54 Water Pump Pulley for Mechanical Fan

*Specify finish (machined, polished, color) and steering type (Ford steering box, traditional, Mustang II, or center take-off rack&pinion) when ordering

Cleveland Ford 351C Raven Series ⚠

Complete System with All Black components: A/C, 170 amp Alternator, and Power Steering *

See page 6-7 for more details.

- MS118-66 with attached plastic P/S reservoir
- MS118-66B with attached billet aluminum P/S reservoir
- MS118-66R with P/S pump for remote reservoir

MS117-54 Water Pump Pulley for Mechanical Fan

*Specify finish (Gloss or Matte Black) and steering type (Ford steering box, traditional, Mustang II, or center take-off rack&pinion) when ordering



Available Finishes:

*Specify color when ordering: **P**=Bright Polished **M**=Raw Machined **BA**=Gloss Black Anodized **BK**=Gloss Black **CA**=Clear Anodized **CL**=Protective Clear Coat **MB**=Matte Black **R**=Bright Red **B**=Bright Blue **W**=Gloss White **CK**=Cerakote



Serpentine Pulley Drive Systems Pontiac V-8 Engines 326-455

S-Drive™



1964-68 Early Model -Eight Bolt Water Pump ⚠️

Complete System with A/C, 170 amp Alternator, Cast Iron 8 Bolt Water pump, and Power Steering * (See page 6-7 for more details.)

- MS117-60 with attached plastic P/S reservoir
- MS117-60B with attached billet aluminum P/S reservoir
- MS117-60R with P/S pump for remote reservoir
- MS117-61 without P/S pump

MS117-56 Water Pump Pulley for Mechanical Fan

*Specify finish (machined, polished, color) and steering type (GM steering box, traditional, Mustang II, or center take-off rack&pinion) when ordering

1964-68 Early Model Raven Series -Eight Bolt ⚠️

Complete System with All Black components; A/C, 170 amp Alternator, Cast Iron 8 Bolt Water pump, and Power Steering* (See page 6-7 for more details.)

- MS118-70 with attached plastic P/S reservoir
- MS118-70B with attached billet aluminum P/S reservoir
- MS118-70R with P/S pump for remote reservoir
- MS118-71 without P/S pump

MS117-56 Water Pump Pulley for Mechanical Fan

*Specify finish (Gloss or Matte Black) and steering type (GM steering box, traditional, Mustang II, or center take-off rack&pinion) when ordering



1969 & Up Late Model -Eleven Bolt Water Pump ⚠️

Complete System with A/C, 170 amp Alternator, Aluminum 11 Bolt Water pump, and Power Steering * (See page 6-7 for more details.)

- MS117-65 with attached plastic P/S reservoir
- MS117-65B with attached billet aluminum P/S reservoir
- MS117-65R with P/S pump for remote reservoir
- MS117-66 without P/S pump

MS117-58 Water Pump Pulley for Mechanical Fan

*Specify finish (machined, polished, color) and steering type (GM steering box, traditional, Mustang II, or center take-off rack&pinion) when ordering

1969 & Up Late Model Raven Series -Eleven Bolt ⚠️

Complete System with All Black components; A/C, 170 amp Alternator, Aluminum 11 Bolt Water pump, and Power Steering

*(See page 6-7 for more details.)

- MS118-75 with attached plastic P/S reservoir
- MS118-75B with attached billet aluminum P/S reservoir
- MS118-75R with P/S pump for remote reservoir
- MS118-76 without P/S pump

MS117-58 Water Pump Pulley for Mechanical Fan

*Specify finish (Gloss or Matte Black) and steering type (GM steering box, traditional, Mustang II, or center take-off rack&pinion) when ordering



Available Finishes:

*Specify color when ordering: **P**=Bright Polished
M=Raw Machined **BA**=Gloss Black Anodized
BK=Gloss Black **CA**=Clear Anodized **CL**=Protective Clear Coat
MB=Matte Black **R**=Bright Red **B**=Bright Blue
W=Gloss White **CK**=Cerakote



V Drive V-belt Pulley Systems

Our V Drive Systems offer the same complete, compact design and simple installation as our popular Serpentine Drive systems but at a more affordable price. These kits are equipped to work with electric or mechanical fans.

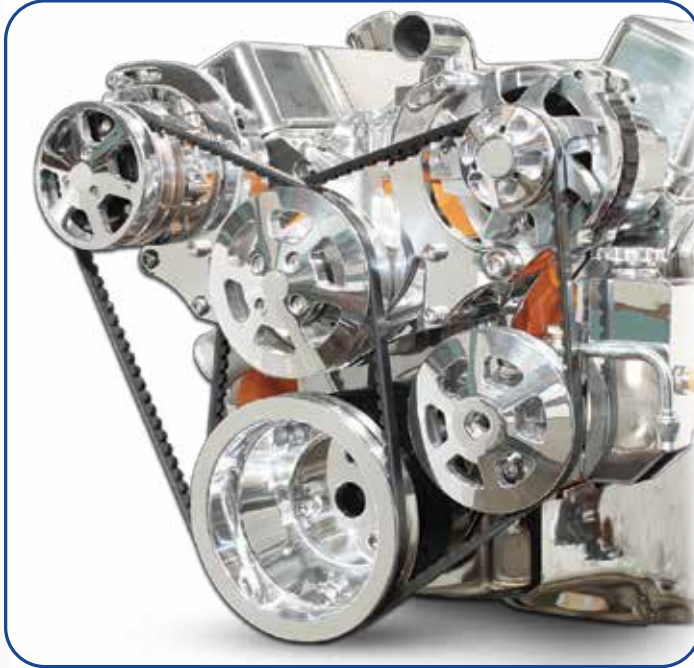

V Drive -Small Block ⚠️

Complete System with A/C, 170 amp Alternator, Aluminum Water pump, and Power Steering * (See page 6-7 for more details.)

- MS107-90 with attached plastic P/S reservoir
- MS107-90B with attached billet aluminum P/S reservoir
- MS107-90R with P/S pump for remote reservoir
- MS107-91 without P/S pump

*Specify finish (machined, polished, color) and steering type (GM steering box, traditional, Mustang II, or center take-off rack&pinion) when ordering

System without Air Conditioning, includes 170 amp Alternator, Aluminum Water pump, and Power Steering *

- MS107-92 with attached plastic P/S reservoir
- MS107-92B with attached billet aluminum P/S reservoir
- MS107-92R with P/S pump for remote reservoir

V Drive Raven Series - Small Block ⚠️

Complete System with All Black components; A/C, 170 amp Alternator, Aluminum Water pump, and Power Steering* (See page 6-7 for more details.)

- MS118-30 with attached plastic P/S reservoir
- MS118-30B with attached billet aluminum P/S reservoir
- MS118-30R with P/S pump for remote reservoir
- MS118-31 without P/S pump



System without Air Conditioning, includes 170 amp Alternator, Aluminum Water pump, and Power Steering *

- MS118-32 with attached plastic P/S reservoir
- MS118-32B with attached billet aluminum P/S reservoir
- MS118-32R with P/S pump for remote reservoir

*Specify finish (Gloss or Matte Black) and steering type (GM steering box, traditional, Mustang II, or center take-off rack&pinion) when ordering

V Drive -Big Block ⚠️

Complete System with A/C, 170 amp Alternator, Aluminum Water pump, and Power Steering * (See page 6-7 for more details.)

- MS107-95 with attached plastic P/S reservoir
- MS107-95B with attached billet aluminum P/S reservoir
- MS107-95R with P/S pump for remote reservoir
- MS107-96 without P/S pump

*Specify finish (machined, polished, color) and steering type (GM steering box, traditional, Mustang II, or center take-off rack&pinion) when ordering

System without Air Conditioning, includes 170 amp Alternator, Aluminum Water pump, and Power Steering *

- MS107-97 with attached plastic P/S reservoir
- MS107-97B with attached billet aluminum P/S reservoir
- MS107-97R with P/S pump for remote reservoir

V Drive Raven Series-Big Block ⚠️

Complete System with All Black components; A/C, 170 amp Alternator, Aluminum Water pump, and Power Steering* (See page 6-7 for more details.)

- MS118-95 with attached plastic P/S reservoir
- MS118-95B with attached billet aluminum P/S reservoir
- MS118-95R with P/S pump for remote reservoir
- MS118-96 without P/S pump



System without Air Conditioning, includes 170 amp Alternator, Aluminum Water pump, and Power Steering *

- MS118-97 with attached plastic P/S reservoir
- MS118-97B with attached billet aluminum P/S reservoir
- MS118-97R with P/S pump for remote reservoir

*Specify finish (Gloss or Matte Black) and steering type (GM steering box, traditional, Mustang II, or center take-off rack&pinion) when ordering



Available Finishes:

*Specify color when ordering: **P**=Bright Polished
M=Raw Machined **BA**=Gloss Black Anodized
BK=Gloss Black **CA**=Clear Anodized **CL**=Protective Clear Coat **MB**=Matte Black **R**=Bright Red **B**=Bright Blue **W**=Gloss White **CK**=Cerakote

Billet Aluminum Thermostat Housings

Available for Small Block, Big Block and LS Chevs. Made in the USA from 6061-T6 billet aluminum, these housings feature a 360 degree swivel design that allows for correct hose alignment. The housings have an 80 degree outlet position and accept 1-1/2" radiator hoses. Small and big block Chevy housings utilize an O-ring seal eliminating the need for a gasket or sealer. LS Chevy housings replace stock pieces that have mounting holes with a 3" center-to-center dimension ONLY. These also utilize the stock factory seal with a 2 1/2" OD (sold separately). Available in black or clear anodized, raw machined, and bright polished finishes. Specify when ordering.



Thermostat Housing for Small & Big Block Chevy ⚠️

- MS106-85M Machined
- MS106-85P Polished
- MS106-85CA Clear Anodized
- MS106-85BA Gloss Black Anodized



Thermostat Housing for LS Chevy * ⚠️

- MS106-90M Machined
- MS106-90P Polished
- MS106-90CA Clear Anodized
- MS106-90BA Gloss Black Anodized

*ONLY replaces housing with 3" center-to-center mounting holes.



- Thermostat and Seal ⚠️
- MS106-75S Seal Ring for LS Chevy
 - MS106-75T 187° Thermostat and seal ring for LS Chevy





LT1 Gen V Chevy Accessory Kits

LT1 Gen V Chevy Power Steering Kit ⚠️

Add power steering to your new LT1. The kit works in conjunction with the stock LT1 Front Engine Accessory Drive and comes complete with a GM Type II power steering pump, all necessary billet aluminum brackets and pulleys, stainless steel fasteners, and a belt. The kit requires the use of an ATI Racing #917314 (or equivalent) six rib damper (sold separately).

- MS107-19 with attached plastic P/S reservoir
- MS107-19B with attached billet aluminum P/S reservoir
- MS107-19R with P/S pump for remote reservoir
- MS100-18 ATI Racing Damper

*Specify finish (machined, polished, color) and steering type (GM steering box, traditional, Mustang II, or center take-off rack&pinion) when ordering



LT1 Gen V Chevy Air Conditioning Kit ⚠️

The kit works in conjunction with the stock LT1 Front Engine Accessory Drive and gives you everything you need to install a compact Sanden SD7 air conditioning compressor for use with aftermarket air conditioning applications. The complete kit comes with a new compressor, all necessary billet aluminum brackets, compressor manifold, pulley cover, and stainless steel fasteners.

- MS107-98M Machined MS107-98P Polished
- MS107-98XX Specify Color



LT1 Gen V Chevy AC Delete Kit ⚠️

The kit works in conjunction with the stock LT1 Front Engine Accessory Drive for applications where air conditioning is not used.

- MS107-23M Machined MS107-23P Polished
- MS107-23XX Specify Color

LS Chevy Damper ⚠️

This SFI Approved balancer has a 6.325" diameter and requires the use of an aftermarket crank pulley like those found in Eddie Motorsports S-Drive Serpentine Belt Pulley kits (The balancer DOES NOT have integral serpentine belt grooves). This is a two piece unit with a CNC-machined aluminum outer shell and a steel hub. Also requires a new crank bolt for installation. Will not work on engines equipped with Variable Valve Timing (VVT).

- MS100-27 Damper
- MS100-11F LS Damper Bolt
- MS100-11S LS Harmonic Balancer w/Steel Hub



Billet Remote Power Steering Reservoir ⚠

When power steering reservoir clearance is an issue, our Billet Remote Reservoirs can be easily mounted up and out of the way. Remote tanks also have more capacity than attached reservoirs keeping the power steering fluid cooler. With an 18 oz capacity, the tanks are 9 1/2" tall, 2 3/4" round, and include an adjustable billet mounting bracket for easy installation. The reservoirs include a -6 AN pressure fitting and -10 AN return fitting. Available in raw machined and bright polished finish as well as a variety of Fusioncoat and anodized finishes.

MS107-80 Remote Reservoir



Billet Bolt-on Power Steering Reservoir ⚠

Machined from 6061-T6 aluminum, one of these Billet Power Steering tanks will add the finishing touch to any customized engine compartment. Offered as an option on many of our S-Drive pulley systems, the tanks are a replacement for the plastic reservoirs on GM type II pumps. The reservoirs are bolt-on for easy and positive installation and do not rely on the frustrating stock steel clips for fastening. Our billet aluminum reservoirs won't crack or leak like plastic tanks can! The reservoirs utilize a -8 AN return fitting. Specify finish when ordering.

NOTE: Billet tanks are NOT recommended for use in high usage or performance driving applications or for use with Hydroboost brake systems.



MS107-81M Bolt on Machined
MS107-81P Bolt on Polished
MS107-81XX Bolt on Color

Billet Radiator Overflow Tanks ⚠

Machined from 6061-T6 aluminum, Billet Aluminum Radiator Overflow Tanks are built to match our remote Power Steering tanks. With an 18 oz capacity, the tank is 9 1/2" tall, 2 3/4" round and feature a press-in, double o-ring cap and an internal return tube. The billet tanks have 5/16 hose fittings on the inlet and outlet and include an adjustable billet mounting bracket for easy installation. Available in raw machined or bright polished finish as well as a variety of Fusioncoat and anodized finishes.

MS107-88XX Radiator Overflow Tank



Power Steering Hardline ⚠

This custom line works on GM type II pumps with 16mm x 1.5 threads to adapt to a -6 AN pressure line. Standard equipment in our S-Drive kits with attached power steering tanks, the stainless steel line wraps around the back of the power steering pump to route your line cleanly out of the way. The kit comes complete with 16mm to -6 AN adapter fitting.

MS100-03L Power Steering Hardline



*Specify color when ordering: **P**=Bright Polished **M**=Raw Machined **BA**=Gloss Black Anodized

BK=Gloss Black **CA**=Clear Anodized **CL**=Protective Clear Coat **MB**=Matte Black **B**=Blue **R**=Red **W**=White **CH**=Chrome **CK**=Cerakote



Power Steering Line Kits ⚠

Kits provide stainless braided/Teflon lines and steel fittings to connect your power steering to our S-Drive or V Drive Pulley kits.



MS107-30	1965-79 Attached Plastic Reservoir & GM gearbox
MS107-30R	1965-79 EMS Remote Billet Reservoir & GM gearbox
MS107-33	1965-79 Attached Billet Reservoir w/-6 return & GM gearbox
MS107-38	1965-79 Attached Billet Reservoir w/-8 return & GM gearbox
MS107-31	1980-up Attached Plastic Reservoir & GM gearbox or GM rack & pinion
MS107-31R	1980-up EMS Remote Billet Reservoir & GM gearbox or GM rack & pinion
MS107-34	1980-up Attached Billet Reservoir w/-6 return & GM gearbox or GM rack & pinion
MS107-36	1980-up Attached Billet Reservoir w/-8 return & GM gearbox or GM rack & pinion
MS107-32	Ford TRW rack & pinion with 1 piece aluminum housing. Used in most aftermarket Mustang II front ends (i.e. Heidts, Fatman, TCI, etc). With attached Plastic Reservoir
MS107-32R	EMS Remote Billet Reservoir and Ford TRW rack & pinion with 1 piece aluminum housing. Used in most aftermarket Mustang II front ends (i.e. Heidts, Fatman, TCI, etc).
MS107-35	Ford TRW rack & pinion (same as above) With attached Billet Reservoir w/-6 return
MS107-39	Ford TRW rack & pinion (same as above) With attached Billet Reservoir w/-8 return
MS107-37	-10 return line (36" long) & hose ends only for use with remote reservoir.

Universal Billet Aluminum Adjusting Rods ⚠

Add adjustability to your accessory mounting brackets. The rods come with steel 3/8" right and left hand rod ends. The rod adjusts out 1-1/2" from the specified dimension, measured from the center of the rod end mounting holes. Available in a bright polished or raw machined finish as well as a variety of Fusioncoat or anodized finishes. Sold individually.



MS105-40M	4 1/2" Machined	MS105-45M	10" Machined
MS105-40P	4 1/2" Polished	MS105-45P	10" Polished
MS105-40XX	4 1/2" Color	MS105-45XX	10" Color
MS105-41M	5" Machined	MS105-46M	11" Machined
MS105-41P	5" Polished	MS105-46P	11" Polished
MS105-41XX	5" Color	MS105-46XX	11" Color
MS105-42M	7" Machined	MS105-47M	12" Machined
MS105-42P	7" Polished	MS105-47P	12" Polished
MS105-42XX	7" Color	MS105-47XX	12" Color
MS105-43M	7 1/2" Machined	MS105-48M	13" Machined
MS105-43P	7 1/2" Polished	MS105-48P	13" Polished
MS105-43XX	7 1/2" Color	MS105-48XX	13" Color
MS105-44M	9" Machined	MS105-49M	17" Machined
MS105-44P	9" Polished	MS105-49P	17" Polished
MS105-44XX	9" Color	MS105-49XX	17" Color



*Specify color when ordering: **P**=Bright Polished **M**=Raw Machined **BA**=Gloss Black Anodized **BK**=Gloss Black **CA**=Clear Anodized **CL**=Protective Clear Coat **MB**=Matte Black **B**=Blue **R**=Red **W**=White **CK**=Cerakote



Engine Components

GM Type II Power Steering Pumps ⚠

These cast aluminum pumps are the perfect upgrade when replacing your power steering system. Models are available with a plastic or billet aluminum attached reservoir or configured for use with a remote mounted reservoir. The pumps have a 17MM main shaft, three 8MM-1.25 mounting holes, and are available with a natural cast, bright polished, or black finish. Pumps are also available without threaded mounting holes for replacement of Eddie Motorsports (and other brand) pulley systems. All pumps come with pressure valves for both power steering gearboxes (high flow) and rack & pinion (low flow).

Pump for use with a remote reservoir ⚠

(sold separately) Pump has -6 AN Pressure fitting, -10AN return fitting, and 8MM-1.25 threaded mounting bosses. Specify pump finish.

MS100-70XX Power Steering Pump

Eddie Motorsports replacement with 5/16 mounting holes

MS100-71XX Power Steering Pump



Pump with plastic attached reservoir ⚠

Pump has -16MM x 1.5 female pressure fitting and -3/8" barbed return fitting with 8MM-1.25 threaded mounting holes. Specify pump finish.

MS100-72XX Power Steering Pump

Eddie Motorsports replacement with 5/16 mounting holes

MS100-73XX Power Steering Pump



Pump with billet aluminum attached reservoir ⚠

Pump has -16MM x 1.5 female pressure fitting and -8AN return fitting with 8MM-1.25 threaded mounting holes. Specify reservoir finish.

MS100-72MXX Natural Cast Pump

MS100-72PXX Polished Pump

MS100-72BKXX Black Pump

Eddie Motorsports replacement with 5/16 mounting holes

MS100-73MXX Natural Cast Pump

MS100-73PXX Polished Pump

MS100-73BKXX Black Pump



Pump Only ⚠

Must be used with a plastic or billet aluminum attached reservoir (sold separately). With 8MM-1.25 threaded mounting holes. Specify pump finish.

MS100-74XX Pump Only

Eddie Motorsports replacement with 5/16 mounting holes

MS100-75XX Pump Only



Air Compressor Manifold ⚠

This billet aluminum manifold bolts to Sanden style SD-7 compressors to accept industry standard -8 and -10 refrigeration O-ring fittings/lines. Use may require machining the compressor for installation. Includes stainless steel fasteners. Available in seven custom finishes, specify when ordering.

MS107-47XX

Specify Color
-8AN & -10AN

MS107-47SXX

Specify Color
-8 & -10



Aluminum Water Pumps ⚠

There's no easier way to drop a few pounds off of the front of your engine than by installing an aluminum water pump. Aluminum can also give your engine a more custom look. Eddie Motorsports now carries high quality aluminum short water pumps for Small Block, Big Block, and LS Chevys. Available in natural cast, black, and bright polished finishes with standard rotation (for V-belt systems) and reverse rotation (for serpentine belt systems) configurations. Specify finish when ordering.

MS100-30XX

SB Chevy Reverse

MS100-34XX

SB Chevy Standard

MS100-36XX

BB Chevy Reverse

MS100-37XX

BB Chevy Standard

MS100-38XX

LS Chevy Reverse



Air Conditioning Compressors ⚠

Sanden SD7 style air conditioning compressors have become the industry standard for compact, custom installations. Eddie Motorsports now offers these universal compressors in several configurations for v-belt, 6 rib and 8 rib serpentine belt applications. Available in natural cast, black, and bright polished finishes, the compressors are machined to accept our billet aluminum A/C manifold. Specify finish when ordering.

MS100-61XX

Serpentine Belt Machined for Billet Manifold

MS100-63XX

V-Belt Machined for Billet Manifold

MS100-65XX

Serpentine belt 8-rib machined for billet manifold

MS100-47XX

Billet Aluminum Manifold with -10 and -8 A/C hose connections



Heat Shrink Hose Clamps ⚠️

Don't trust your engine to just any hose clamps. Try these all new, heat-sensitive, thermoplastic clamps that seal better in all conditions and temperature extremes. All you need to install them is an ordinary heat gun. Yes, that's it! Measure accurately to determine the correct size clamp and apply heat until the clamp shrinks and makes a secure, hard plastic seal. Not only do the clamps bond better than a traditional screw type clamp, they are thinner and far more visibly pleasing in your hot rod's dressed-up engine bay. Clamps are sold individually.

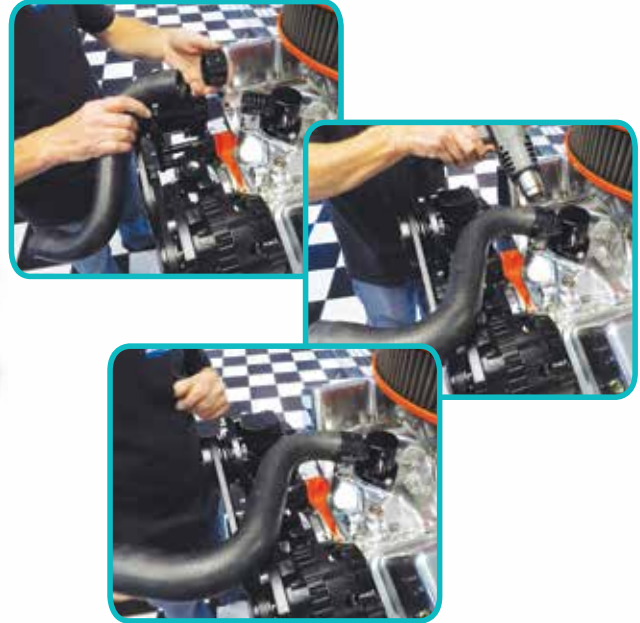

MS106-55	1/4" I.D. X 1/2"-11/16" Hose O.D.	MS106-61	1" I.D. X 1 3/8"-1 1/2" Hose O.D.
MS106-56	3/8" I.D. X 11/16"-13/16" Hose O.D.	MS106-62	1 1/4" I.D. X 1 1/2"-1 3/4" Hose O.D.
MS106-57	1/2" I.D. X 13/16"-15/16" Hose O.D.	MS106-63	1 1/2" I.D. X 1 3/4"-2" Hose O.D.
MS106-58	5/8" I.D. X 15/16"-1 1/16" Hose O.D.	MS106-64	1 3/4" I.D. X 2"-2 1/4" Hose O.D.
MS106-59	3/4" I.D. X 1 1/8"-1 3/16" Hose O.D.	MS106-65	2" I.D. X 2 1/4"-2 1/2" Hose O.D.
MS106-60	7/8" I.D. X 1 3/8"-1 3/16" Hose O.D.		

Hose Fittings

We stock a multitude of fittings in chrome brass and we manufacture our own billet aluminum and stainless steel fittings to help simplify and enhance your hot rod's plumbing.



Chrome Brass 90° Fittings ⚠️

MS115-1438-90	1/4 NPT - 3/8 Hose
MS115-3838-90	3/8 NPT - 3/8 Hose
MS115-3812-90	3/8 NPT - 1/2 Hose
MS115-3858-90	3/8 NPT-5/8 Hose
MS115-1238-90	1/2 NPT-3/8 Hose
MS115-1212-90	1/2 NPT-1/2 Hose
MS115-1258-90	1/2 NPT-5/8 Hose
MS115-1234-90	1/2 NPT-3/4 Hose



Chrome Brass Straight Fittings ⚠️

MS115-1438	1/4 NPT - 3/8 Hose
MS115-3838	3/8 NPT - 3/8 Hose
MS115-3812	3/8 NPT - 1/2 Hose
MS115-3858	3/8 NPT-5/8 Hose
MS115-1238	1/2 NPT-3/8 Hose
MS115-1212	1/2 NPT-1/2 Hose
MS115-1258	1/2 NPT-5/8 Hose
MS115-1234	1/2 NPT-3/4 Hose

MS149-20XX



Small Billet Scissor Hinges ⚠️

Measure 3 1/2" X 3 1/2" in collapsed position and 7" fully open "

- MS149-20M Machined
- MS149-20P Polished
- MS149-20XX Specify Color

MS149-21XX



Large Billet Scissor Hinges ⚠️

Measure 6" X 6" in collapsed position and 12" fully open"

- MS149-21M Machined
- MS149-21P Polished
- MS149-21XX Specify Color

Aluminum Hidden Hinge



MS149-12P

MS149-13P

Aluminum Hidden Hinge (Long) ⚠️

Aluminum long hidden hinges. Can be used in various applications. Measures 5" outside X 2 1/4" inside. Sold in pairs.

- MS149-13P Polished
- MS149-13XX Specify Color

Aluminum Hidden Hinge (Short) ⚠️

Aluminum short hidden hinges. Can be used in various applications. Measures 2 7/8" outside X 2 1/8" inside. Sold in pairs.

- MS149-12P Polished
- MS149-12XX Specify Color

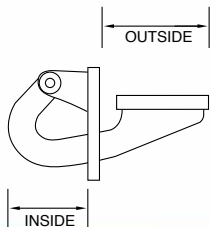

Warner Linear Actuators

Eddie Motorsports sells a variety of 12 volt linear actuators and accessories.

Heavy Duty Actuators ⚠️

500lb lifting capacity, available in three sizes

- MS302-01W 18" stroke, 24" long in closed position
- MS302-02W 24" stroke, 30" long in closed position

***Note: All sales are final on any and all electrical items.**



Actuator Accessories ⚠️

- MS302-08 Heavy Duty Actuator mounting brackets (sold individually)
- MS302-07SS Stainless steel quick release actuator pin
- MS302-33 Forward-Reverse relay- allows the use of a single pole switch to operate actuators

***Note: All sales are final on any and all electrical items.**

HALO TOURING

Halo Touring Series Seat ⚠

Designed with mild bolstering, thinner bottom and backrest for tighter cabin spaces and Pickup truck application fitsments.

- Reclines to full layback position
- Manual adjustable lumbar are a standard option
- Sliders with a center release bar
- Mild Bolstering for easy access
- Engineered leather seating surface with matching vinyl sides and back

MS700-10XX Touring Series Seat with Wheel Style Cover

MS700-20XX Touring Series Seat with Aircraft Style Cover



**See page 29 for seat options and other additional information.

HALO GT

Halo GT Series Seat ⚠

Designed with enhanced bolstering, for to hold in place during spirited driving.

- Reclines to full layback position
- Manual adjustable lumbar
- Sliders with center releasing bar
- Engineered leather seating surface with matching vinyl side and back.

MS700-30XX GT Series Seat with Wheel Style Cover

MS700-40XX GT Series Seat with Aircraft Style Cover



**See page 29 for seat options and other additional information.

*Specify color of billet components when ordering: **P**=Bright Polished **BA**=Gloss Black Anodized **HL**= Highlight **BK**=Gloss Black **CA**=Clear Anodized **CL**=Protective Clear Coat **MB**=Matte Black **B**=Blue **R**=Red **W**=White **CK**=Cerakote



HALO T-60

Halo T-60 Bench Seat

• T-60 utilizes the similar bolster heights as the Touring Bucket seat for ease of access. Lumbar feature not available for this model.

• Billet cup holders as well as billet seat components.

MS700-50XX Touring Series Seat with Wheel Style Cover

MS700-60XX Touring Series Seat with Aircraft Style Cover

T-60 Bench Seat colors, Blue, Saddle, Tan, Red, Grey, and Black



HALO EVO-60

Halo EVO-60 Bench Seat

EVO-60 utilizes the similar bolster heights as the Touring Bucket seat for ease of access.

- Fold down armrest with Billet cupholders
- Bottom seat storage compartment
- Billet components on sides and storage compartment.



Billet cup holders in the armrest fold down.



Bottom seat storage compartment



MS700-70XX

EVO-60 Bench with Wheel Style Cover

MS700-80XX

EVO-60 Bench with Aircraft Style Cover

Halo Seat Additional Info and Options

All Halo Seats and Benches come with the following

- High density molded foam
- Grey french stitching
- Manual Lumbar Control (excluding T-60 Bench)
- Elastic belts that support backs and bottoms
- Powdercoated black frames
- Billet components are available in Wheel Style or Aircraft Style



◀ Grey French Stitching

Manual Lumbar Controls ▶



◀ Billet components ▶



Wheel Style

Elastic Tension Belts ▶ Support Backs & Bottoms



▶ Powdercoated Black Frames ▶

*Available in seven different finishes, including Highlight

Eddie Motorsports Billet Aluminum Hood Hinges

Eddie Motorsports' billet aluminum hood hinges are CNC machined to perfection in the USA from high quality 6061-T6 billet aluminum. Our hinges provide a stunning alternative to your car's unsightly stock stamped steel hinges and springs. Enhanced by nitrogen filled gas struts and sealed bearings, Eddie Motorsports' hinges give your hood outstanding stability and flawless operation that is simply not possible with 40-50 year old stock hinges. Eddie Motorsports is the world's largest manufacturer of billet aluminum hood hinges. We have the biggest selection of hinges for muscle cars and trucks in the industry and the widest range of custom finish options.

Hood Hinge Finishes

For the ultimate show quality part, Eddie Motorsports offers hinges with seven different *standard finishes and four additional **special finishes. Hinge kits come complete with bright polished stainless steel struts and fasteners. All black finishes come with black struts and stainless steel fasteners.



Polished / Polished ▲
with Clear Coat

NOW AVAILABLE IN
Red, Blue, White, and
CERAKOTE™

**Special finishes



Cerakote ▲



Red ▲



Blue ▲



White ▲

*Standard finishes



▲ Machined

▲ Polished / Clear Coat

▲ Clear Anodized

▲ Gloss Black / Anodized

▲ Matte Black



Kinetic Hood Hinges

Kinetic hood hinges are available for most existing Eddie Motorsports car and truck fits. Bring your ride to the next level. Using the same T-6061 as the aerospace industry, these hinges are strong enough for anything from your daily ride to your weekend cruiser. The precision cut accent windows are sure to bring any engine compartment up a notch. Each pivot point gets a smooth sealed bearing and nitrogen charged strut to aid in popping that hood at your next meet or Show n Shine. Increased adjustability means body lines you can be proud of.

KINETIC



Polished / Clear Coat ▲



*All black hood hinges come with black struts.

*Everything else comes with polished struts.



▲ 67-72 Chevy Truck

▲ 67-69 Camaro

▲ 58-59 Chevy Truck

▲ 64-66 Mustang

▲ 57 Chevy Car

*Available in other fits.

Billet Aluminum Hood Hinges

Eddie Motorsports hood hinges are not only of the highest quality, but are a great value as well. Our hood hinges are sold in pairs and come complete with the nitrogen gas struts and all of the necessary stainless steel mounting hardware. Our hinges are available in machined or a polished finish, as well as a variety of Fusioncoat and anodized colors.

Lightning Hood Hinges

The Lightning series includes a custom machined window design for the enthusiast who's looking for a more elaborate look for his or her application. Now available in all finishes.



MS148-55BA



MS148-50P

1967-1969 CAMARO* ⚠		1963-1964 IMPALA ⚠		1964-1967 GTO ⚠	
MS148-50M	Machined	MS148-42M	Machined	MS148-36M	Machined
MS148-50P	Polished	MS148-42P	Polished	MS148-36P	Polished
MS148-50XX	Specify Color	MS148-42XX	Specify Color	MS148-36XX	Specify Color
1964 CHEVELLE ⚠		1965-1967 IMPALA ⚠		1964-1967 CUTLASS ⚠	
MS148-56M	Machined	MS148-43M	Machined	MS148-46M	Machined
MS148-56P	Polished	MS148-43P	Polished	MS148-46P	Polished
MS148-56XX	Specify Color	MS148-43XX	Specify Color	MS148-46XX	Specify Color
1965-1967 CHEVELLE ⚠		1967-1969 FIREBIRD* ⚠			
MS148-55M	Machined	MS148-51M	Machined		
MS148-55P	Polished	MS148-51P	Polished		
MS148-55XX	Specify Color	MS148-51XX	Specify Color		

*Hinges will not clear 11" brake boosters.



*Specify color when ordering: **P**=Bright Polished **M**=Raw Machined **BA**=Gloss Black Anodized

BK=Gloss Black **CA**=Clear Anodized **CL**=Protective Clear Coat **MB**=Matte Black **B**=Blue **R**=Red **W**=White **CK**=Cerakote



Stainless Steel Gas Struts

The stainless steel nitrogen filled gas struts that we use on our hinges are of the highest quality for years of uncompromised performance. They are available in various strengths to accommodate a wide variety of hood weights. All of our hinges are supplied with a strut that we have predetermined, through our R&D process, to be the correct pressure rating. In cases where your application is different or unusual, notify us and we will be happy to supply you with the appropriate strut for your use. See page 45 for a complete listing of our struts.



MS149-52P



MS149-50P



MS147-50MB

MS149-76



1967-1969 CAMARO* ⚠

MS149-50XX Specify Color
MS147-50XX Kinetic -Specify Color

1970-1981 CAMARO ⚠

MS149-52M Machined
MS149-52P Polished
MS149-52XX Specify Color

1967-1969 FIREBIRD* ⚠

MS149-51XX Specify Color
MS147-51XX Kinetic -Specify Color

1970-1981 FIREBIRD ⚠

MS149-39M Machined
MS149-39P Polished
MS149-39XX Specify Color

1982-1992 CAMARO ⚠

MS149-76M Machined
MS149-76P Polished
MS149-76XX Specify Color

*Hinges will not clear 11" brake boosters.

*Specify color when ordering: **P**=Bright Polished **M**=Raw Machined **BA**=Gloss Black Anodized
BK=Gloss Black **CA**=Clear Anodized **CL**=Protective Clear Coat **MB**=Matte Black **B**=Blue **R**=Red **W**=White **CK**=Cerakote





CHEVELLE / MONTE CARLO / EL CAMINO BILLET HOOD HINGES

1964 CHEVELLE** ⚠️

- MS149-56XX Specify Color
- MS147-56XX Kinetic Specify Color

1965-1967 CHEVELLE** ⚠️

- MS149-55XX Specify Color
- MS147-55XX Kinetic Specify Color

1969-1972 CHEVELLE / EL CAMINO ⚠️

- MS149-57XX Specify Color
- MS147-57XX Kinetic Specify Color

1968 CHEVELLE*** ⚠️

- MS149-58XX Specify Color
- MS147-58XX Kinetic Specify Color

1970-1972 MONTE CARLO ⚠️

- MS149-47XX Specify Color
- MS147-47XX Kinetic Specify Color

** Does not clear the factory A/C box

***Many 1968 Chevelle aftermarket hoods require the use of 1969 Chevelle hood hinges. Verify the center to center measurement of the hood plate mounting bolts on your hood before ordering. Stock '68 Chevilles are 12 1/4," '68 Chevelle aftermarket hoods are 14 3/4".

*Specify color when ordering: **P**=Bright Polished **M**=Raw Machined **BA**=Gloss Black Anodized

BK=Gloss Black **CA**=Clear Anodized **CL**=Protective Clear Coat **MB**=Matte Black **B**=Blue **R**=Red **W**=White **CK**=Cerakote

TRI-FIVE 55-57 CHEVY BILLET HOOD HINGES

NOTE: Kits come standard with struts for a stock steel hood. If your vehicle has something other than a stock steel hood, when purchasing, specify in the order notes what type of hood you are using: aftermarket steel, fiberglass, or carbon fiber or if the hood has been modified in any way.



1955-1956 CHEVY ⚠️

MS149-30XX Specify Color
MS147-30XX Kinetic Specify Color



1957 CHEVY ⚠️

MS149-31XX Specify Color
MS147-31XX Kinetic Specify Color

*Specify color when ordering: **P**=Bright Polished **M**=Raw Machined **BA**=Gloss Black Anodized **BK**=Gloss Black **CA**=Clear Anodized **CL**=Protective Clear Coat **MB**=Matte Black **B**=Blue **R**=Red **W**=White **CK**=Cerakote

NOVA BILLET HOOD HINGES

Our Nova hinges no longer require cutting of your car's fender panels for installation. We also have Nova hinges that will work with aftermarket front clips and, in most cases, require no modification.

1963-1965 NOVA ⚠️

Will work on Novas with either stock suspension or aftermarket front suspension clips (may require slight relieving of clip's support tube for clearance).

MS149-40XX SpecifyColor
MS147-40XX Kinetic SpecifyColor

*Hinges will not clear 11" brake boosters.



MS149-40P



MS149-40MB



MS149-53MB

MS149-53P

1966-1967 NOVA ⚠️

For Novas with stock front suspension
MS149-53XX Specify Color
MS147-53XX Kinetic Specify Color

For Novas with aftermarket front suspension clips (may require slight relieving of clip's support tube for clearance).

MS149-38XX Specify Color
MS147-38XX Kinetic Specify Color

*Hinges will not clear 11" brake boosters.



MS149-54MB

MS147-54P

1968-1979 NOVA ⚠️

MS149-54XX Specify Color
MS147-54XX Kinetic Specify Color

*Hinges will not clear 11" brake boosters.



MS149-33P



MS149-32P



MS149-77BK



MS149-42BK



MS149-77P

IMPALA BILLET HOOD HINGES

1959-1960 IMPALA ⚠️

MS149-77XX Specify Color
MS147-77XX Kinetic Specify Color

1962 IMPALA ⚠️

MS149-33XX Specify Color
MS147-33XX Kinetic Specify Color

1965-1967 IMPALA ⚠️

MS149-43XX Spcify Color
MS147-43XX Kinetic Specify Color

1969-1970 IMPALA ⚠️

MS149-44XX Machined
MS147-44XX Kinetic
Specify Color

1961 IMPALA* ⚠️

MS149-32XX Specify Color
MS147-32XX Kinetic Specify Color

1963-1964 IMPALA ⚠️

MS149-42XX Specify Color
MS147-42XX Kinetic Specify Color

1968 IMPALA ⚠️

MS149-45XX Specify Color
MS147-45XX Kinetic Specify Color

*hinges do not clear factory heater fan or AC evaporator

*Specify color when ordering: **P**=Bright Polished **M**=Raw Machined **BA**=Gloss Black Anodized

BK=Gloss Black **CA**=Clear Anodized **CL**=Protective Clear Coat **MB**=Matte Black **B**=Blue **R**=Red **W**=White **CK**=Cerakote



CHEVY TRUCK BILLET HOOD HINGES

1947-1954 CHEVY TRUCK ⚠️

MS149-27M	Machined
MS149-27P	Polished
MS149-27XX	Color

Hinge strut kit with mounts only
(for use with stock hood hinges) ⚠️

MS148-27M	Machined
MS148-27P	Polished
MS148-27XX	Color

1955-1957 CHEVY TRUCK ⚠️

MS149-22XX	Specify Color
MS147-22XX	Kinetic Specify Color

1958-1959 CHEVY TRUCK ⚠️

MS149-26XX	Specify Color
MS147-26XX	Kinetic Specify Color



CHEVY TRUCK BILLET HOOD HINGES

1960-1966 CHEVY TRUCK ⚠️

- MS149-25M Machined
- MS149-25P Polished
- MS149-25XX Specify Color

MS149-25BK



MS149-25P



MS149-23BK



MS147-23P



MS147-23MB

1967-1972 CHEVY TRUCK ⚠️

- MS149-23XX Specify Color
- MS147-23XX Kinetic Specify Color

MS149-23P



*Specify color when ordering: **P**=Bright Polished **M**=Raw Machined **BA**=Gloss Black Anodized
BK=Gloss Black **CA**=Clear Anodized **CL**=Protective Clear Coat **MB**=Matte Black **B**=Blue **R**=Red **W**=White **CK**=Cerakote

CHEVY TRUCK BILLET HOOD HINGES



MS147-24P

MS149-24MB

MS149-24P



MS147-24L
is designed
for lowered
engine bays.

1973-1980 CHEVY TRUCK ⚠️

- MS149-24XX Specify Color
- MS147-24XX Kinetic Specify Color
- MS149-24LXX Slammed Specify Color
- MS147-24LXX Slammed Kinetic Specify Color

1981-1987 CHEVY TRUCK ⚠️

- MS149-28XX Specify Color
- MS147-28XX Kinetic Specify Color



MS149-28P



1988-1998 CHEVY TRUCK ⚠️

- MS149-29M Machined
- MS149-29P Polished
- MS149-29XX Specify Color



MS149-29P

MS149-29MB

MS149-95P



FORD TRUCK BILLET HOOD HINGES

MS149-95MB



1967-1972 FORD TRUCK ⚠️

- | | |
|------------|---------------|
| MS149-95M | Machined |
| MS149-95P | Polished |
| MS149-95XX | Specify Color |

MS149-90BK



MS149-90P



1953-1956 FORD TRUCK ⚠️

- | | |
|------------|---------------|
| MS149-90M | Machined |
| MS149-90P | Polished |
| MS149-90XX | Specify Color |

*Specify color when ordering: **P**=Bright Polished **M**=Raw Machined **BA**=Gloss Black Anodized
BK=Gloss Black **CA**=Clear Anodized **CL**=Protective Clear Coat **MB**=Matte Black **B**=Blue **R**=Red **W**=White **CK**=Cerakote

MUSTANG BILLET HOOD HINGES

1964-1966 MUSTANG ⚠️

MS149-80XX Specify Color
MS147-80XX Kinetic Specify Color



MS147-80MB

MS149-80P

MS149-82MB



MS149-82CA



MS149-81P

MS147-81MB

MS149-82P

1971-1973 MUSTANG ⚠️

MS149-82M Machined
MS149-82P Polished
MS149-82XX Specify Color



FORD BILLET HOOD HINGES

1967-1970 COUGAR ⚠️

MS149-88XX Specify Color
MS147-88XX Kinetic Specify Color

1964-1965 COMET ⚠️

MS149-85XX Specify Color
MS147-85XX Kinetic Specify Color

1964-1965 FALCON ⚠️

MS149-86XX Specify Color
MS147-86XX Kinetic Specify Color

1963-1965 FAIRLANE ⚠️

MS149-84XX Specify Color
MS147-84XX Kinetic Specify Color

1967-1970 MUSTANG ⚠️

MS149-81XX Specify Color
MS147-81XX Kinetic Specify Color



MUSTANG FOX BODY BILLET HOOD HINGES

1979-1993 FOX BODY MUSTANG ⚠️

KINETIC

MS147-83XX Specify Color

LIGHTNING

MS148-83XX Specify Color

CLASSIC

MS149-83XX Specify Color



MS149-83



MS147-83P



MS147-83MB



MS148-83MB

MS148-83P

MS149-48MB



MS147-48P

MS149-36BA



MS149-36P

PONTIAC BILLET HOOD HINGES

1964-1967 GTO Le Mans ⚠️

MS149-36XX Specify Color

MS147-36XX Kinetic

Specify Color

1968-1979

PONTIAC VENTURA ⚠️

MS149-48XX Specify Color

MS147-48XX Kinetic

Specify Color

1969-1972 GTO Le Mans ⚠️

MS149-59XX Specify Color

MS147-59XX Kinetic

Specify Color

MS149-59CA



*Specify color when ordering: **P**=Bright Polished **M**=Raw Machined **BA**=Gloss Black Anodized

BK=Gloss Black **CA**=Clear Anodized **CL**=Protective Clear Coat **MB**=Matte Black **B**=Blue **R**=Red **W**=White **CK**=Cerakote



MOPAR BILLET HOOD HINGES 1967-1970 Mopar B Body, Dodge Coronet, Super Bee Dodge Charger, Roadrunner, GTX ⚠️

MS149-70M Machined
MS149-70P Polished
MS149-70XX Specify Color



MS149-70P



MS149-70CA

MS149-70MB

G-BODY BILLET HOOD HINGES



MS149-75BK



MS149-75P

G-Body ⚠️

Available for these popular applications: Buick; Century 78-81 / Grand National 78-87 / Regal 78-87 / Riviera 77-78, Olds 78-87 Cutlass, Chevy 78-88 El Camino / 78-88 Malibu, Pontiac 82-86 Bonneville, and 84-88 Monte Carlo.

MS149-75M Machined
MS149-75P Polished
MS149-75XX Specify Color



MS149-74BK



MS149-74P



MS149-73P

OLDSMOBILE BILLET HOOD HINGES 1964-1967 Oldsmobile Cutlass ⚠️

MS149-46XX Specify Color
MS147-46XX Kinetic Specify Color

1969-1972 Oldsmobile Cutlass ⚠️

MS149-73XX Specify Color
MS147-73XX Kinetic Specify Color

AMC BILLET HOOD HINGES 1969-1974 AMC AMX/Javelin ⚠️

MS149-74M Machined
MS149-74P Polished
MS149-74XX Specify Color

*Specify color when ordering: **P**=Bright Polished **M**=Raw Machined **BA**=Gloss Black Anodized

BK=Gloss Black **CA**=Clear Anodized **CL**=Protective Clear Coat **MB**=Matte Black **B**=Blue **R**=Red **W**=White **CK**=Cerakote



Nitrogen Gas Struts

Since we first introduced our billet aluminum hood hinges in 2009, Eddie Motorsports has always used high quality, stainless steel nitrogen gas struts. We have since become the largest provider of these struts to the hot rod industry, selling thousands of units, not only for our own hinges, but for our competitor's hinges and their customers who have required an upgrade. Our large selection of available pressure ratings have made our struts desirable for achieving optimum performance from billet aluminum hood and trunk hinges.

Stainless Steel Gas Struts ⚠

Weight listed specifies the amount of force needed to begin the actuation of the strut. From the center-to-center of the mounting points, the struts measure 7 1/4" in the fully open position and 5 1/4" in the fully closed position. They are available in standard, heavy duty and for use with 10MM or 14MM ball stud mounts (sold separately). Struts are available in a stainless steel polish or a black finish and are sold individually.

Standard Stainless Steel Struts for use with 10MM ball stud mounts.

Sold individually:

MS149-60-080	Gas Strut 80 lbs	-Polished
MS149-60-080B	Gas Strut 80 lbs	-Black
MS149-60-112	Gas Strut 112 lbs	-Polished
MS149-60-168	Gas Strut 168 lbs	-Polished
MS149-60-168B	Gas Strut 168 lbs	-Black
MS149-60-236	Gas Strut 236 lbs	-Polished
MS149-60-236B	Gas Strut 236 lbs	-Black
MS149-60-265	Gas Strut 265 lbs	-Polished
MS149-60-265B	Gas Strut 265 lbs	-Black

Heavy Duty Stainless Steel Struts for use with 14MM ball stud mounts.

Sold individually:

MS149-65-300	Gas Strut 300 lbs	-Polished
MS149-65-300B	Gas Strut 300 lbs	-Black
MS149-65-360	Gas Strut 360 lbs	-Polished
MS149-65-360B	Gas Strut 360 lbs	-Black
MS149-65-400	Gas Strut 400 lbs	-Polished
MS149-65-400B	Gas Strut 400 lbs	-Black
MS149-65-460	Gas Strut 460 lbs	-Polished
MS149-65-460B	Gas Strut 460 lbs	-Black
MS149-65-500	Gas Strut 500 lbs	-Polished
MS149-65-500B	Gas Strut 500 lbs	-Black



Black Steel Struts for use with 10MM ball stud mounts. Sold individually: ⚠

MS149-60-168B Gas Strut 168 lbs

Black Steel Struts for use with 10MM ball stud mounts. These struts measure 12 1/2" in the fully open position and 8" in the fully closed position. Sold individually: ⚠

MS149-67 Gas Strut Long 168 lbs

Stainless Steel Struts for use with 10MM ball stud mounts. These struts measure 17" in the fully open position and 10" in the fully closed position: ⚠

MS149-63-060	Gas Strut 60 lbs
MS149-63-080	Gas Strut 80 lbs
MS149-63-120	Gas Strut 120 lbs

Black Steel Struts for use with 10MM ball stud mounts. These struts measure 17 1/4" in the fully open position and 7 1/4" in the fully closed position. Sold individually: ⚠

MS149-62-30	Gas Strut 30 lbs
MS149-62-60	Gas Strut 60 lbs

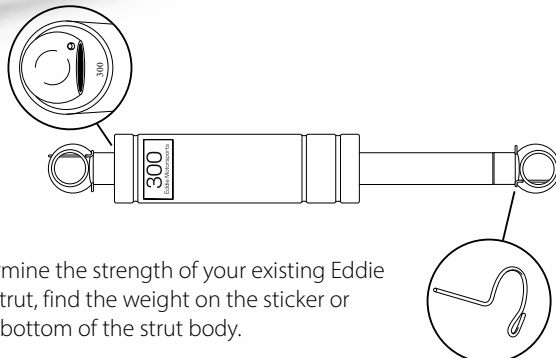

Note: To determine the strength of your existing Eddie Motorsports strut, find the weight on the sticker or etched in the bottom of the strut body.



Strut Accessories ⚠

MS149-61	Replacement Ball Stud Mount 10MM X 5/16-18 threads
MS149-66	Replacement Ball Stud Mount 14MM X 5/16-18 threads
MS149-63	Replacement Pin Clip Struts using 10MM Ball Mount
MS149-64	Replacement Pin Clip Struts using 14MM Ball Mount

Billet Trunk Hinges

The trunk is probably the last thing most people think of when customizing their classic cars. But, Eddie Motorsports leaves no stone unturned when it comes to upgrading your ride. Our high quality aluminum hinges are CNC machined to perfection from a solid piece of aluminum and can vastly improve the look of your trunk compartment. Unless otherwise noted, our trunk hinges utilize nitrogen filled gas shocks and high quality Delrin bushings for a smooth reliable operation that is far superior to that of the stock hinges and their less-than-precise torsional springs. Designed as direct fit, "bolt on" parts, the hinges use the stock mounting holes (some minor drilling for the shock mount may be required). Sold in pairs.



1955-1957 CHEVY BEL AIR

Two door hard top and convertible ⚠️

MS149-15M	Machined
MS149-15P	Polished
MS149-15XX	Specify Color

Two door post and all four doors ⚠️

MS149-16M	Machined
MS149-16P	Polished
MS149-16XX	Specify Color



1967-1969 CAMARO/FIREBIRD

MS149-05M	Machined
MS149-05P	Polished
MS149-05XX	Specify Color

*Trunk hinges will not work on convertibles or cars equipped with wheel tubs.



1970-1981

CAMARO FIREBIRD

Models offered with or without nitrogen strut for ease of operation. Models without strut work with the stock torsion springs. Strut kit only can be used with stock trunk hinges.

MS149-06M	Machined NO Strut Kit
MS149-06P	Polished NO Strut Kit
MS149-06XX	Color NO Strut Kit
MS148-06M	Machined with Strut Kit
MS148-06P	Polished with Strut Kit
MS148-06XX	Color with Strut Kit
MS148-07M	Strut Kit Only Machined
MS148-07P	Strut Kit Only Polished
MS148-07XX	Strut Kit Only Color



1960-1962 IMPALA

Universal kit that will require you to determine the correct strut bracket placement for your car.

MS149-18M	Machined
MS149-18P	Polished
MS149-18XX	Specify Color

1963-1964 IMPALA

MS149-17M	Machined ⚠️
MS149-17P	Polished
MS149-17XX	Specify Color

Unless otherwise noted, hinges will not work on convertibles or cars equipped with wheel tubs.

*Specify color when ordering: **P**=Bright Polished **M**=Raw Machined **BA**=Gloss Black Anodized

BK=Gloss Black **CA**=Clear Anodized **CL**=Protective Clear Coat **MB**=Matte Black **B**=Blue **R**=Red **W**=White **CK**=Cerakote





BILLET TRUNK HINGES
1964-1965 CHEVELLE/
GTO/LEMANS/TEMPEST ⚠️
 MS149-08M Machined
 MS149-08P Polished
 MS149-08XX Specify Color

1966-1967 CHEVELLE/
GTO/LEMANS/TEMPEST ⚠️
 MS149-09M Machined
 MS149-09P Polished
 MS149-09XX Specify Color

1968-1972 CHEVELLE/
MONTE CARLO/ GTO/
LEMANS/TEMPEST ⚠️
 MS149-10M Machined
 MS149-10P Polished
 MS149-10XX Specify Color

*Trunk hinges will not work on convertibles or cars equipped with wheel tubs.



BILLET TRUNK HINGES
1962-1965 NOVA ⚠️
 MS149-11M Machined
 MS149-11P Polished
 MS149-11XX Specify Color

1966-1967 NOVA ⚠️
 MS149-04M Machined
 MS149-04P Polished
 MS149-04XX Specify Color

*Trunk hinges will not work on convertibles or cars equipped with wheel tubs.



1965-1966 MUSTANG ⚠️
 MS148-01M Machined
 MS148-01P Polished
 MS148-01XX Specify Color

*For Coupes only-will not work on Fastbacks
 *Trunk hinges will not work on convertibles or cars equipped with wheel tubs.

Unless otherwise noted, hinges will not work on convertibles or cars equipped with wheel tubs.

*Specify color when ordering: **P**=Bright Polished **M**=Raw Machined **BA**=Gloss Black Anodized

BK=Gloss Black **CA**=Clear Anodized **CL**=Protective Clear Coat **MB**=Matte Black **B**=Blue **R**=Red **W**=White **CK**=Cerakote

Billet Aluminum Battery Boxes for 1955-1956 Chevy Sedan ⚠️

For that final touch of class in your engine compartment, add one of our billet aluminum battery boxes for 1955-1956 Chevs. Machined from 6061-T6 billet aluminum, these kits come with stainless steel mounting fasteners and are a direct bolt on replacement for your stock stamped steel tray. They clear our billet hood hinges with no modifications necessary. Models are available for Optima D34 and R34 and Group 78 side post batteries. Our billet battery boxes are available in raw machined, bright polish finishes as well as a variety of Fusioncoated colors and anodized colors.



MS374-50M	Group 78 Machined
MS374-50P	Group 78 Polished
MS374-50XX	Group 78 Color
MS374-55M	Optima Machined
MS374-55P	Optima Polished
MS374-55XX	Optima Specify Color



Tri-Five 55-57 Chevy Billet Hood Hinges

Eddie Motorsports hood hinges are not only of the highest quality, but are a great value as well. Our hood hinges are sold in pairs and come complete with the nitrogen gas struts and all of the necessary stainless steel mounting hardware. Our hinges are available in machined, polished, or chrome finish as well as a variety of Fusioncoat and anodized colors. **See page 37 for more details.**

1955-1956 Chevy ⚠️

MS149-30XX	Specify Color
MS147-30XX	Kinetic Specify Color

1957 Chevy ⚠️

MS149-31XX	Specify Color
MS147-31XX	Kinetic Specify Color

1955-1957 Chevy Sedan Billet Door Sill Plates ⚠️

We didn't take any short cuts in manufacturing our billet aluminum sill plates. They are completely machined out of a solid piece of aluminum. We didn't quickly machine or bend a thin sheet to produce our plates. Fits two door models only. Door sills will not fit four door models. Sold in pairs and available in a variety of finishes.



MS274-25M	Machined
MS274-25P	Polished
MS274-25XX	Specify Color

*Specify color when ordering: **P**=Bright Polished **M**=Raw Machined **BA**=Gloss Black Anodized **BK**=Gloss Black **CA**=Clear Anodized **CL**=Protective Clear Coat **MB**=Matte Black **B**=Blue **R**=Red **W**=White **CK**=Cerakote

Billet Hood Brace

Our billet CNC machined hood braces, supports, and latch assemblies for 1955-1957 Chevy Sedans are a must for today's Restomod builds. At Eddie Motorsports we are constantly developing custom products and offering them at an affordable price. Our billet under-hood pieces certainly hit this mark. When you combine these parts with a set of our billet hood hinges, you car's engine compartment appeal will be stunning. Installation for these direct replacement parts will require drilling out the rivets that hold the stock stamped-steel braces. They will be replaced by the new stainless steel fasteners. Will not clear stock radiator hose on six cylinder applications.



1955 Hood Brace ⚠️

MS274-30M Machined
MS274-30P Polished
MS274-30XX Specify Color

1956 Hood Brace ⚠️

MS274-31M Machined
MS274-31P Polished
MS274-31XX Specify Color

1957 Hood Brace ⚠️

MS274-32M Machined
MS274-32P Polished
MS274-32XX Specify Color



Billet Hood Brace Supports ⚠️

Use these in conjunction with our billet hood braces (may not work with stock braces).
Sold in pairs.

1955 Chevy Supports ⚠️

MS274-35M Machined
MS274-35P Polished
MS274-35XX Specify Color

1956 Chevy Supports ⚠️

MS274-36M Machined
MS274-36P Polished
MS274-36XX Specify Color

1957 Chevy Supports ⚠️

MS274-37M Machined
MS274-37P Polished
MS274-37XX Specify Color



Billet Hood Latch and Support ⚠️

This two piece billet aluminum assembly is a direct replacement for the stock latch and support. It includes new stainless steel fasteners.

1955 Hood Latch and Support ⚠️

MS274-40M Machined
MS274-40P Polished
MS274-40XX Specify Color

1956 Hood Latch and Support ⚠️

MS274-41M Machined
MS274-41P Polished
MS274-41XX Specify Color

1957 Hood Latch and Support ⚠️

MS274-42M Machined
MS274-42P Polished
MS274-42XX Specify Color

1955-57 Hood Latch Plate Only ⚠️

MS274-43M Machined
MS274-43P Polished
MS274-43XX Specify Color



Billet Aluminum Camaro SS Hood Vents

Upgrade your pot metal ice cube trays with these billet aluminum vents. Machined from solid chunks of 6061-T6 aluminum, the two piece assembly includes an aluminum mesh screen (the vents are non-functional without any openings). Available for 1st generation Camaros, the vents can be purchased in raw machined or bright polished finish as well as a variety of our Fusioncoated or anodized colors.

1967-69 Camaro ⚠️

MS275-20M	Machined
MS275-20P	Polished
MS275-20XX	Specify Color



Lightning Series

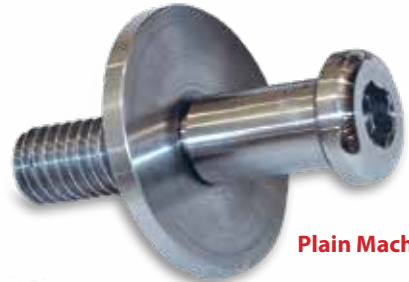

Plain Machined

Stainless Steel Hood Adjusters

Machined completely from stainless steel (will not rust or corrode). Two styles to choose from, our original model and new Lightning series with a more elaborate custom machined adjusting nut. Check your existing hood adjusters for the correct size. Sold individually.

Original Hood Stop ⚠️

MS275-37	1/4" Machined
MS275-37P	1/4" Polished
MS275-38	5/16" Machined
MS275-38P	5/16" Polished
MS275-39	7/16" Machined
MS275-39P	7/16" Polished

Lightning Series ⚠️

MS275-15M	1/4" Machined
MS275-15P	1/4" Polished
MS275-16M	5/16" Machined
MS275-16P	5/16" Polished
MS275-17M	7/16" Machined
MS275-17P	7/16" Polished



Accent Dimples

Stainless Steel Door Striker Bolts ⚠️

Replace your plain steel strikers with these attractive stainless steel parts. Strikers have 7/16-14 threads and fit most popular GM muscle cars. Available with plain or accented washers and in a raw machined or highly polished finish. Sold in pairs.

MS277-20M	Plain Machined
MS277-20P	Plain Polished
MS277-21M	Accent Dimples Machined
MS277-21P	Accent Dimples Polished

Specify finish when ordering **M**= Machined • **P** = Polished • **XX** = Color

Billet Aluminum Door Sill Plates

We didn't take any short cuts in manufacturing our billet aluminum sill plates. They are completely CNC machined out of a solid piece of billet aluminum. We didn't quickly machine or bend a thin sheet to produce our plates. With our precision machining, you get a part that fits perfectly every time. Our sill plates are available in a raw machined or highly polished finish as well as a variety of Fusioncoated and anodized colors. Sold in pairs.



1967-1969

Camaro & Firebird

MS275-35M	Machined
MS275-35P	Polished
MS275-35XX	Specify Color

1970-1981

Camaro & Firebird

MS275-95M	Machined
MS275-95P	Polished
MS275-95XX	Specify Color

1964-1967 Chevelle /El Camino

MS275-96M	Machined
MS275-96P	Polished
MS275-96XX	Specify Color

*Also fits 1964-1967 GTO, LeMans, Tempest, Cutlass, Skylark

1968-1972 Chevelle/El Camino

MS275-97M	Machined
MS275-97P	Polished
MS275-97XX	Specify Color

*Also fits 1968-1972 GTO, LeMans, Tempest, Cutlass, Skylark, 1970-1972 Monte Carlo, 1969-1972 Grand Prix

1970-1981 Camaro Cowl Vent

One of our new products, this one piece precision CNC billet aluminum cowl vent assembly is designed to replace the stock plastic covers. It includes aluminum mesh inserts and stainless steel fasteners. Some drilling is required. Available in satin or bright polished finish as well as a variety of Fusioncoat and anodized finishes.



MS275-70M	Machined
MS275-70P	Polished
MS275-70XX	Specify Color



1967-68 Camaro

Billet Gas Cap

Our gas caps are CNC machined to perfection. They are available engraved with an RS, SS, or plain center on the cap. Our gas caps are available in machined, polished, or in a variety of colors.



Plain

MS275-32XX Specify Color



RS

MS275-33XX Specify Color



SS

MS275-34XX Specify Color



LS

MS275-01XX Specify Color

*Specify color when ordering: **P**=Bright Polished **M**=Raw Machined **BA**=Gloss Black Anodized

BK=Gloss Black **CA**=Clear Anodized **CL**=Protective Clear Coat **MB**=Matte Black **B**=Blue **R**=Red **W**=White **CK**=Cerakote

Billet Taillight Bezels and Lenses

Our billet tail light bezels are CNC machined from a solid piece of aluminum. Our light bezels are available in standard and RS versions and are machined to factory size which enables you to use your existing light housings. Our 1967-68 Camaro tail light bezels also utilize the stock lenses (sold separately) or you can upgrade to one of our tail light kits that include new LED lights. Our 1969 Camaro tail lights come with new red lenses and are available with or without backup lights. Our tail light bezels are sold in pairs and are available in machined, polished, powder coated or anodized finishes.



1969 Standard Taillight Bezel & Lenses ⚠️

MS275-44XX Specify Color



1969 Standard Taillight Bezel & Lenses with Backup Light ⚠️

MS275-46XX Specify Color



1969 RS Taillight Bezel & Lenses ⚠️

MS275-45XX Specify Color



1969 Solid Panel Taillight Bezel & Lenses ⚠️

MS275-43XX Specify Color



LED Kits

Bezel Only

1967-1968 RS Taillight Bezels Only ⚠️

MS275-40XX Specify Color

1967-1968 RS Taillight Kit with LED's ⚠️

MS275-40KM Machined
MS275-40KP Polished
MS275-40KXX Specify Color



LED Kits

Bezel Only

1967-1968 Standard Taillight Bezels Only ⚠️

MS275-42XX Specify Color

1967-1968 Standard Taillight Kit with LED's ⚠️

MS275-42KM Machined
MS275-42KP Polished
MS275-42KXX Specify Color

*Specify color when ordering: **P**=Bright Polished **M**=Raw Machined **BA**=Gloss Black Anodized

BK=Gloss Black **CA**=Clear Anodized **CL**=Protective Clear Coat **MB**=Matte Black **B**=Blue **R**=Red **W**=White **CK**=Cerakote





Billet Taillight Bezels 1966-1967 Nova

Precision CNC machined from billet aluminum, these bezels come with stainless steel fasteners and gaskets. Kits are also available, complete with LED lights, three styles to choose from. Bezels are available in a variety of finishes. Sold in pairs.

Taillight Bezels Only ⚠️

(must use with aftermarket LED lights)

MS275-48M	Machined
MS275-48P	Polished
MS275-48XX	Specify Color

Tail light Kit with Bezels, LED Taillights and Backup Lights, and Flasher ⚠️

MS275-48KM	Machined
MS275-48KP	Polished
MS275-48KXX	Specify Color

Tail light Kit with Bezels, One Piece LED Taillights (no backup lights), and Flashers ⚠️

MS275-41M	Machined
MS275-41P	Polished
MS275-41XX	Specify Color

Tail light Kit with Bezels, One Piece Sequential LED Taillights (no backup lights), and Flashers ⚠️

MS275-41SM	Machined
MS275-41SP	Polished
MS275-41SXX	Specify Color



Billet Headlight Bezels 1969 Camaro

Dress-up the headlights on your 1969 Camaro with a pair of our new bezels. Precision CNC machined from 6061 aluminum, we offer the bezels in two different styles and in a variety of finishes. Sold in pairs. Some drilling required for installation.

Smooth Style ⚠️

MS275-68M	Machined
MS275-68P	Polished
MS275-68XX	Specify Color

Accent Style ⚠️

MS275-69M	Machined
MS275-69P	Polished
MS275-69XX	Specify Color

Camaro/Nova/El Camino Billet Side Marker Bezels

These billet aluminum bezels are a direct replacement part and include new stainless steel fasteners. Sold in pairs.



1969 Camaro ⚠️

MS275-31M	Front Machined
MS275-31P	Front Polished
MS275-31XX	Front Specify Color

MS275-47M	Rear Machined
MS275-47P	Rear Polished
MS275-47XX	Rear Specify Color



1968 Camaro/1968-1969 Nova 1968-1969 El Camino ⚠️

Works in front or rear.

MS275-36M	Machined
MS275-36P	Polished
MS275-36XX	Specify Color

*Specify color when ordering: **P**=Bright Polished **M**=Raw Machined **BA**=Gloss Black Anodized

BK=Gloss Black **CA**=Clear Anodized **CL**=Protective Clear Coat **MB**=Matte Black **B**=Blue **R**=Red **W**=White **CK**=Cerakote

Camaro, Firebird and Nova Fender Braces

At Eddie Motorsports, we realize that everybody has different tastes and requirements, that's why we manufacture three different types of Camaro fender braces. Our newest offering is our Billet Aluminum fender braces. Machined completely from the highest quality 6061-T6 aluminum, the new braces feature a race-inspired windowed design and can be customized to fit your build style with our optional aluminum inserts. 1970-1981 Camaro braces are also available machined to accept our hood pins. Our billet fender braces are sold in pairs and include stainless steel fasteners. All of our fender braces are available with a raw machined or highly polished finish or in a variety of our Fusioncoated colors. Sold in pairs.



Insert Set

1967-1969 Camaro and Firebird 1968-1979 Nova

(Nova and Firebird may require some drilling)

MS275-18M	Fender Braces Machined
MS275-18P	Fender Braces Polished
MS275-18XX	Fender Braces Color
MS275-19M	Insert Set Machined
MS275-19P	Insert Set Polished
MS275-19XX	Insert Set Color

1970-1981 Camaro

(Will not fit Firebird)

MS275-13M	Fender Braces Machined
MS275-13P	Fender Braces Polished
MS275-13XX	Fender Braces Color
MS275-14M	Insert Set Machined
MS275-14P	Insert Set Polished
MS275-14XX	Insert Set Color



Billet Adjustable Fender Braces

Machined from billet aluminum. Includes all brackets, rod ends and stainless steel fasteners. Sold in pairs.

1967-1969 Camaro and Firebird

1968-1979 Nova

(Nova and Firebird may require some drilling)

MS275-22M	Machined
MS275-22P	Polished
MS275-22XX	Specify Color

1970-1981 Camaro

(will not fit Firebird)

MS275-24M	Machined
MS275-24P	Polished
MS275-24XX	Specify Color



Stainless Steel Fender Braces

OEM style, direct replacement. Sold in pairs.

1967-1969 Camaro and Firebird

1968-1979 Nova

(Nova and Firebird may require some drilling)

MS291-04P	Polished
MS291-04XX	Specify Color

1970-1981 Camaro

(Nova and Firebird may require some drilling)

MS291-05P	Polished
MS291-05XX	Specify Color

*Specify finish when ordering **M**= Machined • **P** = Polished • **XX** = Color



1967 Camaro RS Billet Grille & Headlight Covers

Yes, we machined a billet grille for the 1967 Camaro RS at an affordable price. Our three-piece grille assembly consists of two grille pieces and a center cover plate. The cover plate is available with an RS logo, SS logo or with a plain finish (specify when ordering). Billet headlight covers (sold separately) are also available and are the perfect complement. The headlight covers are sold in pairs and can also be used in conjunction with your stock plastic grille. Available in various finishes. Factory steel trim not included.



Billet Three Piece Grille

Specify finish when ordering.

- MS275-511 Grill with RS Logo
- MS275-512 Grill with SS Logo
- MS275-514 Grill with RS Logo
- MS275-513 Grill with, no Logo

Billet RS Headlight Covers

Sold in pairs

- MS275-50XX Specify Color



Installed in the factory grill filler (not included)

1970-1973 Camaro RS Billet Grille

Our three-piece grille assembly is precision CNC machined from billet aluminum and consists of two grille pieces and a center cover plate. The grille includes an aluminum mesh insert and bolts into the stock mounting points with no drilling necessary. Available in various finishes. Factory steel trim not included.

- MS275-52XX Specify Color



1967-1968 Camaro Valance Air Vents

Fill the air inlet holes on your Camaro with a set of our billet air vents. Easy mounting with no drilling. Comes with stainless steel fasteners.

NOTE: An alternate method of actuating the hood latch must be added on RS models only as the air vents interfere with access to the hood latch lever. Sold in pairs and available in a variety of finishes.



- MS275-53M Machined
- MS275-53P Polished
- MS275-53XX Specify Color

*Specify color when ordering: **P**=Bright Polished **M**=Raw Machined **BA**=Gloss Black Anodized **BK**=Gloss Black **CA**=Clear Anodized **CL**=Protective Clear Coat **MB**=Matte Black **B**=Blue **R**=Red **W**=White **CK**=Cerakote



Extinguishers and Brackets

The unique construction and function of Eddie Motorsports fire extinguisher brackets is unsurpassed by others. Over the past 10 years, these brackets have withstood thousands of miles of abuse in high performance boats and have endured flawlessly. The brackets are CNC machined out of 6061-T6 aluminum and are built to allow for mounting in any position. The round mounting cylinder fastens permanently to the extinguisher (sold separately) and is held into its base with a stainless steel aircraft quick release pin. A swift pull of the pin is all it takes for you and your very cool new fire extinguisher to be ready to save the day. The large brackets work with our 2.5lb. (3" O.D.) extinguishers. The small brackets work with our 1lb. (2 3/4" O.D.) models. The brackets are available in a machined or highly polished finish or in any of our many custom Fusioncoat colors.



Small Brackets ⚠

- MSBRK-102M Machined
- MSBRK-102P Polished
- MSBRK-102XX Color

Large Brackets ⚠

- MSBRK-103M Machined
- MSBRK-103P Polished
- MSBRK-103XX Color



Roll Bar Mount Bracket Small Extinguisher ⚠

- MSBRK-106M For 1 3/4" tubing- Machined
- MSBRK-106P For 1 3/4" tubing- Polished
- MSBRK-106XX For 1 3/4" tubing- Color

Roll Bar Mount Bracket Large Extinguisher ⚠

- MSBRK-109M For 1 3/4" tubing- Machined
- MSBRK-109P For 1 3/4" tubing- Polished
- MSBRK-109XX For 1 3/4" tubing- Color



Fire Extinguisher ⚠

Insure the fire safety of your vehicle with our 1 pound dry chemical fire extinguisher. The extinguisher carries a 2B:C rating, is 2 3/4" in diameter and 10" tall. It comes with a matching red powder coated, stamped steel mounting bracket.

Small 1 lb Extinguishers – 2 3/4" diameter, 10" tall (Dry Chemical 2B:C rated, Clean agent 1B:C)

MSEXT-107 Small 1lb Dry Chemical

*Specify finish when ordering: **M**=Brushed Satin **P**=Bright Polished

BA=Gloss Black Anodized **BK**=Gloss Black **CA**=Clear Anodized **CL**=Protective Clear Coat
MB=Matte Black **B**=Bright Blue **R**=Bright Red **W**=White **PR**=Bright Purple **CK**=Cerakote

Hood Latches

Eddie Motorsports leaves no stone unturned when it comes to dressing up your car's engine compartment. Our latest piece of custom hardware is our billet Hood Latch assemblies for Chevy muscle cars and trucks. Machined from solid chunks of 6061-T6 aluminum and 304 stainless steel, the latch assembly is a direct replacement for your cheap stock stamped steel pieces. The hood latch kit comes complete with a billet aluminum base plate, pilot bolt and retaining cup and pop-up spring (some applications). Stainless steel fasteners and billet aluminum finishing washers are also included. Available with a raw machined or highly polished finish as well as in a variety of Fusioncoated colors.



1967-81 Camaro/Firebird & 1968-69 Chevelle Hood Latch Assembly ⚠️
MS276-10XX Specify Color



1964 Chevelle Hood Latch Assembly ⚠️
MS276-19XX Specify Color

1965 Chevelle Hood Latch Assembly ⚠️
MS276-20XX Specify Color



1966 Chevelle Hood Latch Assembly ⚠️
MS276-21M Machined
MS276-21P Polished
MS276-21XX Specify Color

1967 Chevelle Hood Latch Assembly ⚠️
MS276-15M Machined
MS276-15P Polished
MS276-15XX Specify Color

1970-72 Chevelle Hood Latch Assembly ⚠️
MS276-12M Machined
MS276-12P Polished
MS276-12XX Specify Color



1967-72 Chevy C10 Truck ⚠️
MS276-05XX Specify Color

1973-80 Chevy C10 Truck ⚠️
MS276-06XX Specify Color



1963-64 Nova Hood Latch Assembly ⚠️
MS276-16M Machined
MS276-16P Polished
MS276-16XX Specify Color

1966-67 Nova Hood Latch Assembly ⚠️
MS276-17M Machined
MS276-17P Polished
MS276-17XX Specify Color

1968-74 Nova Hood Latch Assembly ⚠️
MS276-18M Machined
MS276-18P Polished
MS276-18XX Specify Color



1970-72 Monte Carlo Hood Latch Assembly ⚠️
MS276-13XX Specify Color

Billet Aluminum Hood Pins

There's nothing more frightening or potentially more damaging than a hood that's blown loose on your classic car at high speeds. Eddie Motorsports new billet aluminum hood pins will insure that this never happens to your car. The complete assemblies are CNC machined from billet 6061-T6 aluminum and, like all products produced by Eddie Motorsports, they are American made to the strictest manufacturing standards. They are fastened to the hood with four blind #8 studs and come with a billet adjuster nut and flip over pin with integral tether. Our hood pins are available in a raw machined or bright polished finish as well as black or clear anodize. Sold in pairs.



Diamond Series ⚠

- MS110-40M Machined
- MS110-40P Polished
- MS110-40XX Specify Color



Diamond Highlight Series ⚠

These are black anodized and then machined with a diamond pattern for a unique highlighted finish. Sold in pairs

- MS110-41CC Black Highlight



Through Bolt Series ⚠

- MS110-44M Machined
- MS110-44P Polished
- MS110-44XX Specify Color



Smooth Series ⚠

- MS110-45M Machined
- MS110-45P Polished
- MS110-45XX Specify Color

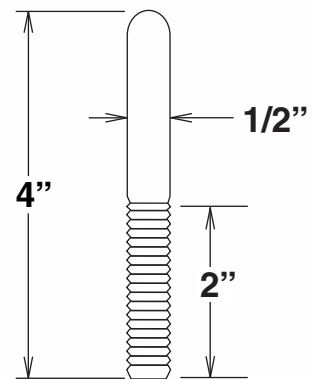
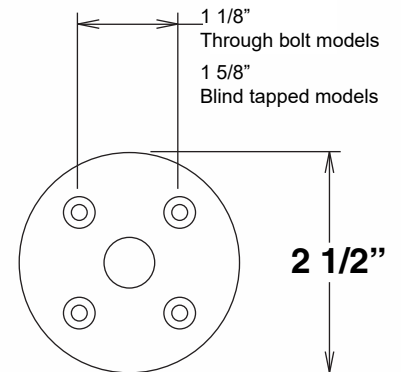

*Specify finish when ordering

M= Machined • **P** = Polished • **BA** = Gloss Black Anodize • **MB** = Matte Black Anodize • **CA** = Clear Anodize

Door Jamb Vents

Eddie Motorsports offers trick replacement parts for even the most inconspicuous items on your car. Such is the case with our billet aluminum door jamb vents. Available in raw machined or highly polished finish as well as a variety of Fusioncoated and anodized colors. Sold in pairs.



1968-1969 Camaro/Firebird

Billet door jamb vents with aluminum mesh. Sold in pairs.
MS275-25M
MS275-25P MS275-25XX



1968-1972 Chevelle/El Camino/Monte Carlo/GTO Cowl Vents

Billet aluminum cowl vents designed to replace the stock plastic covers. Includes aluminum mesh insert, mounting brackets, and stainless steel fasteners. NOT available with machined finish.

MS275-30P Polished MS275-30XX Color



1970-1973 Mustang Cowl Vents

Billet aluminum cowl vents designed to replace the stock plastic covers. Includes aluminum mesh insert, mounting brackets, and stainless steel fasteners. NOT available with machined finish.

MS275-66P Polished MS275-66XX Color



1971-1973 Mustang

These hood vents are CNC machined with a honeycomb pattern and are sold in pairs.

MS275-58M
MS275-58P
MS275-58XX



1971-1973 Mustang

These billet hood vents are CNC machined with an open honeycomb pattern. Sold in pairs.

MS275-57M
MS275-57P
MS275-57XX



1970-1992 Camaro/Firebird

Billet door jamb vents with aluminum mesh. Sold in pairs.
MS275-27M
MS275-27P MS275-27XX



1969 Chevelle & Other GM A Bodies

Billet door jamb vents with aluminum mesh. Sold in pairs.
MS275-28M
MS275-28P
MS275-28XX



1970-1981 Chevelle/Camaro/Monte Carlo/Grand Prix & All A Bodies

Billet door jamb vents with aluminum mesh. Sold in pairs.
MS275-27M
MS275-27P
MS275-27XX



1971-1972 Chevy Truck

Billet door jamb vents with aluminum mesh. One vent only.
MS275-29M
MS275-29P
MS275-29XX



1970-1973 Mustang

Billet door jamb vents with aluminum mesh. Sold in pairs.
MS275-55M
MS275-55P
MS275-55XX

M = Machined • P = Polished • XX = Color

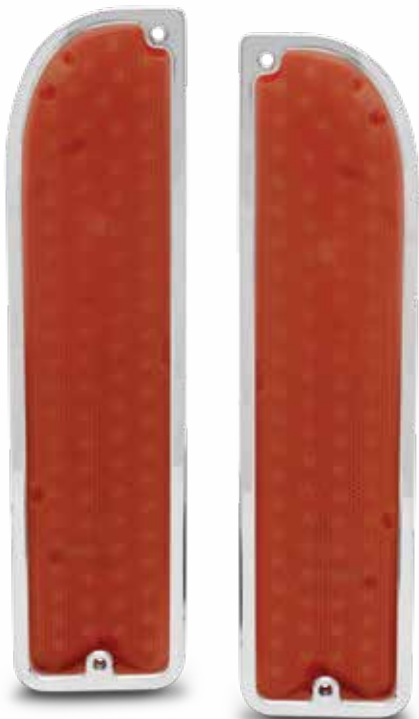

SLIM LINE
SERIES

Billet Aluminum One-Piece Taillight Kits
1967-1972 Chevy C-10 Truck ⚠️

Eddie Motorsports has designed a custom billet aluminum tail light assembly for Chevy C-10 1967-1972 trucks. These kits include precision CNC machined 6061-T6 aluminum bezels, LED tail lights, and a heavy duty LED flasher. (Does not include backup light). The kits are available in a customizable sequential operation. The sequential feature is controlled by an integrated selector switch. You have the option of having the taillights sequentially flash from inside out, outside in or simultaneously. The sequential lights also include a Brake Attention mode which, when engaged, rapidly flashes the stop light for an instance to gain the attention of motorists following your vehicle. The tail light kits are sold as a pair. Bezels are available in seven custom finishes.

- | | |
|------------|---------------|
| MS275-89M | Machined |
| MS275-89P | Polished |
| MS275-89XX | Specify Color |



Billet Aluminum Taillight Kits
1967-1972 Chevy C-10 Truck

The newest addition to Eddie Motorsport's Chevy C-10 custom billet parts is our Billet aluminum taillight assembly for 1967-1972 trucks. These kits include precision CNC machined 6061T6 aluminum bezels, LED taillights, backup light lenses and a heavy duty LED flasher. The kits are available in two versions-standard or customizable sequential operation. The sequential feature is controlled by an integrated selector switch. You have the option of having the taillights sequentially flash from inside out, outside in or simultaneously. The sequential lights also include a Brake Attention mode which, when engaged, rapidly flashes the stop light for an instance to gain the attention of motorists following your vehicle. The taillight kits are sold as a pair. Bezels are available in seven custom finishes.



Taillight Assembly with standard LED lights ⚠️

- | | |
|------------|---------------|
| MS275-85M | Machined |
| MS275-85P | Polished |
| MS275-85XX | Specify Color |

Taillight Assembly with sequential LED lights ⚠️

- | | |
|------------|---------------|
| MS275-86M | Machined |
| MS275-86P | Polished |
| MS275-86XX | Specify Color |

*Specify color when ordering: **P**=Bright Polished **M**=Raw Machined **BA**=Gloss Black Anodized

BK=Gloss Black **CA**=Clear Anodized **CL**=Protective Clear Coat **MB**=Matte Black **B**=Blue **R**=Red **W**=White **CK**=Cerakote



73-80 Chevy Trucks



81-87 Chevy Trucks



81-87 Shown painted sample.



73-80 Chevy Trucks



81-87 Chevy Trucks



▲ Vinyl wrapped sample
◀ Painted sample



▲ 73-87 Squarebody Fiberglass Door Panels (Only) ▲

MS720-30 Door Panel

Squarebody Door Panel Mesh & Billet Inserts ▲

Customize with our billet and mesh inserts. Available in Raw, Black, Red, Blue, White, Cerekote custom finishes. Sold as top and bottom sets

- MS720-31XX Mesh Inserts -Specify Color
- MS720-32XX Billet Inserts -Specify Color



Washer options available on pages 100-101.



81-87 Squarebody Inner Engine Bay Panels ▲

Available in Raw, Black, Red, Blue, White, Cerekote custom finishes.

MS240-10XX Specify Color

Billet Aluminum 67-72 & 73-80 Chevy C-10 Hood Latch assembly

We leave no stone unturned when it comes to dressing up your truck's engine compartment. These hood latches are machined from solid chunks of 6061-T6 billet aluminum. They are direct replacements for your stock stamped steel pieces. MS279-05 comes with the 304 stainless steel pilot bolt. MS265-06 plate is for C-10 with inside hood release and requires factory hood latch catch ring. They are available in seven custom finishes.



1967-1972 Hood Latch ⚠️
MS276-05XX Specify Color



1973-1980 Hood Latch ⚠️
MS276-06XX Specify Color



Billet Aluminum Sill Plates 1967-1972 Chevy C-10 Truck

Our 1967-72 Chevy C10/C20 truck billet aluminum door sill plates are both high strength quality and easy to install. We didn't take any short cuts in manufacturing our billet aluminum sill plates. They are completely machined out of a solid piece of 6061-T6 aluminum to provide a secure and long-lasting part. We didn't quickly machine or bend a thin sheet to produce our plates. With our precision machining, you get a part that perfectly fits every time. These sill plates are designed as a direct bolt-on to update the standard stamped factory plates. Sold in pairs.



MS275-94M Machined
MS275-94P Polished
MS275-94XX Specify Color



Billet Aluminum Marker Light Bezels 1967-1972 Chevy C-10 Truck

Precision CNC machined bezels. Sold in pairs and available in seven custom finishes.

MS275-87M Specify Color

Marker light kits. Includes bezels, amber LED lights, and heavy duty LED flasher. Sold in pairs.

MS275-87AXX Specify Color

Marker light kits. Includes bezels, red LED lights, and heavy duty LED flasher. Sold in pairs.

MS275-87RXX Specify Color



Mirror Adapter Plate 79-84 Chevy & GMC Trucks

Precision CNC machined from billet aluminum, these adapter plates fasten to the mounting holes of the large stock three bolt GM mirrors. They are blind hole tapped and mounted with studs (included). The plates are also drilled and tapped to accept the small 1973-87 GM mirrors (sold separately). Available in seven custom finishes. Stainless steel fasteners and gaskets are included. Sold in pairs

MS274-50XX Specify Color



Billet Aluminum Filler Neck Cover for 67-72 Chevy C-10 Trucks

This simple but convenient part covers the filler neck hole on the cab when relocating the gas tank. The kit includes a mounting bracket and stainless steel fasteners. No drilling is required. The covers are precision CNC machined from 6061T6 aluminum available in seven custom finishes.

Smooth Finish

MS265-55XX Specify Color

Ball Milled Finish

MS265-56XX Specify Color

Billet Aluminum Door Handles 1967-1987 Chevy C10 Trucks

Precision CNC machined from high quality 6061-T6 aluminum, these one piece handles are a direct replacement for your stock pot metal parts. Not only is the Eddie handle assembly stunning to look at but it is also more durable than the factory pieces which are prone to rust and pitting. Five distinct styles and eight custom finishes to choose from.



Recessed Style



Ball Milled Style



Diamond Style



Lightning Style



Smooth Style

1967-1972 Chevy C10 Trucks ⚠️

- | | |
|------------|-----------------------------|
| MS277-70 | Smooth Style |
| MS277-71 | Recessed Style |
| MS277-72 | Ball Milled Style |
| MS277-72HL | Ball Milled Highlight Style |
| MS277-73 | Lightning Style |
| MS277-74 | Diamond Hatch Cut Style |



Smooth Style



Lightning Style Matte Black



Lightning Style

1973-1986 Chevy/GMC Trucks

1973-1991 Jimmy/Blazers ⚠️

Requires the use of the stock door handle latching mechanism.

- | | |
|------------|-----------------------------|
| MS277-80 | Smooth Style |
| MS277-81 | Recessed Style |
| MS277-82 | Ball Milled Style |
| MS277-82HL | Ball Milled Highlight Style |
| MS277-83 | Lightning Style |
| MS277-84 | Diamond Hatch Cut Style |



*Both exterior door handles come with all necessary hardware.

*Specify color when ordering: **P**=Bright Polished **M**=Raw Machined **BA**=Gloss Black Anodized

BK=Gloss Black **CA**=Clear Anodized **CL**=Protective Clear Coat **MB**=Matte Black **B**=Blue **R**=Red **W**=White **CH**=Chrome **CK**=Cerakote



Billet Aluminum Door Handles

At Eddie Motorsports, we specialize in building high quality billet parts that "shine" and accent every last piece on your ride. But, we also focus on giving hot rodders the added value of products that surpass the quality and durability of the stock or cheap imported replacement components that are prevalent in the market. Such is the case with our new billet aluminum Door Handles. Machined from solid chunks of 6061-T6 aluminum, these one piece handles are a direct replacement for the stock pot metal parts. Available in five styles; original smooth, ball milled, lightning, diamond hatch cut or accent. The handles are now available chrome plated or can be purchased with a brushed satin or bright polished finish as well as a variety of Fusioncoat and anodized colors (specify when ordering) and our highlight finish- black anodized with machined highlights. The handles are sold in pairs, **include gaskets, and all necessary stainless steel fasteners.



Smooth Style



Diamond Hatch Cut Style



Lightning Style



Ball Milled Style



Smooth Style



Lightning Style



Ball Milled Highlight Style



Diamond Hatch Cut Style

1967-1969 Camaro & Firebird, 1964-1967 Chevelle, 1966-1975 Nova, 1960 Full Size Chevy ⚠

- MS277-10 Smooth Style
- MS277-18 Ball Milled Style
- MS277-23 Lightning
- MS277-25 Diamond Hatch Cut

1955-1957 Chevy 2 Door & 4 door Sedan and Wagon, Nomad, and '56-'57 4 door Hardtop ⚠

- MS277-14 Smooth Style
- MS277-22 Ball Milled Style
- MS277-24 Lightning
- MS277-26 Diamond Hatch Cut



MS277-26MB
Diamond Hatch Cut Style



** Comes with all necessary hardware.



MS277-14P
Smooth Style

*Specify color when ordering: **P**=Bright Polished **M**=Raw Machined **BA**=Gloss Black Anodized

BK=Gloss Black **CA**=Clear Anodized **CL**=Protective Clear Coat **MB**=Matte Black **B**=Blue **R**=Red **W**=White **CH**=Chrome **CK**=Cerakote



Interior Door Handles

Eddie Motorsport's new line of Billet Aluminum Door Handles and Window Cranks are both beautiful and functional. With a thicker configuration, our handles have a more solid feel than the "petite" street rod style handles that are currently available. All of the handles feature a base that is 2" to cover the upholstery cutouts from most existing OEM handles. The Eddie Motorsports Billet Aluminum Door Handles & Window Cranks feature a heavy duty aluminum 16 spline insert that is compatible with GM and Ford applications and prevents wearing out and stripping, a common occurrence with original and imported pot petal handles. The billet handles are available in four distinct styles and in a variety of custom finishes including chrome plating. Specify finish when ordering. Handles are sold in pairs.



Door Handle
Smooth Style, Polished Finish



Window Crank Handle
Smooth Style, Polished Finish



Door Handle
Diamond Style, Polished Finish



Window Crank Handle
Diamond Style, Clear Anodized Finish



Door Handle
Ball Mill Style, Gloss Black Finish



Window Crank Handle
Ball Mill Style, Clear Anodized Finish



Door Handle
Lightning Style, Matte Black Finish



Window Crank Handle
Lightning Style, Gloss Black Finish

Door Handle

5 3/4" Long

Smooth Style ⚠️

MS277-40M	Machined
MS277-40P	Polished
MS277-40XX	Specify Color

Ball Milled ⚠️

MS277-41M	Machined
MS277-41P	Polished
MS277-41XX	Specify Color

Diamond Hatch Cut ⚠️

MS277-42M	Machined
MS277-42P	Polished
MS277-42XX	Specify Color

Lightning ⚠️

MS277-43M	Machined
MS277-43P	Polished
MS277-43XX	Specify Color

Window Crank

5 1/4" Long

Smooth Style ⚠️

MS277-50M	Machined
MS277-50P	Polished
MS277-50XX	Specify Color

Ball Milled ⚠️

MS277-51M	Machined
MS277-51P	Polished
MS277-51XX	Specify Color

Diamond Hatch Cut ⚠️

MS277-52M	Machined
MS277-52P	Polished
MS277-52XX	Specify Color

Lightning ⚠️

MS277-53M	Machined
MS277-53P	Polished
MS277-53XX	Specify Color



Kinetic Door Handle ⚠️

MS277-49M	Machined
MS277-49P	Polished
MS277-49XX	Specify Color



Kinetic Window Crank ⚠️

MS277-59M	Machined
MS277-59P	Polished
MS277-59XX	Specify Color

*Specify color when ordering: **P**=Bright Polished **M**=Raw Machined **BA**=Gloss Black Anodized

BK=Gloss Black **CA**=Clear Anodized **CL**=Protective Clear Coat **MB**=Matte Black **B**=Blue **R**=Red **W**=White **CH**=Chrome **CK**=Cerakote





Vent Window Crank
Smooth Style, Polished/Clear Coat

Billet Aluminum Vent Window Crank Handles

These window cranks are both beautiful and functional. With a thicker configuration, their handles have a more solid feel than the "petite" street rod-style cranks that are currently available. Our window cranks are 5 1/4 inches long and include a billet knob. They feature a base that has a 2 inch diameter to cover the upholstery cutouts from most existing OEM cranks. Our window cranks feature heavy-duty brass 16-spline inserts that are compatible with both GM and Ford applications. The inserts prevent wearing out and stripping, a common occurrence with OE and imported pot metal cranks. Window cranks are sold in pairs and are available in a variety of custom finishes.



Vent Window Crank
Smooth Style, Machined



Vent Window Crank
Diamond Style, Polished/Clear Coat



Vent Window Crank
Ball Milled Style, Polished/Clear Coat



Vent Window Crank
Smooth Style, Black Anodized



Vent Window Crank
Diamond Style, Gloss Black



Vent Window Crank
Ball Milled Style, Gloss Black



Vent Window Crank
Lightning Style, Machined



Vent Window Crank
Lightning Style, Black Anodized



Vent Window Crank

3 3/4" Long

Smooth Style ⚠️

MS277-60M Machined
MS277-60P Polished
MS277-60XX Specify Color

Ball Milled ⚠️

MS277-61M Machined
MS277-61P Polished
MS277-61XX Specify Color

Diamond Hatch Cut ⚠️

MS277-62M Machined
MS277-62P Polished
MS277-62XX Specify Color

Lightning ⚠️

MS277-63M Machined
MS277-63P Polished
MS277-63XX Specify Color



Vent Window Crank
Kinetic Style, Polished/Clear Coat



Vent Window Crank
Kinetic Style, Black Anodized

Kinetic ⚠️

MS277-69M Machined
MS277-69P Polished
MS277-69XX Specify Color



MS277-31P/CL
Smooth Style



MS277-32MB
Ball Milled Style



MS277-32P/CL
Ball Milled Style



MS277-30MB
Recessed Style



MS277-33MB
Diamond Hatch Cut Style



MS277-33P/CL
Diamond Hatch Cut Style

1964-1966 / 1969-70 Mustang Billet Door Handles ⚠️

Billet Exterior door handle for the 1964-66 and 69-70 Mustang (Does not fit 67-68). Also compatible with 66-77 Bronco, 64-65 Comet, and 64-65 Falcon. Features include precision machined T-6061 billet with a new modern shape and available in five styles. Sold in pairs. ▶

- MS277-30XX Recessed Style
- MS277-31XX Smooth Style
- MS277-32XX Ball Milled Style
- MS277-33XX Diamond Hatch Cut Style
- MS277-34XX Lightning Style



Comes with all necessary hardware.

1967-1968 Mustang Billet Door Handles ⚠️

Billet Exterior door handle for the 1967-1968 Mustang. Features include precision machined T-6061 billet with a new modern shape and available in five different styles. Sold in pairs. ▶

- MS277-35XX Recessed Style
- MS277-36XX Smooth Style
- MS277-37XX Ball Milled Style
- MS277-38XX Diamond Hatch Cut Style
- MS277-39XX Lightning Style



MS277-35MB
Recessed Style



MS277-35P/CL
Recessed Style



Comes with all necessary hardware.



MS278-10MB



MS278-10P/CL

1979-1993 Mustang Billet Door Handles ⚠️ ▶

Billet Exterior door handle for the 1979-1993 Fox Body Mustang. Features include precision machined T-6061 billet with a new modern shape with a recessed area within the pull handle. Also compatible with 86-90 Bronco II, 83-92 Ranger, 81-90 Escort, 83-88 T-Bird, 84-87 Tempo, 81-87 Mercury Lynx, 84-87 Mercury Topaz, and 83-88 Cougar. Comes with all necessary installation hardware. Sold in pairs.

MS278-10XX Specify Finish



*Specify color when ordering: **P**=Bright Polished **M**=Raw Machined **BA**=Gloss Black Anodized

BK=Gloss Black **CA**=Clear Anodized **CL**=Protective Clear Coat **MB**=Matte Black **B**=Blue **R**=Red **W**=White **CK**=Cerakote





1964-1966 Mustang Billet Taillight Bezels

Our Mustang taillight bezels are CNC machined from billet aluminum in the USA. Do not confuse these with cheap imported bezels that are prevalent in the market. Our bezels are a direct replacement part that will work with your stock lenses (not included) or LED lights (see page 104). Sold in pairs.

Smooth Style

- MS275-81M Machined
- MS275-81P Polished
- MS275-81XX Specify Color



71-73 Mustang Billet Side Marker Bezels

These aluminum side marker light bezels are another great addition to your custom Mustang. Versions available for front and rear and offered in a variety of finishes. Sold in pairs.

- MS275-62XX Front / Specify Finish
- MS275-61XX Rear / Specify Finish

71-73 Mustang Billet Door Sill Plates

All billet CNC machined replacement door sill plates. Sold in pairs.

- MS275-56M Machined
- MS275-56P Polished
- MS275-56XX Specify Color



SLIM LINE
SERIES



1964-1966 Mustang LED Billet Taillight Bezels

Our Slim Line Series is a redesigned Mustang taillight bezels are CNC machined from billet aluminum in the USA. Do not confuse these with cheap imported bezels that are prevalent in the market. Our bezels come complete with LED lights. Sold in pairs.

MS275-80XX Specify Finish



1971-1973 Mustang Billet Taillight Bezels

Like our '65-'66 bezels, these CNC machined taillight bezels are just the right touch for your custom Mustang. They are a direct replacement part that will work with your stock lenses (not included). They are available in a variety of finishes and are sold in pairs.

MS275-60 Specify Finish



1964-1966 Ford Mustang Fuel Panel

All billet CNC machined replacement panel.

MS275-83XX Specify Finish



1971-1973 Ford Mustang Fuel Panel

All billet CNC machined replacement panel.

MS275-63XX Specify Finish



MS220-01PB



MS220-01M



MS220-01XX

1965-1966 Mustang Billet Aluminum Gauge Panel ⚠️

Our gauge panels are a great way to adapt aftermarket gauges (sold separately) to your Mustang. Precision CNC machined from a solid chunk of billet aluminum, the panels are a direct replacement for your stock plastic dash. The panels have a separate aluminum insert for multiple finish options and they include high beam and turn signal LED's as well as provisions for two 3-3/8" and four 2-1/6" gauges. You can also purchase your billet gauge panel in a kit that includes a full set of Eddie Motorsports Elite Gauges-call us for pricing.

MS220-01M	Machined bezel/Satin insert
MS220-01PM	Polished bezel/Satin Insert
MS220-01PB	Polished bezel/Black "Camera Case" insert
MS220-01XX	Colored bezel/Colored insert



⚠️ 1965-1966 Mustang One Gage Digital Gauge Panel

Our FiTech gauge panel is a great way to adapt an aftermarket FiTech gauge (sold separately) to your Mustang. Precision CNC machined from a solid chunk of billet aluminum, the panel is a direct replacement for your stock plastic dash. Available in multiple finish options.

MS220-02XX Specify Finish

Nova Radio Panels ⚠️

Whether you want to dress up your radio or remove it altogether, these precision CNC-machined billet aluminum panels will do the trick. Available for 62-67 Novas, the panels are a simple bolt in piece and available in nine custom finishes including factory matching silver and black with a polished pin stripe (specify when ordering). Mounting hardware included.



1962-65 Nova Panels

MS500-01XX	62-65 Radio Dress-up Panel
MS500-02XX	62-65 Radio Delete/3 Gauge Panel
MS500-03XX	66-67 Radio Dress-up Panel
MS500-04XX	66-67 Radio Delete/3 Gauge Panel
MS500-05XX	66-67 Radio Delete/Blank Panel



Highlight finish

1966-67 Nova Panels



Nova Glove Box Door Cover ⚠️

Dress-up the glove box in your 1967 Nova with one of these precision CNC-machined billet aluminum panels. Available in nine custom finishes including factory matching silver and black with a polished pin stripe (specify when ordering). Attaches with two sided tape (included).

MS500-06XX Glove Box Insert

*Specify color when ordering: **P**=Bright Polished **M**=Raw Machined **BA**=Gloss Black Anodized

BK=Gloss Black **CA**=Clear Anodized **CL**=Protective Clear Coat **MB**=Matte Black **B**=Blue **R**=Red **W**=White **HL**=Highlight **CK**=Cerakote

Eddie Motorsports Elite Instruments

Our line of affordable analog performance gauges. Sold in five or six gauge kits that include everything you need to upgrade the gauges in your Hot Rod. All gauge kits include an ultra-reliable and easy to connect 120 mph GPS speedometer and receiver. Six gauge kits include a 7000 RPM tachometer. With six styles to choose from, the gauges feature scratch resistant domed glass lens with water seal, UV resistant coating on the gauge pointer and dial, perimeter lit dials for excellent night visibility, corrosion resistant stainless steel bezels, and brass terminal connectors. The Tach and Speedo are 3 3/8", small gauges are 2 1/16". Assembled in the USA. **Gauge sets come standard with a Five Year Warranty**



Vintage Black Elite Series Gauges

(Black Face, Silver Rim) ⚠️ ▶

Five Gauge Kits

- MSEI-701VB Kit with Universal Fuel gauge
- MSEI-703VB Kit with Chevy Fuel gauge
- MSEI-705VB Kit with Ford Fuel gauge

Six Gauge Kits

- MSEI-700VB Kit with Universal Fuel gauge
- MSEI-702VB Kit with Chevy Fuel gauge
- MSEI-704VB Kit with Ford Fuel gauge

Five Gauge kits include:

- ▶ 120 MPH GPS Speedometer, displays direction, total odometer and two trip odometers. **Functions with any transmission or rear end gears; No need to change Speedometer gears or re-calibrate your gauge!**
- ▶ Ultra-fast and accurate GPS Receiver; updates 10 times per second
- ▶ Fuel Gauge (Universal 33-240 ohm, Ford 73-10 ohm, or Chevy 0-90 ohm applications available)
- ▶ Float Style Fuel Level Sender (Universal applications only)
- ▶ Water Temperature Gauge with Sender
- ▶ Oil Pressure Gauge with Sender
- ▶ Voltmeter
- ▶ Momentary push button trip meter reset switch

Six Gauge kits include:

- ▶ Everything in Five Gauge Kit plus
- ▶ 7000 RPM Tachometer

Vintage White Elite Series Gauges

(White Face, Silver Rim) ⚠️ ▶

Five Gauge Kits

- MSEI-701VW Kit with Universal Fuel gauge
- MSEI-703VW Kit with Chevy Fuel gauge
- MSEI-705VW Kit with Ford Fuel gauge

Six Gauge Kits

- MSEI-700VW Kit with Universal Fuel gauge
- MSEI-702VW Kit with Chevy Fuel gauge
- MSEI-704VW Kit with Ford Fuel gauge



Black Elite Series Gauges

(Black Face, Silver Rim) ⚠️ ▶

Five Gauge Kits

- MSEI-701BK Kit with Universal Fuel gauge
- MSEI-703BK Kit with Chevy Fuel gauge
- MSEI-705BK Kit with Ford Fuel gauge

Six Gauge Kits

- MSEI-700BK Kit with Universal Fuel gauge
- MSEI-702BK Kit with Chevy Fuel gauge
- MSEI-704BK Kit with Ford Fuel gauge



Gold Platinum Elite Series Gauges

(Platinum Face with Gold Highlights, Silver Rim) ⚠️ ▶

Five Gauge Kits

- MSEI-701GP Kit with Universal Fuel gauge
- MSEI-703GP Kit with Chevy Fuel gauge
- MSEI-705GP Kit with Ford Fuel gauge

Six Gauge Kits

- MSEI-700GP Kit with Universal Fuel gauge
- MSEI-702GP Kit with Chevy Fuel gauge
- MSEI-704GP Kit with Ford Fuel gauge



Platinum Elite Series Gauges

(Platinum Face, Silver Rim) ⚠️ ▶

Five Gauge Kits

- MSEI-701PL Kit with Universal Fuel gauge
- MSEI-703PL Kit with Chevy Fuel gauge
- MSEI-705PL Kit with Ford Fuel gauge

Six Gauge Kits

- MSEI-700PL Kit with Universal Fuel gauge
- MSEI-702PL Kit with Chevy Fuel gauge
- MSEI-704PL Kit with Ford Fuel gauge



White Elite Series Gauges

(White Face, Silver Rim) ⚠️ ▶

Five Gauge Kits

- MSEI-701W Kit with Universal Fuel gauge
- MSEI-703W Kit with Chevy Fuel gauge
- MSEI-705W Kit with Ford Fuel gauge

Six Gauge Kits

- MSEI-700W Kit with Universal Fuel gauge
- MSEI-702W Kit with Chevy Fuel gauge
- MSEI-704W Kit with Ford Fuel gauge



13 1/2" & 15" Billet Steering Wheels One of the first things when buying a steering wheel is choosing the size (diameter) you need. Here we have our 13 1/2" and 15" steering wheels side by side showing the visual difference between the two available sizes. The 13-1/2" (340 mm) as well as the 15" (380 mm) steering wheels have a 9 x 3.75" mounting bolt pattern. Wheels are available in a synthetic leather half-wrap, a sport synthetic leather half-wrap or a full-wrap grip in your choice of an Automotive grade Leather or a Alcantara Suede.



15" Wheel

13 1/2" Wheel

13 1/2" & 15" Steering Wheel Grip Options

Standard Series (Half-Wrap)

Our standard series style wheel grips are a half-wrap design. Half billet aluminum, half synthetic leather grip. Available in six different grip colors.

Sport Series (Half-Wrap)

Our sport series style wheel grips are a half-wrap design with 3 different billet aluminum accents. Available in six different grip colors.

1" Grip



Highlight Accent

Polished Accent

Matte Black/
Gloss Black
Accent

Highlight Sport Series

Our highlight sport series wheel has a black anodized finish with machined accented spokes and billet grip accents with your choice of grip color. Available for all highlight models only.



*Available in six different grip colors: Tan, White, Red, Grey, Wood, and Black.



1-1/4" Grip

Full Wrap Series - Leather or Alcantara Suede

- Thick grip for comfort and performance
- Stitched from 100% Automotive grade genuine leather or Alcantara Suede
- Made in USA
- Made to order
- Available for all Eddie Motorsport models





Full Wrap Series-Suede

Sport Series



MS138-89P

Kinetic 4 Spoke 13-1/2" ⚠

- MS140-89XX Specify Color ▶
- MS139-89XX Sport Series
- MS138-89XX Specify Color
- MS137-89XX Full Wrap Leather Specify Color
- MS137-89XX Full Wrap Suede Specify Color



Half-Wrap

◀ Racer 4 Spoke 13-1/2" ⚠

- MS140-80XX Specify Color
- MS139-80XX Sport Specify Color
- MS138-80XX Full Wrap Leather Specify Color
- MS137-80XX Full Wrap Suede Specify Color



Sport Series



Sport Series

Full Wrap Series-Leather

◀ Classic 4 Spoke 13-1/2" ⚠

- MS140-85XX Specify Color
- MS139-85XX Sport Specify Color
- MS138-85XX Full Wrap Leather Specify Color
- MS137-85XX Full Wrap Suede Specify Color

Available Spoke Finishes:

*Specify color when ordering: **P**=Bright Polished **BA**=Gloss Black Anodized **BK**=Gloss Black **CA**=Clear Anodized **CL**=Protective Clear Coat **MB**=Matte Black **R**=Bright Red **B**=Bright Blue **W**=Gloss White **CK**=Cerakote



Racer 13-1/2" ⚠ ▶

- MS140-50XX Specify Color
- MS139-50XX Sport Specify Color
- MS138-50XX Full Wrap Leather Specify Color
- MS137-50XX Full Wrap Suede Specify Color

Racer 15" ⚠

- MS140-30XX Specify Color



MS140-50CA

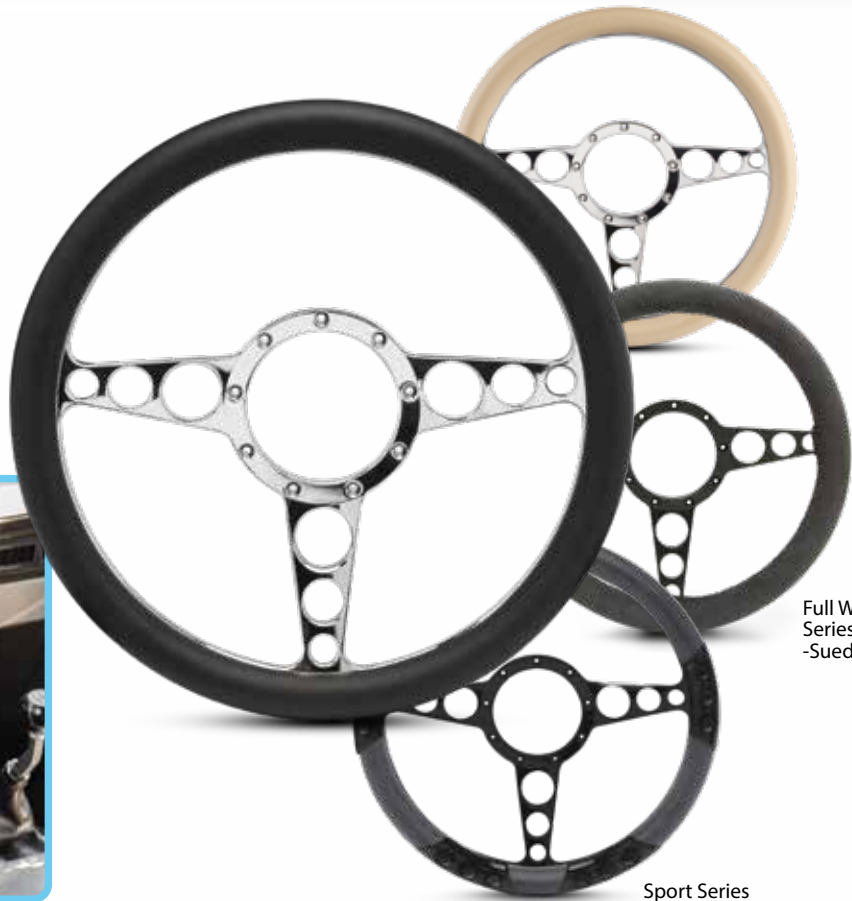

Full Wrap Series -Suede

Sport Series

Classic 13-1/2" ⚠ ▶

- MS140-55XX Specify Color
- MS139-55XX Sport Specify Color
- MS138-55XX Full Wrap Leather Specify Color
- MS137-55XX Full Wrap Suede Specify Color

Classic 15" ⚠

- MS140-35XX Specify Color

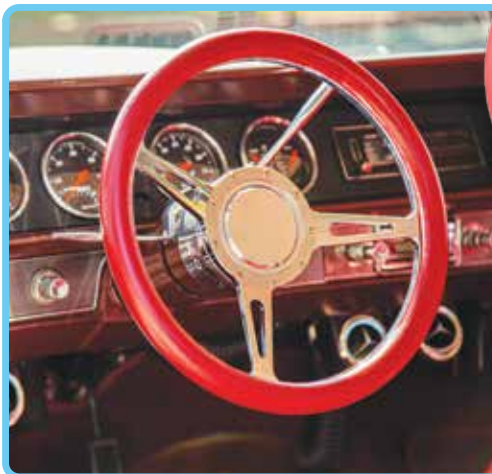

MS140-55RP



Sport Series





Sport Series
-Highlight

Sport Series

◀ SS 13-1/2" ⚠

- MS140-52XX Specify Color
- MS140-52HL Highlight
- MS139-52XX Sport Specify Color
- MS139-52HL Sport Highlight
- MS138-52XX Full Wrap Leather
- Specify Color
- MS137-52XX Full Wrap Suede
- Specify Color

SS 15" ⚠

- MS140-32XX Specify Color
- MS140-32HL Highlight



SS Sport Series
Half Wrap-Highlight



Full Wrap Series
Highlight-Suede

◀ Launch 13-1/2" ⚠

- MS140-54XX Specify Color
- MS140-54HL Highlight
- MS139-54XX Sport Color
- MS139-54HL Sport
- Highlight
- MS138-54XX Full Wrap Leather
- Specify Color
- MS137-54XX Full Wrap Suede
- Specify Color

Launch 15" ⚠

- MS140-34XX Specify Color
- MS140-34HL Highlight

Available Spoke Finishes:

*Specify color when ordering: **P**=Bright Polished **BA**=Gloss Black Anodized **BK**=Gloss Black **CA**=Clear Anodized **CL**=Protective Clear Coat **MB**=Matte Black **R**=Bright Red **B**=Bright Blue **W**=Gloss White **CK**=Cerakote **HL**=Highlight



Reaper 13-1/2" ⚠

- MS140-60XX Specify Color
- MS139-60XX Sport Specify Color
- MS138-60XX Full Wrap Leather Specify Color
- MS137-60FSXX Full Wrap Suede Specify Color

Raptor 15" ⚠

- MS140-33XX Specify Color

Linear 13-1/2" ⚠ ▶

- MS140-58XX Specify Color
- MS140-58HL Highlight
- MS139-58XX Sport Color
- MS139-58HL Sport Highlight
- MS138-58XX Full Wrap Leather Specify Color
- MS137-58XX Full Wrap Suede Specify Color

Linear 15" ⚠

- MS140-38XX Specify Color
- MS140-38HL Highlight



Full Wrap Series
Highlight
-Leather



Raptor 13-1/2" ⚠

- MS140-61XX Specify Color
- MS139-61XX Sport Specify Color
- MS138-61XX Full Wrap Leather Specify Color
- MS137-61XX Full Wrap Suede Specify Color

Raptor 15" ⚠

- MS140-36XX Specify Color





◀ **Vintage 15"** ⚠
MS140-31XX Specify Color



Back



◀ **Symmetrical 13-1/2"** ⚠
MS140-57XX Specify Color
MS140-57HL Highlight
MS138-57XX Full Wrap Leather Specify Color
MS137-57XX Full Wrap Suede Specify Color

Highlight-

Full Wrap Series-Suede

Available Finishes:

*Specify color when ordering: **P**=Bright Polished
BA=Gloss Black Anodized **BK**=Gloss Black **CA**=Clear Anodized **CL**=Protective Clear Coat **MB**=Matte Black **R**=Bright Red **B**=Bright Blue **W**=Gloss White
CK=Cerakote

Full Wrap
Series-Suede

◀ G3 13-1/2 ⚠

MS140-59XX

MS138-59XX

MS137-59XX

Specify Color
Full Wrap Leather
Specify Color
Full Wrap Suede
Specify Color

G3 15" ⚠

MS140-39XX

Specify Color

Steering Wheel Adapters



Steering Adapters with G3 Horn Cover ⚠

MS141-59M

Machined

MS141-59P

Polished

MS141-59XX

Specify Color

Horn Cover Assembly Only ⚠

MS141-58M

Machined

MS141-58P

Polished

MS141-58XX

Specify Color



GM Steering Wheel Adapters

These billet aluminum adapters are available for specific GM, Ford, and Mopar splined steering columns and industry standard nine-bolt steering wheels. Eddie Motorsports billet adapters are offered individually (without screws) or in a kit with horn cap and screws. With a functional horn kit, the adapters are 2-1/2 tall. Our horn covers are available in two distinct styles, our standard cover and our full horn cover (hides the steering wheel mounting fasteners). GM, Ford and Mopar adapters with or without horn covers are available. Horn covers are also available separately. Specify finish when ordering. NOTE: Will not fit applications with telescoping steering column.



Steering Adapters with Standard Horn Cover ⚠ ▲

Fit 1967-1994 GM splined steering columns

MS141-51M	Machined
MS141-51P	Polished
MS141-51XX	Specify Color

Horn Cover Assembly Only ⚠

MS141-53M	Machined
MS141-53P	Polished
MS141-53XX	Specify Color



Steering Adapters with Full Horn Cover ▲ ⚠

Fit 1967-1994 GM steering columns. Stealth look that hides your mounting bolts!

MS141-54M	Machined
MS141-54P	Polished
MS141-54XX	Specify Color

Horn Cover Assembly Only ⚠

MS141-52M	Machined
MS141-52P	Polished
MS141-52XX	Specify Color

Ford & Mopar Steering Wheel Adapters

These billet aluminum adapters fit Ford and Mopar splined steering columns and industry standard nine-bolt steering. Specify finish when ordering.

Ford Steering Adapter ⚠

Steering hub for 64-70 Ford Mustang, 66-77 Bronco, and 48-79 F-100 steering columns.

MS141-68P	Polished
MS141-68XX	Specify Color

Mopar Steering Adapter ⚠

Steering hub for Mopar 61-69 steering columns.

MS141-67P	Polished
MS141-67XX	Specify Color

Billet Pedal Covers

Our billet pedal covers are 3D CNC machined from a solid piece of aluminum to fit the curve of your pedals to perfection. Kits are available for many popular Chevy muscle car applications in stick shift and automatic transmission configurations. Billet Pedal Covers fit 1967-92 Camaro, 1968-77 Chevelle/El Camino, 1970-77 Monte Carlo, 1968-74 Nova



▲ Clear Anodized



▲ Black Anodized



▲ Clear Anodized



Manual Trans Pedal Covers ⚠️

Covers are offered for accelerator, brake, clutch, and emergency brake. Available with a raw machined finish or black or clear anodized.

MS275-91M	Machined
MS275-91CA	Clear Anodized
MS275-91MB	Black Anodized

Automatic Trans Pedal Covers ⚠️

Covers are offered for accelerator, brake, and emergency brake. Available with a raw machined finish or black or clear anodized.

MS275-90M	Machined
MS275-90CA	Clear Anodized
MS275-90MB	Black Anodized

Tremec Shifters ⚠️

Four new styles to choose from for your Tremec and T-5 transmissions. Precision CNC machined from 6061-T6 aluminum. The shifters are 10 1/2" tall with a 12 x 1.7mm thread. Available in a bright polished finish as well as a variety of Fusioncoated and anodized finishes.

- MS110-60 Smooth Style
- MS110-80 Ball Milled Style
- MS110-81 Diamond Hatch Cut Style
- MS110-82 Contoured Style
- MS110-83 Lightning II Style
- MS110-61 Lightning Style



Smooth Style

Ball Milled Style

Diamond Hatch Cut Style

Contoured Style

Lightning II Style

Lightning Style



Billet Shift Knob

Machined from billet aluminum, our polished and satin finished knobs are available with a plain top or engraved with a 5 or 6 speed Tremec shift pattern. Colored knobs can also be laser etched with any pattern or logo. The shift knobs have a 12 x 1.7mm thread.

Plain Shift Knob ⚠️

- MS110-50M Satin
- MS110-50P Polished
- MS110-50XX Color

5 Speed Shift Knob ⚠️

- MS110-51M Satin
- MS110-51P Polished
- MS110-51XX Color

6 Speed Shift Knob ⚠️

- MS110-52M Satin
- MS110-52P Polished
- MS110-52XX Color

*Specify color when ordering: **P**=Bright Polished **M**=Raw Machined **BA**=Gloss Black Anodized

BK=Gloss Black **CA**=Clear Anodized **CL**=Protective Clear Coat **MB**=Matte Black **B**=Blue **R**=Red **W**=White **CK**=Cerakote

Billet Aluminum Shifter Bezels

Our newest interior dress up product. Available in three styles, the bezels come with a unique aluminum back up/mount plate that makes installation of the boot to the bezel simple and easy. The bezels are available with or without a black Naugahyde boot. Machined from 1/2" thick billet aluminum, the bezels are 5 1/4" wide and 6 3/4" long and install with eight #10 screws (included). Available in a variety of finishes.

Shift Bezel and Mount Plate only

- MS110-64 Smooth
- MS110-65 Ball Milled
- MS110-66 Contoured

Shift Bezel Kit with Mount Plate & Boot

- MS110-67 Smooth
- MS110-68 Ball Milled
- MS110-69 Contoured



Billet Clutch Reservoir

Eddie Motorsports' new billet aluminum clutch reservoir is manufactured from 6061-T6 aluminum. The reservoir includes a billet aluminum bracket for easy mounting on your car's firewall or other easy-to-access locations. The bracket is 3 1/2" long with provisions for two 1/4" socket cap screws for mounting. The 2" round reservoir is 3 1/2" tall and has a 4 oz capacity. The outlet is tapped 1/8" NPT and comes with an aluminum 5/16" barbed fitting. The clutch reservoir is available in a raw machined or bright polished finish as well as black and clear anodized.

- MS110-70M Machined
- MS110-70P Polished
- MS110-70BA Black Anodized
- MS110-70CA Clear Anodized



Billet Clutch Reservoir / Master Cylinder Mount Kit

An easy way to fasten your Eddie Motorsports Clutch Reservoir to your Wilwood master cylinder (with 3 3/8" center to center location of plugs). No cutting or drilling required! The kit comes complete with a billet aluminum bracket, aluminum plugs and washers, and stainless steel fasteners. Available in a raw machined or bright polished finish as well as black and clear anodized.



- MS110-71M Machined
- MS110-71P Polished
- MS110-71BA Black Anodized
- MS110-71CA Clear Anodized

*Specify color when ordering: **P**=Bright Polished **M**=Raw Machined **BA**=Gloss Black Anodized

BK=Gloss Black **CA**=Clear Anodized **CL**=Protective Clear Coat **MB**=Matte Black **B**=Blue **R**=Red **W**=White **CK**=Cerakote

Billet Aluminum Drink Holders

These high quality drink holders are CNC machined from a solid piece of aluminum. They are available in a variety of sizes and finishes.



Large Billet Drink Holders ⚠️

These are unique in that they have a 3/4" deep step in the bottom to accommodate both large and small drinks. Dimensions: Cut-out-3 3/4" Flange-4 1/2" Depth-3 1/8" (includes 3/4" for length of step).

- | | |
|------------|---------------|
| MS281-42M | Machined |
| MS281-42P | Polished |
| MS281-42XX | Specify Color |



Medium Billet Drink Holders ⚠️

Dimensions: Cut-out-3 3/8" Flange-4 1/8" Depth-2 13/16"

- | | |
|-------------|---------------|
| MS281-43M | Machined |
| MS281-43P | Polished |
| MS281-43 XX | Specify Color |



Small Billet Drink Holders ⚠️

Dimensions: Cut-out-3" Flange-3 1/2" Depth-2 5/8"

- | | |
|-------------|---------------|
| MS281-45M | Machined |
| MS281-45P | Polished |
| MS281-45 XX | Specify Color |



Short Small Billet Drink Holders ⚠️

Short design for use with limited space. Dimensions: Cut-out-3" Flange-3 1/2" Depth-1 1/2"

- | | |
|-------------|---------------|
| MS281-44M | Machined |
| MS281-44P | Polished |
| MS281-44 XX | Specify Color |

Spun Aluminum Drink Holders

These drink holders are spun aluminum and are an attractive and functional insert for holding a soda can or fountain drink. These are our most affordable drink holders and are available in various sizes and finishes.



Small Spun Aluminum Drink Holders ⚠️

Dimensions: Cut-out-3" Flange-3 3/4" Depth-2 7/8"

- | | |
|-------------|----------|
| MS281-39M | Machined |
| MS281-39P | Polished |
| MS281-39 XX | Color |

Medium Spun Aluminum Drink Holders ⚠️

Dimensions: Cut-out-3 3/8" Flange-4 3/16" Depth-3"

- | | |
|-------------|----------|
| MS281-32M | Machined |
| MS281-32P | Polished |
| MS281-32 XX | Color |

Large Spun Aluminum Drink Holders ⚠️

Cut-out-3 3/4" Flange-4 5/8" Depth-2 7/8"

- | | |
|-------------|---------------|
| MS281-31M | Machined |
| MS281-31P | Polished |
| MS281-31 XX | Specify Color |

Drink Holder Neoprene Inserts

Adhesive back sticks to the bottom of the drink holder to insulate and protect them. ⚠️



- | | |
|----------|--------|
| MS281-35 | Small |
| MS281-37 | Medium |
| MS281-34 | Large |

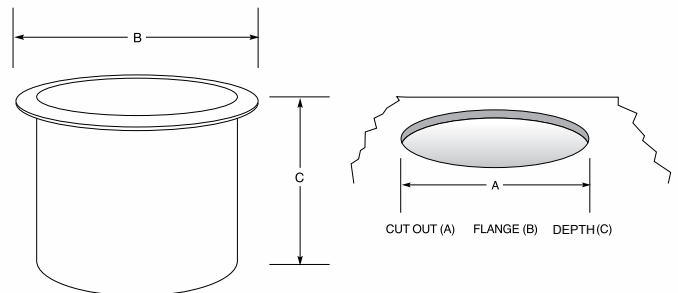



LED Cup Holders

Add an appealing soft glow to your cockpit during night time cruising with these LED cup holders.

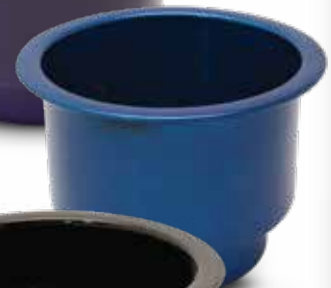
Manufactured from stainless steel, the cup holders incorporate three LED's and require a 12 volt power source for operation. They also include a rubber insert to prevent rattling and a 1/4" drain hose nipple on the underside. The cup holders are available with red or blue lights and with a bright polished finish or a variety of Fusioncoat colors. Dimensions: Cut-out-3 5/8" Flange- 4 1/4" Depth-3 3/16"



MS281-90P  Cup holder with red light, Polished
MS281-90XX  Cup holder with red light, Specify color

MS281-91P  Cup holder with blue light, Polished
MS281-91XX  Cup holder with blue light, Specify color

*Specify color when ordering: **P**=Bright Polished **M**=Raw Machined **BA**=Gloss Black Anodized

BK=Gloss Black **CA**=Clear Anodized **CL**=Protective Clear Coat **MB**=Matte Black **B**=Blue **R**=Red **W**=White **CK**=Cerakote



Billet Aluminum Door Lock Knobs

Machined from billet aluminum and available in four styles with various finishes. Knobs with 10-24 threads fit most Chevy and Ford muscle cars. Sold in pairs specify finish when ordering.



Small OEM Style

has 10-24 threads and fits '64-'66 Chevys

MS274-18 10-24 threads



Large OEM Style

has 10-24 threads and fits '68-up Chevys

MS274-19 10-24 threads



Grooved Style

MS274-13 10-24 threads



Radius Style

MS274-14 10-24 threads

Billet Door Pull

Our new billet aluminum door pull. They measure 4 inches long 1 1/4 inch wide and 1 inch deep. Fastens with two #10 screws. Available with a raw machined or highly polished finish as well as a variety of Fusioncoated and anodized colors.

MS274-10M	Machined
MS274-10P	Polish
MS274-10XX	Specify Color

Sold Individually



Courtesy Lights

Ideal for lighting up interior areas. LED bulbs are now available to upgrade the lights, available in soft white, bright white and blue (order separately). Add a custom billet bezel to match your interior trim (sold separately). Lights measure 4" X 2".

MSSD-200	Light (only)
MSSD-201	Billet Bezel (only)
MSSD-205W	LED Bulb Only Soft White (pair)
MSSD-205P	LED Bulb Only Bright White (pair)
MSSD-205B	LED Bulb Only Blue (pair)

Billet Aluminum Push Pull Switch Knobs

Our billet aluminum push pull knobs are a nice addition to your dash. Colored knobs can be laser engraved, works with switches with 10-32 threads.

MS200-11M	Machined
MS200-11P	Polished
MS200-11XX	Knob Color



*Specify color when ordering: **P**=Bright Polished **M**=Raw Machined **BA**=Gloss Black Anodized **BK**=Gloss Black **CA**=Clear Anodized **CL**=Protective Clear Coat **MB**=Matte Black **B**=Blue **R**=Red **W**=White **CK**=Cerakote

Flush Mount Gas Fill ⚠

Our most popular low profile gas fill, these fills are precision CNC machined out of 6061-T6 billet aluminum. The outer edge features an oversized contoured knurl making for easy removal. They mount with three hidden screws (sold separately), are 3 1/2" in diameter, available vented or non-vented, for use with 1 1/2" or 2" filler hose, and come in a variety of finishes

1 1/2" Gas Fill Vented

MS265-15P Polished
MS265-15XX Specify Color

1 1/2" Gas Fill Non-Vented

MS265-16P Polished
MS265-16XX Specify Color

2" Gas Fill Vented

MS265-17P Polished
MS265-17XX Specify Color

2" Gas Fill Non-Vented

MS265-18P Polished
MS265-18XX Specify Color

2" Gas Fill Vented w/Angled Neck

MS265-43P Polished
MS265-43XX Specify Color

2" Gas Fill Non-Vented w/Angled Neck

MS265-44P Polished
MS265-44XX Specify Color



Flip Tab Gas Fill ⚠

This gas cap has a very low profile and uses a cast stainless steel cap and a CNC machined billet aluminum base. The cap is removed by lifting and twisting the small flip tab. The fills are 3 1/2" diameter, vented, and are available for use with 1 1/2" or 2" filler hose and come in a variety of finishes.

1 1/2" Gas Fill Vented

MS265-33P Polished
MS265-33XX Specify Color

2" Gas Fill Vented

MS265-35P Polished
MS265-35XX Specify Color

2" Gas Fill Vented w/Angled Neck

MS265-53P Polished
MS265-53XX Specify Color

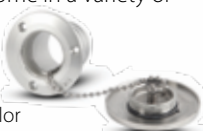

Aircraft Style Gas Fill ⚠

A unique aircraft style fuel fill CNC machined from billet aluminum and ideal for many custom applications. The cap uses a simple cam system for easy removal by lifting and twisting the center tab a quarter of a turn. The fills are 3 3/4" diameter, non-vented, and are available for use with 1 1/2" or 2" filler hose and come in a variety of finishes.

1 1/2" Gas Fill Non-Vented

MS265-46P Polished
MS265-46XX Specify Color

2" Gas Fill Non-Vented

MS265-45P Polished
MS265-45XX Specify Color



Aluminum Flip Top Gas Fill ⚠

Cast aluminum and available with a polished finish only. The mounting base is 2 1/2" x 3 1/2". The fills are vented and

available for use with 2" filler hose.

MS265-20 2" Gas Fill



Stainless Steel Flip Top Gas Fill ⚠

These gas fills are cast stainless steel and available with a polished finish only. The mounting base is 3" x 4". The fills are vented and available for use

with 1 1/2" or 2" filler hose.

1 1/2" Gas Fill
MS265-23

2" Gas Fill
MS265-22

Stainless Steel Flush Mount Gas Fill ⚠

These gas fills are cast stainless steel and available with a polished finish only. They are non-vented and available for use with 1 1/2" or 2" filler hose. The mounting base is 3 1/2" on 2" fill and 2-15/16" on the 1 1/2" fill

1 1/2" Gas Fill
MS265-26

2" Gas Fill
MS265-25



Gas Fill with Angled Neck ⚠



Rally Bezel for Flip Tab & Flush Gas Fills ⚠

The eight polished stainless socket cap screws (included) are threaded into the bezel which are 4 5/8" in diameter and 1/4" thick. Gas fill is sold separately.

MS265-74M Machined
MS265-74P Polished
MS265-74XX Specify Color



Bezel for Flip Tab Gas Fills ⚠

These bezels have a recess for the fills to sit in and are 4" in diameter. Gas fill is sold separately.

MS265-27M Machined
MS265-27P Polished
MS265-27XX Specify Color



Billet Battery Boxes Race Style for 34 & 78 Optima Batteries ⚠️

Our new Race Style Triangular Top design, these boxes fit Optima 34 & 78 series batteries measuring 10"L X 6.8"W X 7.8"H. Mounting fasteners are not included. Available in machined, polished, or Fusioncoated color finish.

MS374-96 Smooth



Billet Battery Boxes Race Style for 1000 /1400/1600 XS Batteries ⚠️

Our new Race Style Triangular Top design, these boxes fit XS 1000 / 1400 / 1600 batteries measuring 10 3/16"L X 6 1/2"W X 6 7/8"H. Mounting fasteners are not included. Available in machined, polished, or Fusioncoated color finish.

MS374-98 Smooth



Billet Battery Boxes for D34 & R34 Optima Batteries ⚠️

Finally a battery box that looks as good as an Optima battery performs and ideal for trunk mounting. With polished aluminum hold down studs and stainless screws. Mounting fasteners are not included. Fits Optima D34 & R34 Batteries measuring 10"L X 6.8"W X 7.8"H and available in machined, polished, or Fusioncoated color finish.

MS374-75 Ball Milled

MS374-75S Smooth



Billet Battery Boxes for D31 Optima Batteries ⚠️

This battery box is specifically designed to hold a D31 Optima battery which measures 6 1/4" x 12 1/2". Due to its large size we use four (4) stand offs to hold the battery in place. This box is machined from 3/8" billet aluminum and finished to perfection like the rest of our products. Mounting fasteners are not included. Available in machined, polished, or Fusioncoated color finish.

MS374-79 Ball Milled



Billet Battery Boxes for D51 Optima Batteries

Billet aluminum battery box for the popular Optima D51 battery measuring 4 7/8" x 9". You can choose from a full cover top or a strap style. Mounting fasteners are not included. Available in machined, polished, or Fusioncoated finish.

Strap Style ⚠️

MS374-71S Smooth

MS374-71 Ball Milled

Full Cover ⚠️

MS374-73 Ball Milled

MS374-73S Smooth



Billet Battery Boxes for 78 Optima Batteries ⚠️

Billet aluminum battery box for Optima 78 series batteries measuring 10"L X 6.8"W X 7.8"H. Mounting fasteners are not included. Available with a smooth or ball milled top in brushed satin, polished, Fusioncoat and anodized finish.

MS374-95S Smooth Top

MS374-95 Ball Milled Top

*Specify finish when ordering: **M**=Brushed Satin **P**=Bright Polished **BA**=Gloss Black Anodized **BK**=Gloss Black **CA**=Clear Anodized **CL**=Protective Clear Coat **MB**=Matte Black **B**=Bright Blue **R**=Bright Red **W**=White **PR**=Bright Purple **CK**=Cerakote



Billet Battery Box for Odyssey 1200 ⚠️

Precision CNC machined from billet aluminum. Ideal for trunk mounting of your Odyssey battery. Stainless steel fasteners and billet hold down stanchions are included. Mounting fasteners are not included. Fits Odyssey 1200 batteries measuring 6 5/8"W X 7 7/8"L X 6 5/8"H. Available in brushed satin or bright polished finish as well as a variety of Fusioncoat and anodize colors.

MS374-76M	Satin
MS374-76P	Polished
MS374-76XX	Specify Color



Billet Battery Box for Odyssey 1700 ⚠️

Precision CNC machined from billet aluminum. Ideal for trunk mounting of your Odyssey battery. Stainless steel fasteners and billet hold down stanchions are included. Mounting fasteners are not included. Fits Odyssey 1700 batteries measuring 6 5/8"W X 12 7/8"L X 6 3/4"H. Available in brushed satin or bright polished finish as well as a variety of Fusioncoat and anodize colors.

MS374-77M	Satin
MS374-77P	Polished
MS374-77XX	Specify Color



Billet Battery Boxes for Standard Batteries ⚠️

CNC machined billet aluminum battery boxes for standard group 24 (10 3/4"L x 6 3/4"W) and 27 (12L x 6 3/4"W) batteries, they come complete with stainless steel fasteners and polished aluminum stand-offs. Mounting fasteners are not included.

MS374-80	Group 24
MS374-81	Group 27



Billet Battery Box for Odyssey 1500 ⚠️

Precision CNC machined from billet aluminum. Ideal for trunk mounting of your Odyssey battery. Stainless steel fasteners and billet hold down stanchions are included. Mounting fasteners are not included. Fits Odyssey 1500 batteries measuring 6 1/4"W X 10"L X 6 3/4"H. Available in brushed satin or bright polished finish as well as a variety of Fusioncoat and anodize colors.

MS374-86M	Satin
MS374-86P	Polished
MS374-86XX	Specify Color



Billet Battery Box for Odyssey 2150 ⚠️

Precision CNC machined from billet aluminum. Ideal for trunk mounting of your Odyssey battery. Stainless steel fasteners and billet hold down stanchions are included. Mounting fasteners are not included. Fits Odyssey 2150 batteries measuring 6 1/2"W X 12 1/4"L X 8 3/8"H. Available in brushed satin or bright polished finish as well as a variety of Fusioncoat and anodize colors.

MS374-85M	Satin
MS374-85P	Polished
MS374-85XX	Specify Color



Billet Battery Box for Odyssey Group 31M ⚠️

Precision CNC machined from billet aluminum. Ideal for trunk mounting of your Odyssey battery. Stainless steel fasteners and billet hold down stanchions are included. Mounting fasteners are not included. Fits Odyssey Group 31 (2150) and AGM Interstate 31 batteries measuring 6 3/4"W X 13"L X 8 7/8"H. Available in brushed satin or bright polished finish as well as a variety of Fusioncoat and anodize colors.

MS374-01M	Satin
MS374-01P	Polished
MS374-01XX	Specify Color





Battery Disconnect Mount Kits

Eddie Motorsport's simple fix for what was once a time consuming problem-adding a battery switch to your charging system. Made from 3/16" thick aluminum, our Billet Battery Disconnect Switch kits can be easily attached to the mount posts on our battery boxes. Simply slide the battery switch panel over the side post and secure with the mount's two set screws. Works with posts up to 1/2". The kits come with a high quality battery switch (specs listed below) and panel (battery box is sold separately). Available in a variety of finishes. Specify when ordering.

Battery Box Mount & Switch

- MS374-07M Brushed Satin
- MS374-07P Polished
- MS374-07XX Specify Color

Battery Box Mount & Switch with alternator shut-off

- MS374-08M Brushed Satin
- MS374-08P Polished
- MS374-08XX Specify Color

Battery Box Mount Panel only (Does not include switch)

- MS374-10M Brushed Satin
- MS374-10P Polished
- MS374-10XX Specify Color



Battery Disconnect Switch Panel Mount

Made from 3/16" thick aluminum, our Billet Battery Disconnect Switch Panel Mount provides an easy method for attaching your switch. The kits come with a high quality battery switch (specs listed to the right) and panel mount. Panel is 4" X 4" with #10 countersunk holes. Available in a variety of finishes. Specify when ordering.

Panel Mount & Standard On/Off Battery Switch

- MS374-05M Brushed Satin
- MS374-05P Polished
- MS374-05XX Specify Color

Panel Mount & On/Off Battery Switch with alternator shut-off

- MS374-06M Brushed Satin
- MS374-06P Polished
- MS374-06XX Specify Color

Panel Mount Only

- (Does not include switch)
- MS374-09M Brushed Satin
 - MS374-09P Polished
 - MS374-09XX Specify Color

Battery Disconnect Switches

For 6-36V systems. Rated @175A continuous (125A for alt cut off switch)/1000A intermittent. Chrome lever & case, brass contacts, and 3/8" battery studs (alt cut off includes 10-32 alternator studs).

- MS374-03 Battery Disconnect Switch
- MS374-04 Battery Disconnect Switch with alternator shut-off



Frame Rail Battery Mount

Made from 1/2" aluminum, mount your Eddie Motorsports Billet battery box to a frame rail, firewall or other location. The mounts are tapped 5/16-18 and come with stainless steel fasteners to attach your Eddie Billet Battery Box. The battery mounting is 8" long x 6-1/2" wide and the frame mount leg is 5" long. Gloss black finish.

- MS374-52BK



Remote Battery Jumper Boxes

Mount in a remote place to provide access for jumper cables or battery chargers. Open the cover to expose the two battery posts. Available in black or white plastic or with a billet aluminum enclosure. The plastic outlet is 5 3/8" L X 3 3/8" W. The billet outlets measure 6 1/8" L X 4 3/8" W and are available in a variety of custom finishes.

- MS302-31W White Plastic
- MS302-31BK Black Plastic
- MS600-40 Billet Jumper Box

*Specify finish when ordering: **M**=Brushed Satin **P**=Bright Polished **BA**=Gloss Black Anodized **BK**=Gloss Black **CA**=Clear Anodized **CL**=Protective Clear Coat **MB**=Matte Black **B**=Bright Blue **R**=Bright Red **W**=White **PR**=Bright Purple **CK**=Cerakote

Billet Classic Style Speaker Grills

Dress up your speakers with Eddie Motorsport's billet aluminum speaker grills. The grills are available in our Classic style series. The two piece kits come with a billet aluminum mounting ring which is fastened to your door panel or speaker box. The speaker grill is then attached to the ring with four stainless steel fasteners (included). The grills are available in a bright polished finish or in a variety of Fusioncoated or anodized colors. Speaker grills are sold individually.



6X9 Speaker Grills ⚠️

MS400-30P Polished
MS400-30XX Color

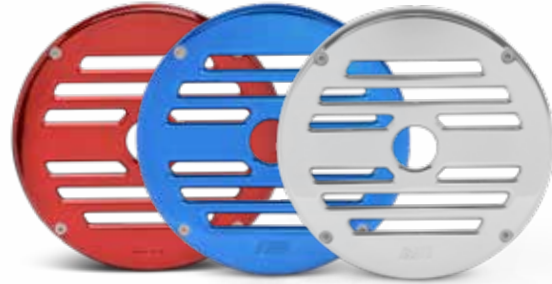

6 1/2" Round Speaker Grill ⚠️

With tweeter hole
MS400-26P Polished
MS400-26XX Color



10" Round Speaker Grill ⚠️

MS400-45P Polished
MS400-45XX Color



8" Round Speaker Grill ⚠️

MS400-40P Polished
MS400-40XX Color

Speaker Grill Installation

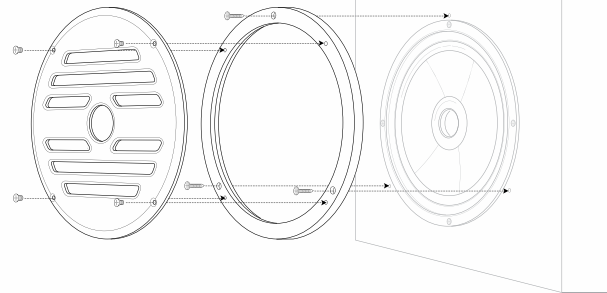

Classic Style Billet Stereo Enclosures ⚠️

A great alternative for mounting and protecting your stereo. The covers incorporate a smoked Lexan shield and an o-ring seal for moisture protection. They are held firmly in the closed position with magnets. The enclosures are 4" X 9", recess into a standard 7 7/8" X 2 5/8" stereo cut out, and are held in place with six #10 fasteners. The enclosures are available in a raw machined or bright polished finish or in a variety of Fusioncoat and anodize colors.



MS400-20M Machined
MS400-20P Polished
MS400-20XX Specify Color



Billet Aluminum Air Cleaners

Eddie Motorsports air cleaners are CNC-machined from billet aluminum and manufactured in the USA. They're available in round or oval designs and different styles to fit your wants and needs. Make your engine compartment worthy of attention.



MS215-20P

MS215-21HL

Small Aluminum Oval Air Cleaners 12" X 8 1/2"

These air cleaners are cast aluminum and come standard with a 2" paper filter element. Washable cotton gauze elements in 2" or 4" height are also available. The air cleaners have a 5 1/8" opening to fit standard four barrel carburetors.

- | | |
|------------|---------------------------|
| MS215-20 | Smooth Top |
| MS215-21 | Ball Milled Top |
| MS215-21HL | Ball Milled Highlight Top |
| MS215-23 | 2" Paper Element |
| MS215-24 | 2" Washable Element |
| MS215-25 | 4" Washable Element |

Medium Billet Aluminum Oval Air Cleaners 15 1/2" X 9"

These air cleaners are fully CNC machined and come standard with a 2" paper filter element. Washable cotton gauze elements in 2" or 4" height are also available. The air cleaners have a 5 1/8" opening to fit standard four barrel carburetors.

- | | |
|------------|---------------------------|
| MS215-70 | Smooth Top |
| MS215-71 | Ball Milled Top |
| MS215-71HL | Ball Milled Highlight Top |
| MS215-73 | 2" Paper Element |
| MS215-74 | 2" Washable Element |
| MS215-75 | 4" Washable Element |



Small Aluminum Oval Finned Air Cleaner 12" X 8 1/2"

Cast aluminum oval air cleaner with a finned top. 12" long with a 2" paper element. Specify color.

MS215-31XX Finned Oval Air Cleaner



MS215-66HL

MS215-66BK

MS215-68P

Round Billet Aluminum Air Cleaners 14"

These air cleaners are fully CNC machined and come with a 3" tall American made washable cotton gauze element. They have a 5 1/8" opening to fit standard four barrel carburetors.

- | | |
|------------|---------------------------|
| MS215-65 | Smooth Top |
| MS215-66 | Ball Milled Top |
| MS215-66HL | Ball Milled Highlight Top |
| MS215-68 | Spoke Design Top |



MS215-91HL

MS215-91P

MS215-96MB

Large Oval Billet Aluminum Air Cleaners 17 1/2" X 10"

These are fully CNC machined and come with a 3" tall American made washable cotton gauze element. They are available for standard (5 1/8" opening) or dominator (7 1/4" opening) carburetors.

- | | |
|------------|---------------------------|
| MS215-90 | Smooth Top Standard |
| MS215-91 | Ball Milled Top Standard |
| MS215-91HL | Ball Milled Highlight Top |
| MS215-95 | Smooth Top Dominator |
| MS215-96 | Ball Milled Top Dominator |



MS215-90R

Diamond Series Air Cleaners

Eddie Motorsports' Diamond series offers a fresh and innovative look for your engine accessories. We use a cross hatch machining process to give the accessories a raised metal diamond appearance. With the Eddie Motorsports Highlight finish, we diamond cut the parts after they have been Fusioncoated.



MS215-69HL



MS215-69MB



MS215-69P



Round Billet Aluminum Air Cleaners 14"

These air cleaners are fully CNC machined and come with a 3" tall American made washable cotton gauze element. They have a 5 1/8" opening to fit standard four barrel carburetors.

MS215-69 Round Air Cleaner ⚠️



Medium Billet Aluminum Oval Air Cleaners 15 1/2" X 9" ⚠️

These air cleaners are fully CNC machined and come standard with a 2" paper filter element. Washable cotton gauze elements in 2" or 4" height are also available. The air cleaners have a 5 1/8" opening to fit standard four barrel carburetors.

- MS215-72 Oval Air Cleaner
- MS215-73 2" Paper Element
- MS215-74 2" Washable Element
- MS215-75 4" Washable Element

Small Aluminum Oval Air Cleaners 12" X 8 1/2" ⚠️

These air cleaners are cast aluminum and come standard with a 2" paper filter element. Washable cotton gauze elements in 2" or 4" height are also available. The air cleaners have a 5 1/8" opening to fit standard four barrel carburetors.

- MS215-22 Oval Air Cleaner
- MS215-23 2" Paper Element
- MS215-24 2" Washable Element
- MS215-25 4" Washable Element



MS215-93P



MS215-93HL

Large Oval Billet Aluminum Air Cleaners 17 1/2" X 10" ⚠️

These are fully CNC machined and come with a 3" tall American made washable cotton gauze element. They are available for standard (5 1/8" opening) or dominator (7 1/4" opening) carburetors.

- MS215-93 Oval Air Cleaner For Standard Carb
- MS215-98 Oval Air Cleaner For Dominator Carb



Custom Laser Engraving

Call for details. ⚠️

MS215-102 Custom Laser Engraving Charge

*Specify color when ordering: **P**=Bright Polished **M**=Raw Machined **BA**=Gloss Black Anodized **BK**=Gloss Black **CA**=Clear Anodized **CL**=Protective Clear Coat **MB**=Matte Black **B**=Blue **R**=Red **W**=White

Billet Aluminum Air Cleaner Nuts ⚠️

Precision CNC machined from billet aluminum. With ¼-20 threads, the nut is 1 3/8" in diameter. Available in raw machined or bright polished finish and in a variety of Fusioncoat and anodized finishes (specify when ordering).



MS215-50M Machined

MS215-50P Polished

MS215-50XX Color

Billet Aluminum Throttle Cable Brackets

For Universal 33C Cables ⚠️

These brackets mount to the base of the carburetor. Order cable clamp separately. Available in a variety of finishes. Specify when ordering.

- MS142-05 Standard Holley 4150 & 4160 series carburetors
- MS142-05D Holley Dominator 4500 series carburetors
- MS142-36174 Stainless steel quick release clamp



MS142-05



MS142-05D

For GM Throttle Cables ⚠️

These brackets mount to the base of the carburetor. The kits include the cable mount bracket, return springs and bracket, and installation hardware. Available in blue, black, clear, and red anodize. Specify color when ordering.

- MS142-08 Standard Holley 4150 & 4160 series carburetors
- MS142-09 Holley Dominator 4500 series carburetors



*Specify color when ordering: **P**=Bright Polished **M**=Raw Machined **BA**=Gloss Black Anodized
BK=Gloss Black **CA**=Clear Anodized **CL**=Protective Clear Coat **MB**=Matte Black **B**=Blue **R**=Red **W**=White



Billet Aluminum Fuel Vent ⚠️

Eddie Motorsport's billet aluminum fuel vent is a perfect solution for adapting a late model, non-vented gas cap to your muscle car as required in fuel injected applications (installation requires the gas tank to have a vent outlet). Running a non-vented gas cap also prevents fuel from spilling out of your original cap under hard acceleration. The vent, which can work as a differential breather as well, may reduce or eliminate gas odors that are often the norm with traditionally vented gas caps on muscle cars. Precision CNC machined from 6061-T6 billet aluminum, the vent is 2 1/2" wide and 4" tall. The vent is installed above the car's gas tank, usually in the trunk, and allows your gas tank's vapors to travel up into the vent and dissipate through the 30 micron filter element included in the vent kit. The vent can be mounted through the base or against a surface. Connection to the vent is done through the two 3/8" NPT threaded ports on the bottom. The vent kit includes the billet aluminum vent, two 3/8" NPT bulkhead fittings, 90 degree surface mount bracket and a filter. Connecting hose and fittings are not included. The vent is available in a bright polished or raw machined finish or in a variety of Fusioncoat or anodized colors. Specify finish when ordering.



MS265-60M	Machined
MS265-60P	Polished
MS265-60XX	Specify Color

Billet Aluminum High Volume Fuel Filter ⚠️

These high volume fuel filter heads are precision CNC machined from 6061-T6 aluminum. The heads accept water separating fuel filters with 1"-14 threads and can be purchased with or without a WIX filter. Equipped with four 1/2" NPT inlets/outlets for added plumbing flexibility, the filter heads incorporate two 5/16" mounting holes. The filters offer 14 micron filtration and are rated at 100 GPH making them ideal for high performance use. They are 7" tall and have a drain plug at the bottom. The filter heads are available with a bright polished finish or in a variety of anodized and Fusioncoat finishes.



MS260-08KP	Filter Kit Polished
MS260-08KXX	Filter Kit Specify Finish
MS260-08P	Filter Head Only Polished
MS260-08XX	Filter Head Only Specify Finish
MS260-09	Fuel Separating Filter Only



Billet Aluminum Gas Tank Vents ⚠️

Manufactured from billet aluminum, these vents have an internal baffling screen and a straight 5/8" inlet.

MS238-02P	Polished
MS238-02XX	Specify Color

Stainless Steel Flush Mount Fuel Vents ⚠️

The latest look in fuel vents, these stainless steel units mount flush. Inlet tubes are 90° and accept 5/8" hose. Can be used with or without the shield.

MS238-03P	Polished
MS238-03XX	Specify Color



LS Chevy Coil Covers



Billet Aluminum LS Chevy Coil covers ⚠️

A high quality, custom alternative to covering the coils on your Chevy LS-3 engine. Machined from 1/4" billet aluminum, these covers come with stanchions that bolt to your stock GM valve covers. Available in two styles, smooth and ball milled, with or without a cutout for the stock rubber oil fill tube. They are also available in a short version (driver side-1 1/2", passenger side -2") for tight LS conversions like Tri Fives. Available in a variety of finishes, specify when ordering. Made in the USA.



Smooth

MS109-01 Standard
MS109-05 Short

Smooth w/oil fill cut-out

MS109-02 Standard
MS109-06 Short

Ball Milled

MS109-03 Standard
MS109-03HL Standard

MS109-07 Short
MS109-07HL Highlight

Ball Milled w/oil fill cut-out

MS109-04 Standard
MS109-04HL Standard

MS109-08 Short
MS109-08HL Short Highlight

LS Chevy Coil Relocation Mounts



For the enthusiast who's willing to go the extra distance, these mounts give you an easy installation alternative for cleaning up the look of your engine by relocating your LS coils, Eddie Motorsports manufactures kits to accommodate LS-2,3,7 and 9 coils, LS-1 coils, and Mercury Marine/FAST/AEM /Holley IGN-1A coils. The brackets are sold in a kit with four mounts to accommodate all 8 coils. For a simpler mounting solution, we also offer the coil mounts in kits with auxiliary mounting brackets that allow you to easily group and mount the coils in several configurations. Precision CNC machined from billet aluminum, the coil mounts and brackets are available in a bright polished or raw machined finish as well as a variety of Fusioncoat and anodized colors. Specify finish when ordering. Made in the USA.

Coil Relocation Mount Kit ⚠️

MS109-10 LS-2,3,7,9 coils
MS109-12 LS IGN-1A Merc/FAST/AEM/Holley coils
MS109-14 LS-1 coils

Coil Relocation Mount Kit with Auxiliary Mounting Brackets ⚠️

MS109-11 LS-2,3,7,9 coils
MS109-13 LS IGN-1A Merc/FAST/AEM/Holley coils
MS109-15 LS-1 coils



LS Full Coil Covers

Dress-up your LS engine **AND** hide the stock coils with a set of these fabricated aluminum coil covers. Designed to look similar to a Big Block Chevy Valve Cover, the covers mount to the factory coil brackets and come complete with a billet aluminum oil filter extension, screw-in cap and all of the necessary fasteners. Coil covers are 3 5/8" tall x 19 5/8" long, will fit 4.8L, 5.3L, 6.0L and 6.2L LS engines and are available in four custom finishes. NOTE: Trimming of the covers may be necessary in some applications with tight firewall clearance or OEM high mount alternator brackets.



LS Full Coil Covers ⚠️

- | | |
|------------|--------------------------------|
| MS109-35P | Bright Polished Finish |
| MS109-35MB | Matte Black Fusioncoat Finish |
| MS109-35BK | Gloss Black Fusioncoat Finish |
| MS109-35CA | Clear Anodized Finish |
| MS109-35CL | Bright Clear Fusioncoat Finish |

2-Piece LS Valve Cover w/Coil Covers

The coil cover features cut-outs for routing the wiring harness and spark plug wires and comes with a classic, finned top. Each 2-Piece LS valve cover set includes a low-profile billet oil fill cap, hardware and spacers for mounting both versions of LS coil bodies, and 12-point dress up hardware and rubber grommets for the coil covers.



2-Piece LS Valve Cover w/Coil Covers ⚠️

- | | |
|------------|-------------------------------|
| MS108-77P | Bright Polished Finish |
| MS108-77MB | Matte Black Fusioncoat Finish |
| MS108-77BK | Gloss Black Fusioncoat Finish |





Cast Aluminum LS Valve Covers ⚠️

Our newest LS Cover, these cast aluminum pieces offer a custom look at an affordable price. The "taller than stock" covers are 1 3/4 tall. The covers come complete with our contoured style billet aluminum oil fill cap in one cover and stainless steel fasteners. They are available in two styles and a variety of finishes. Requires relocating the coil packs.

Smooth

MS108-50 Specify Finish

Ball Milled

MS108-51 Specify Finish
MS108-51HL Highlight Finish

Billet Aluminum LS Valve Covers ⚠️

Our one-piece full billet aluminum valve covers for LS Chevys. Precision CNC-machined in the USA from a single piece of premium 6061-T6 aluminum. The "taller than stock" covers are 1 3/4 tall and they come complete with our contoured style billet aluminum oil fill cap in one cover and stainless steel fasteners. The covers are available in two styles, with or without coil mount bosses for LS3 coils. Available in seven custom finishes, specify when ordering.

MS108-73XX Without Coil Mounts

MS108-74XX With Coil Mounts



MS108-49MB

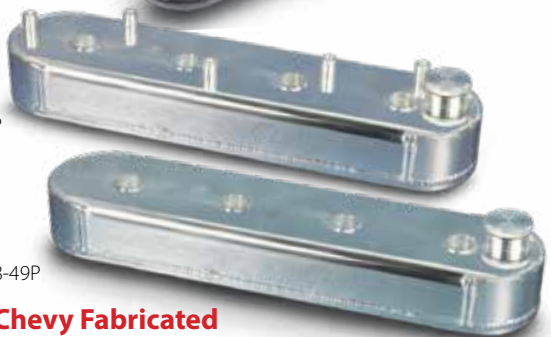

MS108-48P

MS108-49P

Billet Aluminum LS Valve Covers ⚠️

One-piece full billet aluminum valve covers for LS Chevys. Precision CNC machined in the USA from a single piece of premium 6061-T6 aluminum. The "taller than stock" covers are 1 3/4 tall. The covers come complete with our contoured style billet aluminum oil fill cap in one cover and stainless steel fasteners. They are available in two styles and a variety of finishes. Requires relocating the coil packs.

Smooth

MS108-70 Specify Finish

Ball Milled

MS108-71 Specify Finish
MS108-71HL Highlight Finish

LS Chevy Fabricated Aluminum Valve Covers ⚠️

These covers include an oil fill hole and screw-in cap in one cover, stainless steel bolts, and gaskets. Available with or without coil mount bosses.

MS108-48 With Coil Mounts Specify Finish

MS108-49 Without Coil Mounts Specify Finish

Big Block Chevy Valve Covers



Tall Diamond Series ⚠️

Cast aluminum with our unique cross-hatch machining. Will clear most roller rockers and stud girdles and includes SS fasteners. The covers have one Breather /PCV hole on each side and include an oil baffle, fasteners, and grommets. Specify finish when ordering (Highlight finish pictured).

MS108-32 Big Block Chevy

Cast Aluminum ⚠️

Covers have a breather hole on each side and include oil baffle, fasteners, breather and PCV grommets. Short or tall configurations.

- MS108-30 Short Smooth Top
- MS108-31 Tall Smooth Top
- MS108-33 Short Ball Milled Top
- MS108-34 Tall Ball Milled Top
- MS108-33HL Short Ball Milled Top Highlight Finish
- MS108-34HL Tall Ball Milled Top Highlight Finish

Angle Cut ⚠️

Cast aluminum with one oil fill hole and screw-in cap. Will clear most roller rockers and stud girdles. Includes SS fasteners.

- MS108-02 Smooth
- MS108-10 Ball Milled
- MS108-10HL Ball Milled Highlight Finish



Custom Laser Engraving ⚠️

Eddie Motorsports offers custom laser engraving on most of our valve covers with Fusioncoated finish from your artwork. Call for details.

MS108-102 Engraving Charge

Fabricated Aluminum ⚠️

Available with recessed base mount or top entry fastener location. Top entry cover has one breather hole, base entry has two. Covers come complete with oil baffle, fasteners, breather and PCV grommets.

- MS108-35 Top bolt
- MS108-36 Base mount



Small Block Ford Valve Covers



Small Block Ford Valve Covers ⚠️

Cast Aluminum Covers have a breather hole on each side and include oil baffle, fasteners, breather and PCV grommets.

- MS108-60 Tall smooth top
- MS108-61 Tall ball milled top

Fabricated Aluminum ⚠️

Covers have no breather hole and include fasteners.

- MS108-65M Plain aluminum
- MS108-65P Polished
- MS108-65 XX Color

Small Block Ford Highlight Valve Covers ⚠️

- MS108-61HL Tall ball milled top Highlight Finish

*Specify finish when ordering **M**= Machined • **P** = Polished • **XX** = Color • **HL** = Highlight





Billet Aluminum Valve Covers

At Eddie Motorsports, we know that most custom car owners demand the highest quality products, regardless of price. In response to this, we now manufacture a line of Chevrolet one-piece full billet aluminum valve covers. Precision CNC machined in the USA from a single piece of premium 6061-T6 aluminum. Available in a variety of finishes.



Small Block Chevy ⚠️

- | | |
|-------------|----------------------------------|
| MS108-75M | Smooth Top Machined |
| MS108-75P | Smooth Top Polished |
| MS108-75 XX | Smooth Top Specify Color |
| MS108-76M | Ball Milled Top Machined |
| MS108-76P | Ball Milled Top Polished |
| MS108-76 XX | Ball Milled Top Specify Color |
| MS108-76HL | Ball Milled Top Highlight Finish |

Small Block Chevy Valve Covers



Cast Aluminum ⚠️

Covers have a breather hole on each side and include oil baffle, fasteners, breather and PCV grommets.

- | | |
|------------|--|
| MS108-15 | Short Smooth Top |
| MS108-17 | Tall Smooth Top |
| MS108-20 | Short Ball Milled Top |
| MS108-24 | Tall Ball Milled Top |
| MS108-20HL | Short Ball Milled Top Highlight Finish |
| MS108-24HL | Tall Ball Milled Top Highlight Finish |



Finned Cast Aluminum ⚠️

Covers have a breather hole on each side and include oil baffle, fasteners, breather and PCV grommets.

- | | |
|----------|-------|
| MS108-28 | Short |
| MS108-29 | Tall |



Fabricated Aluminum ⚠️

Covers have a breather hole on each side and include oil baffle, fasteners, breather and PCV grommets.

- | | |
|-------------|----------------|
| MS108-45M | Clear Anodized |
| MS108-45P | Polished |
| MS108-45 XX | Specify Color |

Center Bolt (1986 and Newer)

Fabricated Aluminum Covers do not have breather holes. Fasteners are included.



Fabricated Aluminum ⚠️
MS108-44 Specify Finish



Cast Aluminum ⚠️

- | | |
|----------|-----------------------|
| MS108-40 | Short Smooth Top |
| MS108-41 | Tall Smooth Top |
| MS108-42 | Short Ball Milled Top |
| MS108-43 | Tall Ball Milled Top |



Cast Aluminum Highlight Finish ⚠️

- | | |
|------------|-----------------------|
| MS108-42HL | Short Ball Milled Top |
| MS108-43HL | Tall Ball Milled Top |



Cast Aluminum Bolt On Breathers ⚠️

They are 5" tall and feature a removable top cap for easy oil filling. Installation requires drilling or milling holes in your covers for the breather opening and 1/4" fasteners (not included). Available in a variety of finishes. Specify when ordering. Sold individually. Gaskets included.

MS108-07P Polished MS108-07M Raw Finish
MS108-07 XX Color



Billet Aluminum Bolt On Breathers ⚠️

These breathers/PCV valves are precision CNC-machined from billet aluminum and are 3 3/8" tall. Models are available for use as a breather or with an integral PCV valve and 3/8" hose connection. The breathers feature a removable top cap for easy oil filling. The mounting area is 3 1/2" long and 1 3/4" wide. Installation requires 1/4" fasteners (not included) and drilling or milling holes in your covers for the breather opening. Available in seven custom finishes, specify when ordering. Sold individually. Gaskets included.

MS108-08XX Breather MS108-09XX w/PCV Valve



Aluminum Push In Breather ⚠️

Machined from a solid piece of billet aluminum, don't confuse our breathers with die cast imported pieces.

MS108-80P	Smooth Top	MS108-82P	Smooth Top w/PCV valve
MS108-81P	Ball Milled Top	MS108-83P	Ball Milled Top w/PCV valve
MS108-81HL	Ball Milled Highlight Top	MS108-83HL	Ball Milled Highlight Top w/PCV valve



Screw in Oil Fill Bung and Cap ⚠️

Our new contoured style billet aluminum cap and bung. Can be welded or bolted on valve covers or fluid tanks. The mounting base is 2 1/4" diameter.

MS108-25M Machined
MS108-25P Polished
MS108-25XX Specify Color
MS108-96 Replacement Cap Only



Aluminum Diamond Series Push In Breather ⚠️

MS108-87P	Polished
MS108-88P	Polished w/PCV Valve
MS108-87HL	Black Highlight
MS108-88HL	Black Highlight w/PCV Valve



Valve Cover Hold Downs ⚠️

These hold downs are machined from billet aluminum and include 1/4-20 stainless steel studs. They are 2 3/4" tall.

MS108-11 Hold down-each
MS108-12 Hold down-four pack

Valve Cover Grommets ⚠️

MS108-13	1"ID for Breathers
MS108-14	3/4"ID for PCV Valves



Aluminum PCV valve ⚠️

MS108-84



Billet Aluminum Accent Washers

Our dimpled accent washers are a popular dress up addition to fender and core support bolts. With models that are recessed to accept a button head bolt and AN washer or countersunk to accept a flat head fastener. All of our billet washers are available in raw machined or brightly polished finish or in a variety of Fusioncoat and anodized colors. Specify when ordering. Bolts not included.

Button Head Washers

- MS281-50 #10 X 3/4" OD
- MS281-51 1/4" X 7/8" OD
- MS281-52 5/16" X 1" OD
- MS281-53 3/8" X 1 1/8" OD

Countersunk Washers

- MS281-75 #10 X 3/4" OD
- MS281-76 1/4" X 7/8" OD
- MS281-77 5/16" X 1" OD
- MS281-78 3/8" X 1 1/8" OD



Billet Aluminum Plain Accent Washers

Machined to the same dimensions as our dimpled accent washers but with a smooth finish and more economical price. Available in machined or brightly polished finish or in a variety of Fusioncoat and anodized colors. Specify when ordering. Bolts not included.

Button head washers

- MS281-54 #10 X 3/4" OD
- MS281-55 1/4" X 7/8" OD
- MS281-56 5/16" X 1" OD
- MS281-57 3/8" X 1 1/8" OD

Countersunk Washers

- MS281-85 #10 X 3/4" OD
- MS281-86 1/4" X 7/8" OD
- MS281-87 5/16" X 1" OD
- MS281-88 3/8" X 1 1/8" OD



Billet Aluminum Accent Washers Highlight Finish

We black anodize these washers first and then machine them to accent the dimples.

Button head washers

- MS281-50HL #10 X 3/4" OD
- MS281-51HL 1/4" X 7/8" OD
- MS281-52HL 5/16" X 1" OD
- MS281-53HL 3/8" X 1 1/8" OD

Countersunk Washers

- MS281-75HL #10 X 3/4" OD
- MS281-76HL 1/4" X 7/8" OD
- MS281-77HL 5/16" X 1" OD
- MS281-78HL 3/8" X 1 1/8" OD



Billet Aluminum Slimline Washers

Machined with a smaller outside diameter for those tight places that need attention. Countersunk to accept a flathead fastener. Available in machined or brightly polished finish, black or clear anodized. Specify when ordering. Bolts not included.

- MS281-70P #10 X 1/2" OD
- MS281-71P 1/4" X 3/4" OD
- MS281-72P 5/16" X 7/8" OD
- MS281-73P 3/8" X 1" OD



*Specify color when ordering: **P**=Bright Polished **M**=Raw Machined **BA**=Gloss Black Anodized **PR**=Purple

BK=Gloss Black **CA**=Clear Anodized **CL**=Protective Clear Coat **MB**=Matte Black **B**=Blue **R**=Red **W**=White **CK**=Cerakote **HL**=Highlight



Billet Aluminum Lightning Washers ⚠️

Our machined Lightning washers are the newest addition to our popular line of billet aluminum dress-up washers. Most commonly used for fender and core support bolts, the washers are recessed to accept a socket head cap screw (sold separately). All of our custom billet washers are available in a bright polished or raw machined finish or in a variety of Fusioncoat or anodized colors. Priced per piece. Bolts not included.

MS281-60	#10 X 5/8" OD
MS281-61	1/4" X 3/4" OD
MS281-62	5/16" X 1" OD
MS281-63	3/8" X 1 1/8" OD



Billet Aluminum Lightning Washers Highlight Finish ⚠️

We black anodize these washers first and then machine them to highlight the accents. Priced per piece. Bolts not included.

MS281-60HL	#10 X 5/8" OD
MS281-61HL	1/4" X 3/4" OD
MS281-62HL	5/16" X 1" OD
MS281-63HL	3/8" X 1 1/8" OD



Billet Aluminum Plain Socket Cap Washers ⚠️

Machined to the same dimensions as our Lightning washers but with a smooth finish. Available in a bright polished or raw machined finish or in a variety of Fusioncoat or anodized colors. Priced per piece. Bolts not included.

MS281-65	#10 X 5/8" OD
MS281-66	1/4" X 3/4" OD
MS281-67	5/16" X 1" OD
MS281-68	3/8" X 1 1/8" OD



Counter Sunk Washers ⚠️

Machined from billet aluminum to accept a flat or tapered head fastener. Bolts not included.

MS281-13CS	1/4" X 1 1/4"
MS281-14CS	5/16" X 1 1/4"
MS281-15CS	3/8" X 1 1/4"



Billet Aluminum Fender/Stringer Washers ⚠️

Our most popular universal washer. Washers are 1/4" thick with a 1 1/4" outside diameter. Available in a variety of finishes.

MS281-13	1/4" X 1 1/4" OD
MS281-14	5/16" X 1 1/4" OD
MS281-15	3/8" X 1 1/4" OD
MS281-19	7/16" X 1 1/4" OD
MS281-18	1/2" X 1 1/4" OD

Billet Aluminum Upholstery Washers ⚠️

Perfect for fastening seat or door panels. Washers are 1/8" thick with a 1" outside diameter. Available in a variety of finishes.

MS281-16	#10 X 1" OD
MS281-21	1/4" X 1" OD

*Specify color when ordering: **P**=Bright Polished **M**=Raw Machined **BA**=Gloss Black Anodized **PR**=Purple **BK**=Gloss Black **CA**=Clear Anodized **CL**=Protective Clear Coat **MB**=Matte Black **B**=Blue **R**=Red **W**=White **CK**=Cerakote **HL**=Highlight



Sequential LED Taillights

Controlled by an integrated selector switch, these taillights give you the option of having the taillights sequentially flash from inside out, outside in or simultaneous. The lights also include a Brake Attention mode which, when engaged, rapidly flashes the stop light for an instance to gain the attention of motorists following your vehicle. Sold individually.



1973-83 Chevy Truck ⚠️
MS300-90RS Right
MS300-90LS Left



1967-72 Chevy Truck ⚠️
MS300-40S Taillight



1969 Camaro (Non-RS) ⚠️
MS300-10LS Left
MS300-10RS Right



1966-67 Nova ⚠️
MS300-36S Taillight (One piece/no back up light)



1954-59 Chevy & GMC Truck ⚠️
MS300-48S Taillight



1969 Taillight



1965-66 Taillight



1967-68 Taillight

1965-69 Mustang ⚠️
MS300-60S 1965-66
MS300-67S 1967-68
MS300-69S 1969



1953-56 Ford Truck ⚠️
MS300-42LS Left
MS300-42RS Right



1960-66 Chevy & GMC Fleetside Truck ⚠️
MS300-47S Taillight



1940-53 Chevy Truck ⚠️
MS300-46LS Left w/ license plate light
MS300-46RS Right

LED Lights

OEMs realized the advantages of Light Emitting Diode (LED) technology years ago and it is now available for your classic car in the form of LED lights. These lights are direct replacement units and offer simple plug-in installation with no drilling, cutting or splicing of wires. The LEDs are waterproof and virtually unaffected by shock and vibration. They are rated for 100,000 hours of operation and come with a limited lifetime warranty. All of the lights are sold individually and require the use of an LED flasher (sold separately).



1940-53 Chevy Truck ⚠️

- MS300-46LS Taillight with licence plate light and sequential operation
- MS300-46RS Taillight sequential operation



1967-72 C-10 Chevy Truck ⚠️

- MS300-30A Parking light 67-68 Amber
- MS300-30C Parking light 67-68 Clear
- MS300-21L Parking light 69-70 Amber Left
- MS300-21R Parking light 69-70 Amber Right
- MS300-13A Parking light 71-72 Amber
- MS300-13C Parking light 71-72 Clear
- MS300-41A Front Marker light 68-72 Amber
- MS300-41R Rear Marker light 68-72 Red
- MS300-40 Taillight
- MS300-40S Taillight with Sequential Operation
- MS300-44R Back-Up light 67-72 Right
- MS300-44L Back-Up light 67-72 Left
- MS300-43 Cargo / Brake light



1967-73 Camaro ⚠️

- MS300-05 Taillight 1967
- MS300-20 Taillight 1967 RS
- MS300-06 Back-up light 1967
- MS300-16 Taillight 1968
- MS300-17 Taillight 1968 RS
- MS300-18 Back-up light 1968
- MS300-10L Taillight 1969 Left
- MS300-10R Taillight 1969 Right
- MS300-10LS 1969 Left Taillight with Sequential Operation
- MS300-10RS 1969 Right Taillight with Sequential Operation
- MS300-29 Back-up light 1969 RS
- MS300-23L Taillight 1970-73 Left
- MS300-23R Taillight 1970-73 Right



1955 Chevy Car ⚠️

- MS300-50 Taillight
- MS300-51 Back Up Light
- MS300-52A Turn Signal Amber
- MS300-52C Turn Signal Clear

1956 Chevy Car ⚠️

- MS300-55 Taillight
- MS300-56 Back Up Light
- MS300-57A Turn Signal Amber
- MS300-57C Turn Signal Clear

1957 Chevy Car ⚠️

- MS300-53 Back Up Light
- MS300-58 Taillight
- MS300-59A Parking Light-Amber
- MS300-59C Parking Light-Clear

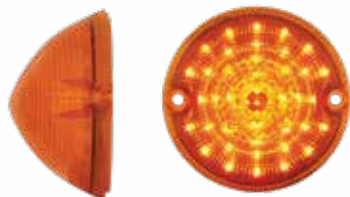

1955-57 Chevy Truck ⚠️

- MS300-28A Parking Light Amber
- MS300-28C Parking Light Clear

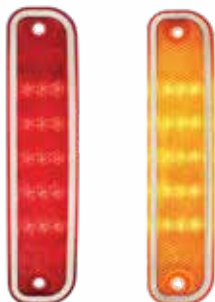

1973-80 Chevy Truck ⚠️

- MS300-91A Front Marker light Amber
- MS300-91R Front Marker light Red
- MS300-90RS Taillight with Sequential Operation
- MS300-90LS Taillight with Sequential Operation



1962-69 Nova ⚠️

- MS300-70 Taillight 1962-64
- MS300-71 Backup Light 1962-64
- MS300-25 Taillight 1966-67
- MS300-26 Back-Up Light 1966-67
- MS300-36 Taillight 1966-67 (One piece all red, no backup light)
- MS300-36S Taillight 1966-67 with sequential operation (One piece all red, no backup light)
- MS300-27 Taillight 1968-69 (All red, no backup light)



1964-72 Chevelle ⚠

- MS300-72 Taillight 1964 Left
- MS300-73 Taillight 1964 Right
- MS300-12L Taillight 1965 Left
- MS300-12R Taillight 1965 Right
- MS300-74 Taillight 1967 Red
- MS300-76 Taillight 1968 Red Right
- MS300-77 Taillight 1968 Red Left
- MS300-35L Taillight Board Only 1970 Left
- MS300-35R Taillight Board Only 1970 Right
- MS300-78L Taillight 1971 SS & Malibu Left
- MS300-78R Taillight 1971 SS & Malibu Right
- MS300-79L Taillight 1972 SS & Malibu Left
- MS300-79R Taillight 1972 SS & Malibu Right



1968-72 El Camino/Wagon ⚠

- MS300-34L Taillight 1968-69 Left
- MS300-34R Taillight 1968-69 Right
- MS300-19L Taillight 1970-72 Left
- MS300-19R Taillight 1970-72 Right



1965-69 Mustang ⚠

- MS300-60 Taillight 1965-66
- MS300-60S Taillight 1965-66
- MS300-61 Turn Signal 1965-66 Amber
- MS300-67 Taillight 1967-68
- MS300-67S Taillight 1967-68
- MS300-69 Taillight 1969
- MS300-69S Taillight 1969



LED Flashers ⚠

For proper function, all LED lights require the use of an LED flasher. (sold separately)

- MS300-80 two post (most common)
- MS300-81 three post



1968 Dodge Charger ⚠

- MS300-15 Taillight

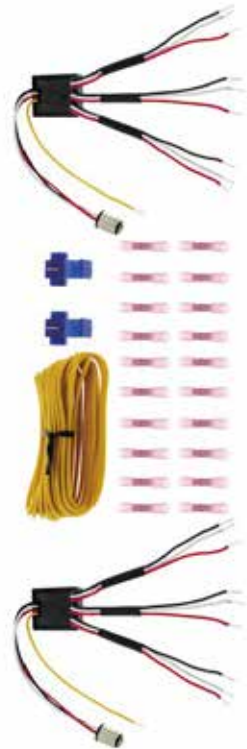

Sequential Light Kit ⚠

This recently re-designed add-on module converts any two or three LED taillight assembly to sequential illumination. The kit also provides a brake attention mode which, when engaged, rapidly flashes the stop light for an instance. **This kit only works on lights equipped with LEDs!**

- MS300-11 Sequential Taillight Kit



Eddie Motorsports Shenanigan Tees ⚠️

SEMA Shenanigan Mustang tee. A must for any Mustang fan. *Specify size when ordering.

- MS101-04 Eddie Motorsports Shenanigan Mens T-shirt
- MS101-14 Eddie Motorsports Shenanigan Womens T-shirt



Eddie Motorsports Chevelle Tees ⚠️

It's Chevelle time with this EM Chevelle tee. *Specify size when ordering.

- MS101-07 Eddie Motorsports Chevelle Mens T-shirt
- MS101-17 Eddie Motorsports Chevelle Womens T-shirt



Eddie Motorsports 3 Camaros Tees ⚠️

This Camaro shirt honors three generations of the most iconic Camaros of all time. *Specify size when ordering.

- MS101-02 Eddie Motorsports Long Shot Mens T-shirt
- MS101-12 Eddie Motorsports Long Shot Womens T-shirt



Eddie Motorsports 3 Belairs Tees ⚠️

This Tri-Five tee is perfect for any Belair fan. *Specify size when ordering.

- MS101-06 Eddie Motorsports 3 Belairs Mens T-shirt
- MS101-16 Eddie Motorsports 3 Belairs Womens T-shirt



Eddie Motorsports Long Shot Tees ⚠️

Represent with our C-10 Long Shot truck graphic. *Specify size when ordering.

- MS101-02 Eddie Motorsports Long Shot Mens T-shirt
- MS101-12 Eddie Motorsports Long Shot Womens T-shirt



Eddie Motorsports 3 Chevy Trucks Tees ⚠️

Three generations of C-10 trucks graphic. *Specify size when ordering.

- MS101-03 Eddie Motorsports 3 Chevy Trucks Mens T-shirt
- MS101-13 Eddie Motorsports 3 Chevy Trucks Womens T-shirt

*Specify shirt size when ordering: **M**=Medium **L**=Large **XL**=X-Large **2X**=XX-Large **3X**=XXX-Large



Garage Wall Art ⚠️

Put your favorite hot rod on the wall of your garage or office with our laser-cut metal signs. Manufactured from 16-gauge stainless steel, the signs are approximately 22" long and can be easily hung with your preferred method. Available in Satin, Polished or a variety of Fusioncoated colors. Specify when ordering.



57 Chevy -Polished finish



55-56 Chevy

MS282-01XX Specify Finish



66-67 Nova

MS282-11XX Specify Finish



69 Camaro

MS282-07XX Specify Finish



57 Chevy

MS282-03XX Specify Finish



67-68 Camaro

MS282-05XX Specify Finish



70 Chevelle

MS282-13XX Specify Finish

Eddie Motorsports Hats ⚠️

OK Eddie Motorsports fans, we've got your style with these high quality snapback hats. Which features a custom stainless steel logo emblem. One size fits most.



Snapback-Solid

MS101-80BK Black

Snapback-Trucker

MS101-70BK Black

Eddie Motorsports License Plate Frames ⚠️

Machined from a solid piece of billet aluminum. With our license plate frames you can add some custom etching for that finishing touch to your ride. Available in a variety of finishes and colors..

MS600-70XX



Custom Etching



Eddie Motorsports is a leading automotive company specializing in the design, manufacturing, and distribution of high-quality aftermarket automotive components and accessories. Established in 2009, the company has grown to become a trusted name in the automotive industry, known for its innovative products and exceptional customer service.

With a passion for cars and a dedication to craftsmanship, Eddie Motorsports is committed to delivering top-notch performance and style upgrades for a wide range of vehicles. The company offers a diverse product lineup that includes precision-engineered billet aluminum parts, engine dress-up kits, steering components, seating options, interior components, and more.

Driven by a team of experienced engineers, designers, and enthusiasts, Eddie Motorsports combines cutting-edge technology with meticulous attention to detail to create products that not only enhance the performance of vehicles but also elevate their aesthetic appeal. Each component is carefully crafted to meet the highest standards of quality and durability, ensuring that customers receive products that are built to last.

In addition to its commitment to superior craftsmanship, Eddie Motorsports places a strong emphasis on customer satisfaction. The company strives to provide an exceptional buying experience, offering personalized support and technical assistance to help customers find the perfect solutions for their automotive needs. Whether it's a classic car restoration project or a modern vehicle upgrade, Eddie Motorsports is dedicated to helping enthusiasts bring their automotive visions to life.

Furthermore, Eddie Motorsports actively engages with the automotive community through participation in industry events, collaborations with other leading brands, and sponsorship of car shows and races. By staying connected to the enthusiast community, the company continuously seeks inspiration and feedback to further improve its products and develop innovative solutions.

With a reputation for excellence, Eddie Motorsports has earned the trust and loyalty of customers around the world. From passionate car enthusiasts to professional builders and racers, the company's products have been installed in countless vehicles, making a lasting impact on the automotive landscape.

Overall, Eddie Motorsports is driven by its mission to provide exceptional automotive components and accessories that blend performance, style, and reliability. Through its unwavering commitment to quality, innovation, and customer satisfaction, the company continues to lead the way in the aftermarket automotive industry, helping car enthusiasts take their vehicles to the next level.





***11479 Sixth Street
Rancho Cucamonga, CA 91730
www.eddiemotorsports.com
Tel. 1-888-813-1293***



